



HT10, QG200, 2010

HT20, QG200, 2020, 2061 & KM20 (use 2020)

HT30, QG300, 2030, 2065 & PS3000 (use 2030)

SPECIFICATIONS:

Application:

- HT10, QG200, 2010 - Lt FW
- HT20, QG200, 2020 - M FW
- HT30, QG300, 2030 - Hvy FW

Gear Ratio:

- HT10, QG100, 2010 - 3.9:1
- HT20, QG200, 2020 - 3.6:1
- HT30, QG300, 2030 - 3.6:1

Line Capacity:

- HT10, QG100, 2010 - 90 yds / 6 lb
- HT20, QG200, 2020 - 90 yds / 8 lb
- HT30, QG300, 2030 - 80 yds / 14 l

Weight

- HT10, QG100, 2010 - 5.8 oz
- HT20, QG200, 2020 - 8.3 oz
- HT30, QG300, 2030 - 9.4 oz

FEATURES:

- Wide Range Star Drag
- Helical Gears
- Silent Automatic Anti-Reverse
- Ball Bearing Drive (HT and QG reels)

Color:

- HT reels - Cranberry
- QG reels - Black
- Prostaff reels - Dark Grey

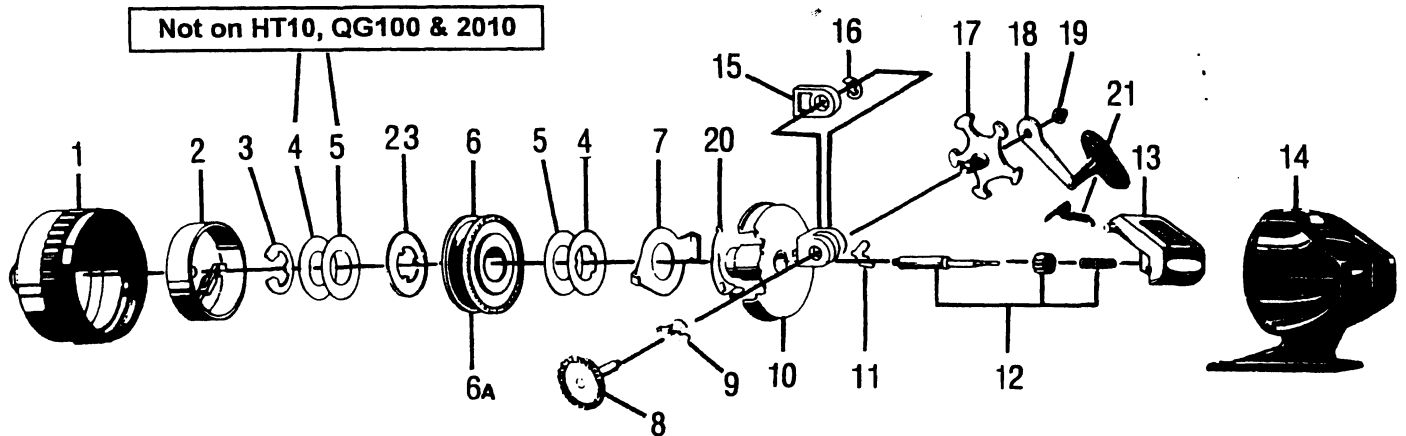

| Key No. | Description | Price | Part No. | | | | | | | | | |
|---------|----------------------|-------|----------|----------|----------|----------|----------|----------------------|----------|----------|------------------------|--|
| | | | HT10 | QG100 | 2010 | HT20 | QG200 | 2020 2061 KM20 | HT30 | QG300 | 2030 2065 PS3000 | |
| 1 | Front Cover | 6.66 | QY324-07 | QY324-06 | QY324-05 | JY324-20 | JY324-13 | JY324-12 | KY324-08 | KY324-06 | KY324-05 | |
| 2 | Spinnerhead Asy. | 5.27 | QT310-01 | ← | ← | JY310-01 | ← | ← | KY310-01 | ← | ← | |
| 3 | Spool Retainer Clip | .60 | XZ034-01 | ← | ← | JY034-01 | ← | ← | GZ034-01 | ← | ← | |
| 4 | Spool Washer (metal) | 1.01 | BJ040-01 | ← | ← | JY040-01 | ← | ← | CJ040-01 | ← | ← | |
| 5 | Flat Washer | .40 | BJ108-01 | ← | ← | JY108-01 | ← | ← | CJ108-01 | ← | ← | |
| 6 | Spool w/ line | 6.64 | QY321-01 | ← | ← | JY321-01 | ← | ← | KY321-01 | ← | ← | |
| 6A | Spool (empty) | 2.27 | QY021-01 | ← | ← | JY021-01 | ← | ← | KY021-01 | ← | ← | |
| 7 | Clutch Ring | .94 | QY027-01 | ← | ← | NY027-01 | ← | ← | KY027-01 | ← | ← | |
| 8 | Crank Shaft Asy. | 3.33 | QY308-01 | ← | ← | JY308-01 | ← | ← | KY308-04 | | KY308-04 | |
| 9 | Pawl Actuator | .46 | JY061-01 | ← | ← | ← | ← | ← | ← | ← | ← | |
| 10 | Body Asy. | 8.79 | QY301-01 | ← | ← | JY301-01 | ← | ← | KY301-01 | ← | ← | |
| 11 | Anti-Reverse Pawl | .46 | JY060-01 | ← | ← | ← | ← | ← | ← | ← | ← | |
| 12 | Center Shaft Asy. | 4.03 | QY315-01 | ← | ← | JY315-02 | ← | JY315-01 | KY315-02 | ← | KY315-01 | |
| 13 | Thumb Stop | 1.06 | QY009-02 | TY009-01 | ← | JY009-02 | KY009-01 | ← | JY009-02 | KY009-01 | ← | |
| 14 | Back Cover Asy. | 2.25 | QY323-07 | QY323-06 | QY323-05 | JY323-09 | JY323-06 | JY323-06 | KY323-08 | KY323-07 | KY323-06 | |
| 15 | Slide Drag Actuator | 1.35 | JY054-01 | ← | ← | ← | ← | ← | KY054-01 | ← | ← | |
| 16 | Retainer Clip | .40 | JY121-01 | ← | ← | ← | ← | ← | ← | ← | ← | |
| 17 | Drag Star | .46 | JY032-01 | ← | ← | ← | ← | ← | ← | ← | ← | |
| 18 | Crank Handle Asy. | 3.45 | SY318-03 | SY318-02 | QY318-06 | KZ318-13 | KZ318-02 | JY318-06 | KZ318-13 | KZ318-02 | KY318-03 | |
| 19 | Crank Nut | .60 | AZ003-01 | ← | ← | ← | ← | ← | ← | ← | ← | |
| 20 | Ratchet Spring | .52 | RY033-01 | ← | ← | ← | ← | ← | N/A | N/A | N/A | |
| 21 | Thumb Stop Spring | .78 | QY038-01 | ← | ← | ← | ← | ← | KY038-01 | ← | ← | |
| 22 | Crank Bushing | 3.00 | QY026-03 | ← | ← | WY026-01 | ← | ← | KY026-05 | ← | ← | |
| 23 | Spool Lip Washer | .52 | QY036-01 | ← | ← | N/A | | | N/A | | | |