

TRION G-X-7
4725GXR

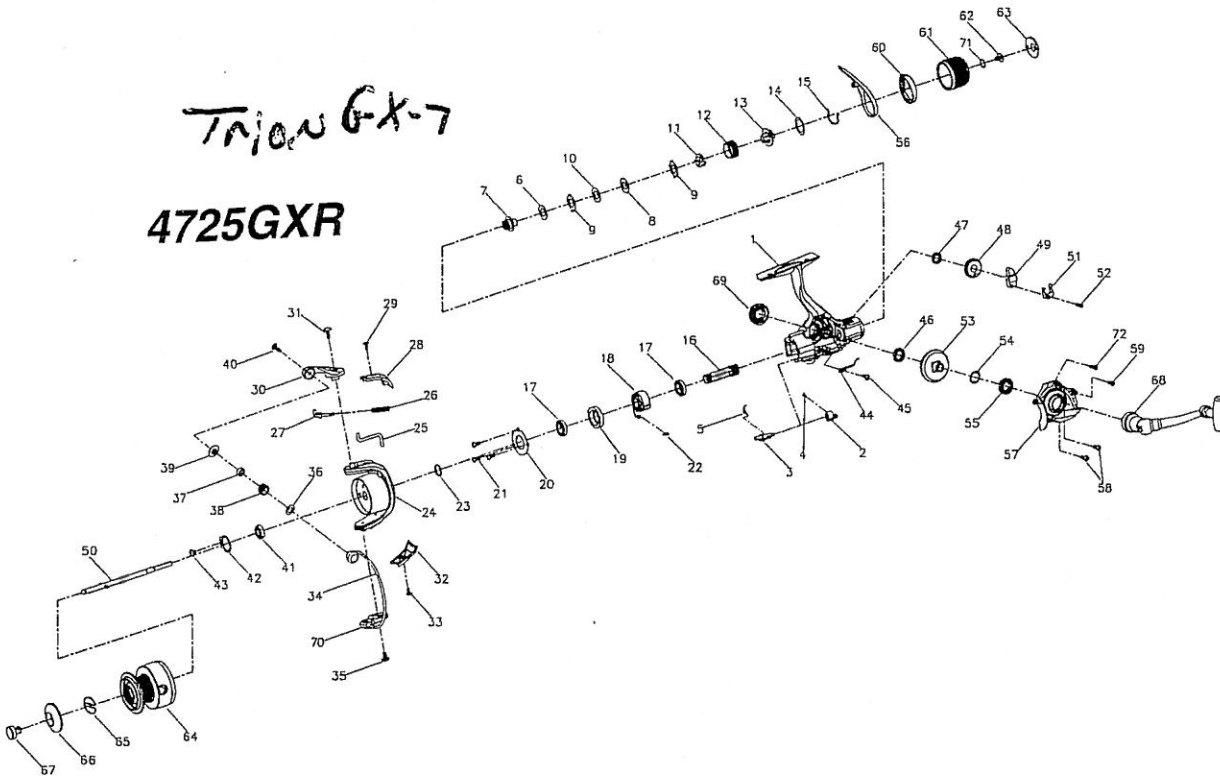

PART #	PART NAME	PART #	PART NAME	PART #	PART NAME
1	BODY ASSEMBLY	26	BAIL ARM SPRING	52	O/S SLIDER SCREW
2	N-R LEVER	27	BAIL ARM GUIDE	53	DRIVE GEAR
3	N-R LEVER SHAFT	28	BAIL ARM COVER	54	GEAR WASHER
4	N-R LEVER SCREW	29	COVER SCREW A	55	COVER BEARING
5	N-R LEVER SPRING	30	BAIL ARM	56	MIDDLE COVER
6	DRAG WASHER A	31	BAIL ARM SCREW	57	BODY COVER ASSEMBLY
7	DRAG STEM	32	BAIL HOLDER COVER	58	COVER SCREW A
8	LINING WASHER	33	COVER SCREW B	59	COVER SCREW B
9	EARED WASHER	34	BAIL WIRE ASSEMBLY	60	REAR COVER
10	DRAG WASHER B	35	BAIL HOLDER SCREW	61	DRAG KNOB ASSEMBLY
11	DRAG SPRING	36	LINE ROLLER WASHER	62	DRAG KNOB SCREW
12	DRAG SLEEVE	37	LINE ROLLER BEARING	63	DRAG KNOB COVER
13	DRAG INSERT	38	LINE ROLLER	64	SPOOL ASSEMBLY
14	DRAG RETAINER WASHER	39	LINE ROLLER COLLAR	65	SPOOL STOPPER
15	DRAG INSERT RETAINER	40	L-ROLLER SCREW	66	SPOOL CAP
16	PINION	41	ROTOR NUT	67	PUSH BUTTON
17	BALL BEARING 14 X 7 X 3.5	42	ROTOR NUT WASHER	68	HANDLE ARM ASSEMBLY
18	ONE-WAY CLUTCH ASSEMBLY	43	ROTOR NUT SCREW	69	DUST CAP ASSEMBLY
19	BEARING SLEEVE	44	BODY CLICK	70	BAIL HOLDER
20	BEARING COVER	45	BODY CLICK SCREW	71	DRAG KNOB SCREWWASHER
21	BEARING COVER SCREW	46	GEAR BEARING 12 X 8 X 2.5	72	COVER SCREW C
22	CLUTCH SPRING	47	O/S GEAR BEARING		
23	PINION WASHER	48	O/S GEAR		
24	ROTOR ASSEMBLY	49	O/S SLIDER		
25	TRIP PLUNGER	50	MAIN SHAFT ASSEMBLY		
		51	MAIN SHAFT HOLDER		