

Please order by parts number, not key number
 Veuillez indiquer le numéro de la pièce (Non "Key" No.)

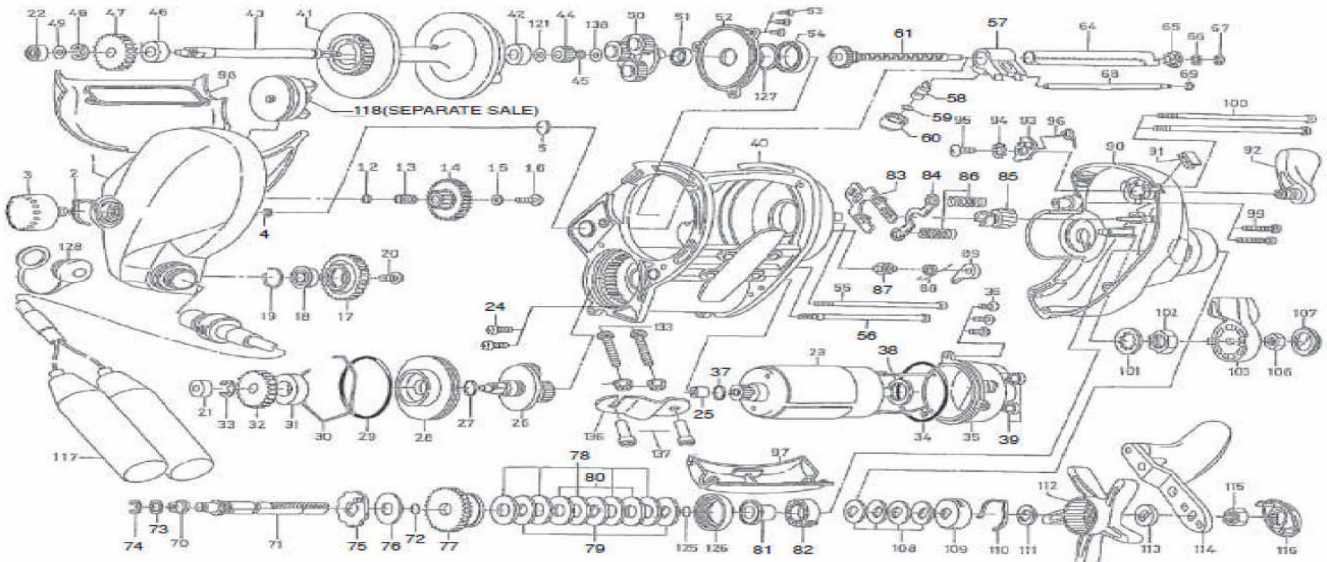

ELECTRONIC REEL

TANACOM BULL 750



Key No.	Parts No.	Parts Name	Key No.	Parts No.	Parts Name
1	H37-7601	IC MODULE L/S PLATE SET	68	F59-6601	LEVELWIND POST
2	E03-3201	BRAKE CLICK SPRING	69	B86-4101	LEVELWIND POST RETAINER
3	E48-9621	BRAKE ADJ KNOB	70	E25-2501	DRIVE SHAFT BUSHING
4	320-5901	MECHANICAL BRAKE KNOB RETAINER	71	F71-5303	DRIVE SHAFT
5	G22-5102	MECHANICAL BRAKE WASHER	72	F65-7801	DRAG O RING
12	E09-6504	IDLE GEAR(A) WASHER	73	375-5801	DRIVE SHAFT WASHER
13	H43-9801	IDLE GEAR(A) COLLAR	74	320-7601	DRIVE SHAFT WASHER RETAINER
14	H43-9901	IDLE GEAR(A)	75	F59-7301	RATCHET
15	F57-1902	IDLE GEAR(A) SCREW WASHER	76	374-6604	DRIVE SHAFT WASHER (B)
16	351-7706	IDLE GEAR(A) SCREW	77	G81-2001	DRIVE GEAR
17	G22-5201	IDLE GEAR(B)	78	B36-0209	EARED WASHER
18	G07-0301	IDLE GEAR(B) BALL BEARING	79	372-3833	DRAG DISC WASHER
19	G07-0201	IDLE GEAR(B) RING	80	B36-0302	DRAG LIP WASHER
20	353-8207	IDLE GEAR(B) SCREW	81	G82-9001	DRAG COLLAR (A)
21	637-5601	MOTOR GEAR(A) BUSHING	82	F71-5601	DRAG COLLAR (B)
22	637-2102	SPOOL SHAFT BALL BEARING	83	F59-7001	YOKE PLATE
23	G81-0402	MOTOR	84	E29-0601	YOKE
24	F70-1101	MOTOR SCREW	85	F74-0201	PINION GEAR
25	E29-2901	MOTOR GEAR (A) BUSHING	86	G12-7001	YOKE SPRING
26	G14-1302	MOTOR GEAR (A)	87	F77-3001	SPRING HOLDER
27	F71-4801	MOTOR GEAR (A) O RING	88	F60-8301	ANTI-REVERSE PAWL SPRING
28	F73-9601	MOTOR CASE PLATE	89	F59-7201	ANTI-REVERSE PAWL
29	F59-5801	MOTOR CASE O RING	90	G81-2601	R/S PLATE
30	F59-5901	MOTOR CASE RING	91	E28-6001	LINE HOLDER
31	F73-9701	MOTOR CASE BUSHING	92	F46-9006	CLUTCH LEVER
32	G22-5701	MOTOR GEAR (B)	93	F59-7901	CLUTCH CAM
33	320-1611	MOTOR GEAR (B) RETAINER	94	160-8001	CLUTCH LEVER WASHER
34	F59-5301	MOTOR HOLDER O RING	95	353-8212	CLUTCH LEVER SCREW
35	F59-5101	MOTOR HOLDER	96	F59-8201	CLUTCH CAM SPRING
36	351-6101	MOTOR HOLDER SCREW	97	F59-6910	MOTOR COVER
37	G48-8801	MOTOR O RING	98	F59-7609	FINGER COVER
38	F70-1201	MOTOR WASHER	99	353-8705	R/S PLATE SCREW(A)
39	F71-4601	CORD SHIELD	100	F59-8301	R/S PLATE SCREW(B)
40	G98-8901	FRAME	101	F28-5901	POWER LEVER WASHER
41	G78-0603	SPOOL	102	F30-3102	POWER LEVER NUT(A)
42	F81-7101	SPOOL SHAFT BUSHING	103	F42-9701	POWER LEVER
43	G22-5601	SPOOL SHAFT	106	342-4004	POWER LEVER NUT(B)
44	G12-6402	SPOOL SHAFT GEAR (A)	107	F43-0002	POWER LEVER COVER
45	G12-6501	SPOOL SHAFT GEAR (A) RETAINER	108	E25-3501	DRAG SPRING WASHER
46	636-6403	SPOOL SHAFT BALL BEARING	109	F47-0002	DRAG HOLDER
47	G22-5701	SPOOL SHAFT GEAR (B)	110	B74-7702	DRAG HOLDER LEAF SPRING
48	320-1611	SPOOL SHAFT GEAR (B) RETAINER	111	F47-0101	DRAG HOLDER WASHER
49	B41-1700	SPOOL SHAFT GEAR (B) WASHER	112	F55-0415	STAR DRAG
50	G12-6602	MOTOR GEAR(D)	113	F47-0303	HANDLE COLLAR
51	F59-4001	MOTOR GEAR(D) BUSHING	114	G67-8101	HANDLE
52	F59-4101	SPOOL PLATE	115	B86-2102	HANDLE NUT
53	F20-6901	SPOOL PLATE SCREW	116	F47-1205	HANDLE CAP
54	F38-9102	SPOOL PLATE BALL BEARING	117	G86-8701	ELECTRIC POWER CORD
55	F55-6501	FRAME SCREW (A)	118	Z01-0626	INPUT ROLLER (SEPARATE SALE)
56	F63-9701	FRAME SCREW (B)	121	371-6906	SPOOL SHAFT BUSHING WASHER (B)
57	G81-2102	LEVELWIND	125	F65-7801	DRAG O RING
58	122-0602	LEVELWIND PAWL	126	F81-7001	DRAG COLLAR SHIELD
59	F95-0200	LEVELWIND WASHER	127	F68-2600	SPOOL PLATE WASHER
60	E35-4101	LEVELWIND NUT	128	F66-1002	CONNECTOR CAP
61	G83-4701	WORM SHAFT	133	F18-7601	CLAMP SHAFT SCREW
64	F59-6501	WORM SHIELD	135	F18-7801	CLAMP SHAFT NUT
65	F46-7201	WORM SHAFT BUSHING (R)	136	041-5601	CLAMP PLATE
66	B41-1706	WORM SHAFT WASHER	137	F18-7701	CLAMP PLATE NUT
67	320-5901	WORM SHAFT RETAINER	138	375-4100	SPOOL GEAR WASHER