

SHIMANO®

1987 REPAIR MANUAL

Shimano American Corporation, One Shimano Dr.
Irvine, CA 92718

TO ORDER:

These reels belong to the "Triton Trolling Series."
Please order parts using the abbreviation
"TT" and the part number. The code numbers
are for cross-reference only.

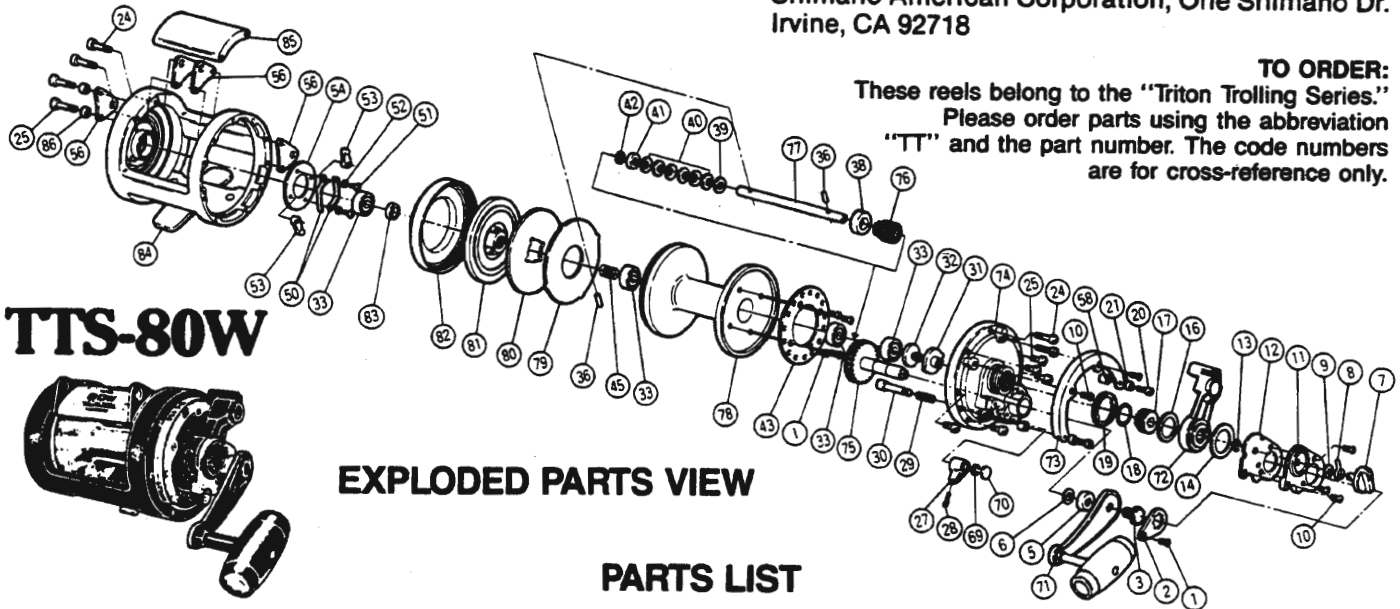

TTS-80W

EXPLODED PARTS VIEW

PARTS LIST

PART #	CODE #	DESCRIPTION	PART #	CODE #	DESCRIPTION
1.	7-1757 09500S	Handle Lock Screw	45.	7-1417 09500S	Pressure Plate Spring
2.	7-2124 09500S	Handle Lock	46.	7-1753 09500S	Titanium Drag Washer
3.	7-2141 09500S	Handle Bolt	47.	6-2118 09500S	Drag Plate
4.	6-2129 09500S	Handle	48.	6-1511 09500S	Pressure Plate
5.	7-2116 09500S	Gear Shaft Shield	49.	7-1750 09500S	Cooling Shield
6.	7-2101 09500S	Gear Shaft Thrust Washer	50.	7-1838 09500S	Dog Spring
7.	6-2084 09500S	Pre-Program Dial	51.	7-1890 09500S	Dog Spring Screw
8.	7-2086 09500S	Detent Spring	52.	7-1888 09500S	Spring Screw Washer
9.	7-2087 09500S	Detent Spring Washer	53.	7-1824 09500S	Dog
10.	7-2088 09500S	Cover/Quadrant Screw	54.	7-1501 09500S	Backing Plate
11.	6-1509 09500S	Lever Hub Cover	55.	6-15A9 09500S	One Piece Frame
12.	7-1801 09500S	Lever Retainer Plate	56.	7-15C2 09500S	Harness Lug
13.	7-0040 50600S	"C" Lock	57.	7-1507 09500S	Cross Bar
14.	7-2074 09500S	Lever Thrust Ring A	58.	7-2091 09510S	Quadrant Support
15.	6-2079 09500S	Drag Control Lever	59.	6-2009 09510S	Side Plate
16.	7-2073 09500S	Lever Thrust Ring B	60.	6-2109 09510S	Main Gear
17.	7-2067 09500S	Lever Shaft Body	61.	7-1702 09510S	Main Shaft
18.	7-2005 09500S	Body "O" Seal	62.	7-1701 09510S	Colfor Spool
19.	7-1732 09500S	Lever Hub Ratchet	63.	6-15A9 09510S	One Piece Frame
20.	7-2093 09500S	Quadrant Anchor Bolt	64.	7-1507 09510S	Cross Bar
21.	7-2092 09500S	Bolt Shield	65.	7-1702 09520S	Main Shaft
22.	7-2091 09500S	Quadrant Support	66.	7-1701 09520S	Colfor Spool
23.	6-2099 09500S	Lever Quadrant	67.	6-15A9 09520S	One Piece Frame
24.	7-15C3 09500S	Cross Bar Bolt	68.	7-1507 09520S	Cross Bar
25.	7-2028 09500S	Side Plate Bolt	69.	7-0040 30400S	Alert Plunger Retainer
26.	6-2009 09500S	Side Plate	70.	7-2075 09500S	Strike Alert Lever Seal
27.	7-2071 09500S	Strike Alert Lever	71.	6-2129 09800S	Handle
28.	7-2072 09500S	Alert Lever Retainer	72.	6-2079 09530S	Drag Control Lever
29.	7-1415 09500S	Plunger Spring	73.	6-2099 09530S	Lever Quadrant
30.	7-2070 09500S	Alert Plunger	74.	6-2009 09530S	Side Plate
31.	7-2066 09500S	Pre Program Key	75.	6-2109 09800S	Main Gear
32.	7-2060 09500S	Pre Program Screw	76.	7-1706 09530S	Pinion Gear
33.	7-1437 09500S	Ball Bearing	77.	7-1702 09530S	Main Shaft
34.	6-2109 09500S	Main Gear	78.	7-1701 09530S	Colfor Spool
35.	7-1706 09500S	Pinion Gear	79.	7-1753 09530S	Titanium Drag Washer
36.	7-1748 09500S	Cross Pin	80.	6-2118 09800S	Drag Plate
37.	7-1702 09500S	Main Shaft	81.	6-1511 09530S	Pressure Plate
38.	7-1707 09500S	Pinion Guard	82.	7-1750 09530S	Cooling Shield
39.	7-1716 09500S	Pre Load Washer	83.	7-1718 09530S	Spacer
40.	7-1755 09500S	Pre Load Spring H	84.	6-15A9 09530S	One Piece Frame
41.	7-1754 09500S	Inner Pre Load Washer	85.	7-1507 09530S	Cross Bar
42.	7-1738 09500S	Bearing Thrust Washer	86.	7-15C4 09530S	Bolt Shield
43.	7-1756 09500S	Alert Ratchet	87.	7-1775 09500S	Pre Load Spring L
44.	7-1701 09500S	Colfor Spool			

Prices and specifications subject to change without notice.

JUNE 1986