

SHIMANO®

1987 REPAIR MANUAL

Shimano American Corporation, One Shimano Dr.
Irvine, CA 92718

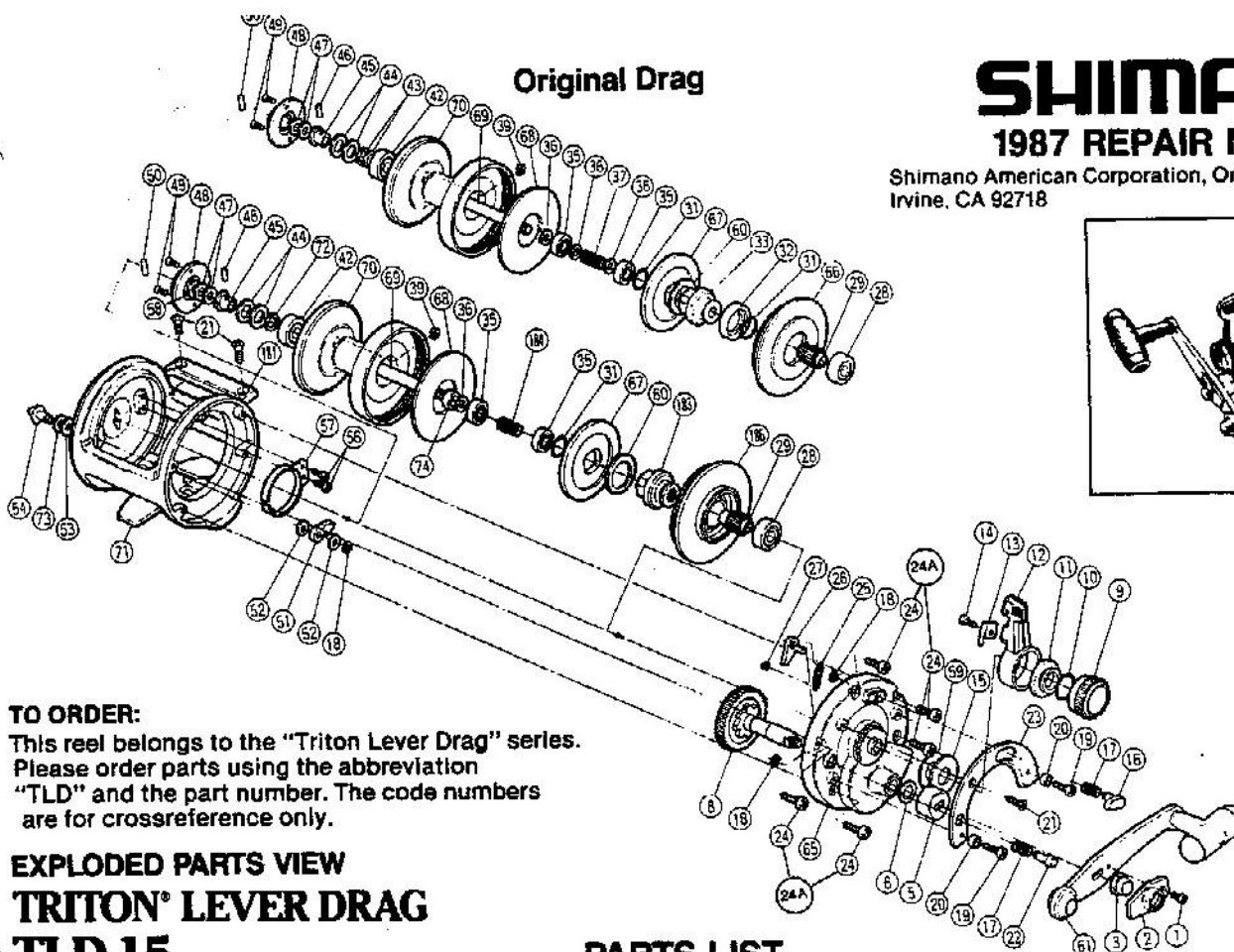

TO ORDER:

This reel belongs to the "Triton Lever Drag" series. Please order parts using the abbreviation "TLD" and the part number. The code numbers are for crossreference only.

EXPLODED PARTS VIEW

TRITON® LEVER DRAG

TLD 15

PARTS LIST

| PART # | CODE # | DESCRIPTION | PART # | CODE # | DESCRIPTION |
|--------|---------------|----------------------------|--------|---------------|---------------------------------|
| 1. | 7-0014 30111S | Handle Lock Screw | 45. | 7-1762 09000S | Pre-Load Body |
| 2. | 7-2124 06700S | Handle Lock | 46. | 7-1763 09000S | Cross Pin A |
| 3. | 7-2123 09000S | Handle Nut | 47. | 7-1738 09000S | Spacer A |
| 5. | 7-2171 09000S | Gear Shaft Shield | 48. | 6-1739 09000S | Click Gear |
| 6. | 7-2111 06101S | Gear Shaft Thrust Washer | 49. | 7-0012 00100S | Click Gear Screw |
| 8. | 6-2109 09000S | Main Gear | 50. | 7-1760 09000S | Cross Pin B |
| 9. | 6-2089 09000S | Pre-Program Dial | 51. | 7-1414 09300S | Click Pawl |
| 10. | 7-0160 32300S | Body "O" Seal | 52. | 7-1471 09300S | Click Pawl Washer |
| 11. | 7-2096 09000S | Lever Shaft Body | 53. | 7-1470 09300S | Click Button Washer A |
| 12. | 7-2076 09000S | Drag Control Lever | 54. | 7-1468 09000S | Click Button |
| 13. | 7-1445 09000S | Lever Click Spring | 56. | 7-0013 30140S | Click Spring Screw |
| 14. | 7-0014 30220S | Click Spring Screw | 57. | 7-1415 09001S | Click Spring |
| 15. | 7-2073 09000S | Lever Thrust Ring | 59. | | Spacer |
| 16. | 7-2080 09000S | Strike Stop | 60. | 7-1755 09000S | Pre-Load Spring A |
| 17. | 7-20A2 09000S | Pressure Spring | 61. | 6-2129 09001S | Handle |
| 18. | 7-0040 30400S | "C" Lock | 65. | 6-2019 09020S | Side Plate |
| 19. | 7-0011 30811S | Quadrant Anchor Bolt | 66. | 7-1770 09020S | Cooling Shield |
| 20. | 7-2098 09000S | Bolt Shield | 67. | 6-1769 09020S | Drag Plate |
| 21. | 7-0012 30411S | Quadrant/Line Guard Screw | 68. | 7-1766 09020S | Titanium Drag Washer |
| 22. | 7-20A1 09000S | Free Spool Detent | 69. | 7-1702 09020S | Main Shaft |
| 23. | 7-2090 09000S | Lever Quadrant | 70. | 7-1701 09020S | Spool |
| 24. | 7-0013 40571S | Side Plate Bolt | 71. | 6-15A909020S | One-Piece Body |
| 24A. | | Side Plate Bolt (oversize) | 72. | 7-1754 090100 | Pre-Load Washer A* |
| 25. | 7-1838 09000S | Dog Spring | 73. | 7-1620 09300S | Click Button Washer B |
| 26. | 7-1824 09000S | Dog | 74. | 7-1718 090000 | Bushing** |
| 27. | 7-0050 01010S | Dog Spring Retainer | 181. | 7-15C7090200 | Line Guard* |
| 28. | 7-0402 27301S | Ball Bearing (with grease) | 183. | 6-1707 09000S | Pinion Guard (New)** |
| 29. | 7-1706 09000S | Pinion Gear | 184. | 7-1765 090010 | Pressure Release Spring (New)** |
| 31. | 7-1788 09000S | Seal Lock | 186. | 6-1779 090210 | Cooling Shield (New)** *** |
| 32. | 7-1771 09000S | Shield Seal | | | |
| 33. | 7-1707 09000S | Pinion Guard | | | |
| 35. | 7-1517 10000S | Ball Bearing | | | |
| 36. | 7-1764 09000S | Bearing Thrust Washer | | | |
| 37. | 7-1765 09000S | Pressure Release Spring | | | |
| 39. | 7-0042 18400S | "C" Lock | | | |
| 42. | 7-0402 27302S | Ball Bearing (with oil) | | | |
| 43. | 7-1754 09001S | Pre-Load Washer **** | | | |
| 44. | 7-1755 09002S | Pre-Load Spring B | | | |

*Not present on early versions.

**No interchangeability with older parts.

***Identified by rubber seal around center hole.

****Original drag used two pieces of part #43, newer reels use 1 piece of 72 instead.