

SHIMANO

Metanium S A-RB

META-XGR

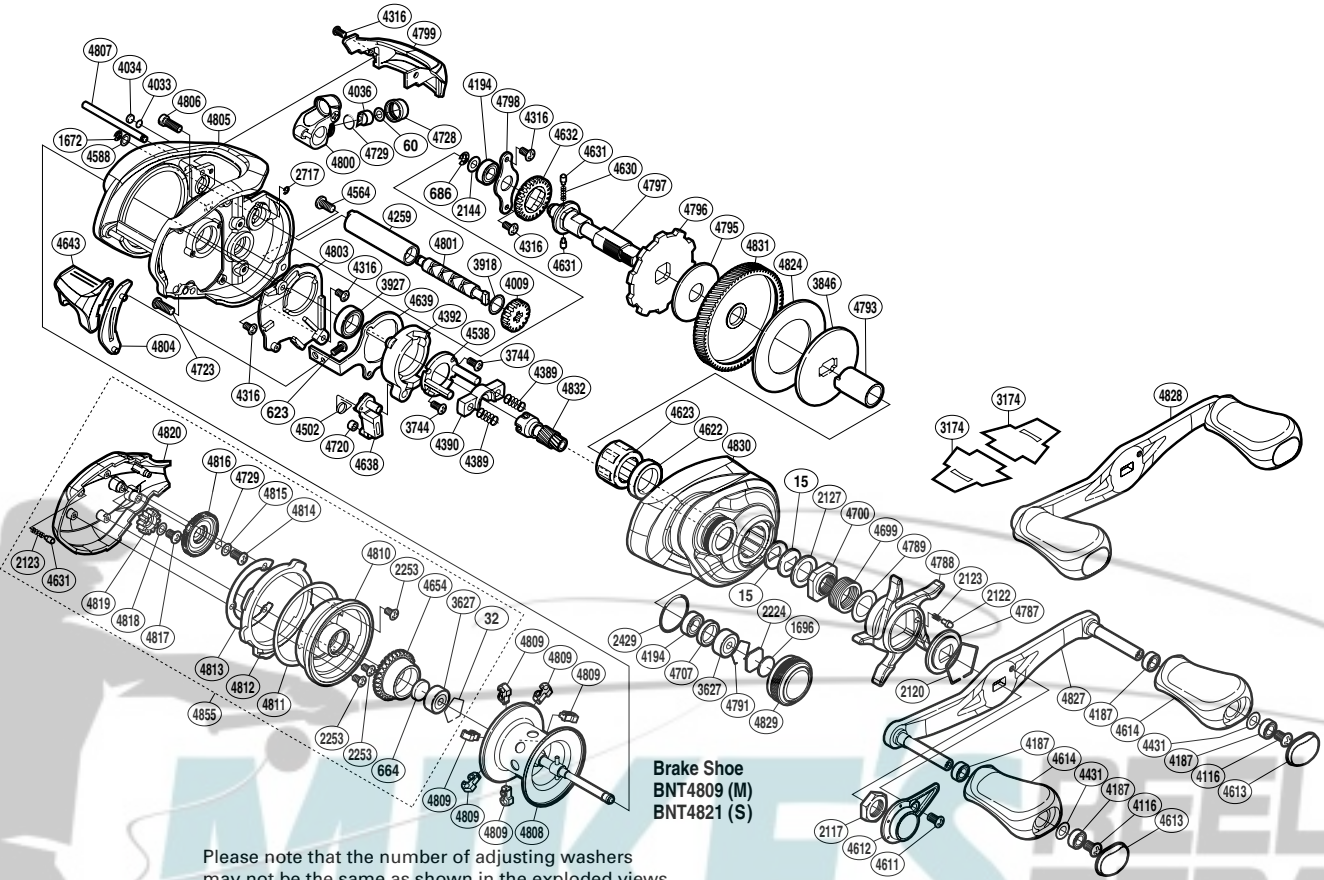

Please note that the number of adjusting washers may not be the same as shown in the exploded views. (Adjustment will vary with each individual product.)

(51RH754000U)

| Part No. | Description | Part No. | Description | Part No. | Description |
|----------|----------------------|----------|----------------------------|----------|------------------------------|
| BNT0015 | Drag Spring Washer | BNT4392 | Clutch Cam | BNT4798 | Drive Shaft Retainer |
| BNT0032 | Bearing Retainer | BNT4431 | Washer | BNT4799 | Level Wind Protector |
| BNT0060 | Spacer | BNT4502 | Clutch Pawl Spring | BNT4800 | Line Guide |
| BNT0623 | Screw | BNT4538 | Clutch Cam Retainer | BNT4801 | Worm Shaft |
| BNT0664 | Spacer B | BNT4564 | Screw | BNT4803 | Clutch Guard |
| BNT0686 | E Lock | BNT4588 | Washer | BNT4804 | Clutch Bar Guide |
| BNT1672 | E Lock | BNT4611 | Screw | BNT4805 | One-Piece Frame |
| BNT1696 | Cast Control Spacer | BNT4612 | Handle Retainer | BNT4806 | Screw |
| BNT2117 | Handle Nut | BNT4613 | Handle Knob Seal | BNT4807 | Level Wind Guide |
| BNT2120 | Click Plate Retainer | BNT4614 | Handle Knob | BNT4808 | Spool Assembly |
| BNT2122 | Click Pin | BNT4622 | Drive Shaft Holder Bushing | BNT4809 | Brake Shoe M |
| BNT2123 | Click Spring | BNT4623 | Roller Clutch Bearing | BNT4810 | Brake Case |
| BNT2127 | Star Drag Spacer | BNT4630 | Idle Gear Spring | BNT4811 | Washer |
| BNT2144 | Washer | BNT4631 | Idle Gear Pin | BNT4812 | Side Plate Cam Lever |
| BNT2224 | Spool Tension Spacer | BNT4632 | Idle Gear | BNT4813 | Brake Case Washer |
| BNT2253 | Screw | BNT4638 | Clutch Pawl | BNT4814 | Screw |
| BNT2429 | O Ring | BNT4639 | Clutch Plate | BNT4815 | Washer |
| BNT2717 | E Lock | BNT4643 | Quick-Fire II Clutch Bar | BNT4816 | BR Dial |
| BNT3627 | Ball Bearing | BNT4654 | Brake Pipe Gear | BNT4817 | Screw |
| BNT3744 | Screw | BNT4699 | Star Drag Spring | BNT4818 | Washer |
| BNT3846 | Key Washer | BNT4700 | Star Drag Nut | BNT4819 | Idle Gear |
| BNT3918 | Washer | BNT4707 | Bearing Spacer | BNT4820 | Left Side Plate |
| BNT3927 | Ball Bearing | BNT4720 | Clutch Pawl Bushing | BNT4824 | Drag Washer |
| BNT4009 | Idle Gear | BNT4723 | Screw | BNT4827 | Handle Shank Assembly |
| BNT4033 | Washer | BNT4728 | Pawl Cap | BNT4828 | Handle Assembly |
| BNT4034 | Anti-Thrust Washer | BNT4729 | O Ring | BNT4829 | Cast Control Cap |
| BNT4036 | Line Guide Pawl | BNT4787 | Star Drag Click Plate | BNT4830 | Right Side Plate |
| BNT4116 | Screw | BNT4788 | Star Drag | BNT4831 | Drive Gear |
| BNT4187 | Ball Bearing | BNT4789 | Washer | BNT4832 | Pinion Gear |
| BNT4194 | Ball Bearing | BNT4791 | Bearing Retainer | BNT4855 | Left Side Plate Assembly |
| BNT4259 | Level Wind Guard | BNT4793 | Roller Clutch Inner Tube | | |
| BNT4316 | Screw | BNT4795 | Drag Washer | BNT3174 | Reel Seat Spacer (accessory) |
| BNT4389 | Yoke Spring | BNT4796 | Anti-Reverse Ratchet | BNT4692 | B-100 Oil (accessory) |
| BNT4390 | Yoke | BNT4797 | Drive Shaft | BNT4821 | Brake Shoe S (accessory) |