

# SHIMANO®

## CUSTOM GT3000 PLUS

1985 PRODUCTION (Red Anti-Reverse Lever)

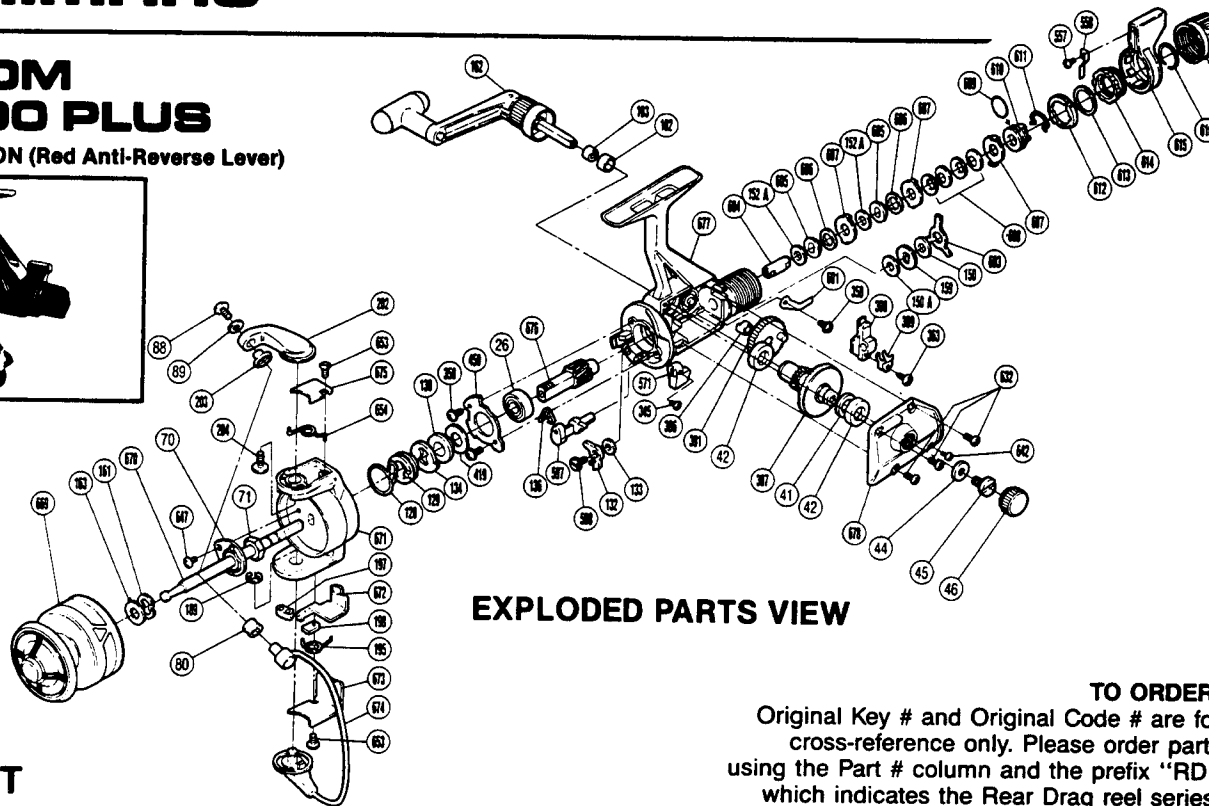
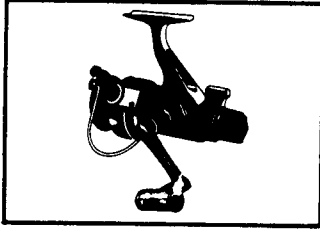

EXPLODED PARTS VIEW

### TO ORDER

Original Key # and Original Code # are for cross-reference only. Please order part using the Part # column and the prefix "RD" which indicates the Rear Drag reel series

## PARTS LIST

PART #	ORIGINAL KEY #	ORIGINAL CODE #	DESCRIPTION	PART #	ORIGINAL KEY #	ORIGINAL CODE #	DESCRIPTION
669.	1.	6-0209 31130S	Spool Assembly	391.	42.	6-0449 27330S	Oscillating Gear Assembly
163.	2.	7-0217 26300S	Spool Washer	42.	43.	7-0617 26100S	Drive Gear Bushing
161.	3.	7-2101 09100S	Tension Spring	387.	44.	7-0408 27200S	Drive Gear
670.	4.	6-0219 27302S	Main Shaft Assembly	41.	45.	7-0446 01100S	Drive Gear Washer
647.	5.	7-0014 30220S	Nut Lock Screw	678.	46.	6-0609 33300S	Side Cover
70.	6.	7-0360 26200S	Rotor Nut Lock Plate	44.	47.	7-0725 05500S	Handle Lock Washer
71.	7.	7-0311 01100S	Rotor Nut	45.	48.	7-0710 05100S	Handle Lock Screw
671.	8.	7-0301 29300S	Rotor	46.	49.	7-0453 26100S	Handle Screw Cap
197.	9.	7-0355 29200S	Bail Trip Slide Cam	601.	50.	7-0122 32300S	Drag Click
672.	10.	7-0336 29330S	Bail Trip Lever	390.	51.	7-0410 29320S	Oscillating Slider
198.	11.	7-0369 29200S	Trip Lever Guide	399.	52.	7-0538 29300S	Oscillating Slider Retainer
195.	12.	7-0337 29201S	Lever Spring	363.	53.	7-0014 30120S	Slider Retainer Screw
673.	13.	7-0338 33300S	Bail Trip Cover	632.	54.	7-0011 40302S	Side Cover Screw A
674.	14.	6-0309 33300S	Bail	642.	55.	7-0011 30711S	Side Cover Screw B
653.	15.	7-0013 40360S	Cover Screw	150A.	56.	7-0139 26310S	Drag Washer "C <sub>2</sub> " (White)
80.	16.	7-0304 01100S	Line Roller	159.	57.	7-0113 26300S	Click Gear
189.	17.	7-0040 00550S	"E" Lock	150.	58.	7-0139 26300S	Drag Washer "C <sub>1</sub> "
654.	18.	7-0310 29200S	Bail Spring	603.	59.	7-0159 32300S	Eared Washer "BF"
675.	19.	7-0307 33300S	Bail Spring Cover	604.	60.	7-0112 32300S	Drag Shaft
202.	20.	7-0303 28820S	Bail Arm	152A.	61.	7-0140 26310S	Drag Washer "D"
88.	21.	7-0013 40410S	Line Roller Screw	605.	62.	7-0115 29300S	Key Washer "A"
89.	22.	7-0316 01100S	Lock Washer	606.	63.	7-0146 32300S	Drag Washer "F"
203.	23.	7-0318 28820S	Line Roller Washer	607.	64.	7-0116 32300S	Eared Washer "B"
204.	24.	7-0013 40430S	Bail Arm Screw	608.	65.	7-0150 32300S	Coned Disc Springs
128.	25.	7-0422 29300S	Anti-Reverse Pawl Spring	609.	66.	7-0160 32300S	"O" Ring
129.	26.	7-0498 21800S	Anti-Reverse Spring Holder	610.	67.	7-0110 32300S	Pressure Screw
134.	27.	7-0421 21800S	Anti-Reverse Ratchet	611.	68.	7-0149 32300S	Hold Click Spring
130.	28.	7-0428 29330S	Pinion Spacer	612.	69.	7-0155 32300S	Lever Click Gear
358.	29.	7-0011 30470S	Bearing Retainer Screw	613.	70.	7-0157 32300S	Fightin' Pressure Screw Washer
459.	30.	7-0403 29300S	Bearing Retainer	614.	71.	7-0156 32300S	Fightin' Pressure Screw
26.	31.	7-0402 19300S	Ball Bearing	557.	72.	7-0010 00110S	Fightin' Drag Click Screw
676.	32.	7-0407 29320S	Pinion Gear	558.	73.	7-0154 32100S	Fightin' Drag Click
136.	33.	7-0426 21300S	Anti-Reverse Cam Spring	615.	74.	6-0441 32300S	Fightin' Drag Lever
597.	34.	7-0424 32300S	Anti-Reverse Cam	616.	75.	7-0158 32300S	Lever Hold Spring
598.	35.	7-0425 29300S	Anti-Reverse Pawl Screw	679.	76.	6-0439 30300S	Drag Programmer
132.	36.	6-0419 21800S	Anti-Reverse Pawl Assembly	662.	77.	7-0013 50400S	Drag Programmer Screw
133.	37.	7-0457 05800S	Anti-Reverse Pawl Spacer	162.	78.	6-0709 27330S	Handle Assembly
677.	38.	6-0409 33300S	Body	103.	79.	7-0743 26200S	Handle Lock Spacer
571.	39.	7-0404 32200S	Anti-Reverse Lever	102.	80.	7-0731 26200S	Handle Lock Ring
345.	40.	7-0013 00110S	Anti-Reverse Lever Screw	419.	81.	7-0514 28110S	Bushing Washer
386.	41.	7-0537 29300S	Oscillating Gear Bushing				