

SHIMANO®

1987 REPAIR MANUAL

Shimano American Corporation, One Shimano Dr.
Irvine, CA 92718

NEW DRAG PARTS

| | |
|------------------------------|------|
| 440. Drag Knob Click Spring* | .20 |
| 441. Drag Shaft | 1.20 |
| 450. Lock Washer | .20 |
| 451. Lock Spring | .15 |
| 452. Base Spring Washer | .15 |
| 453. Spring Housing | .50 |

*New Longer Spring

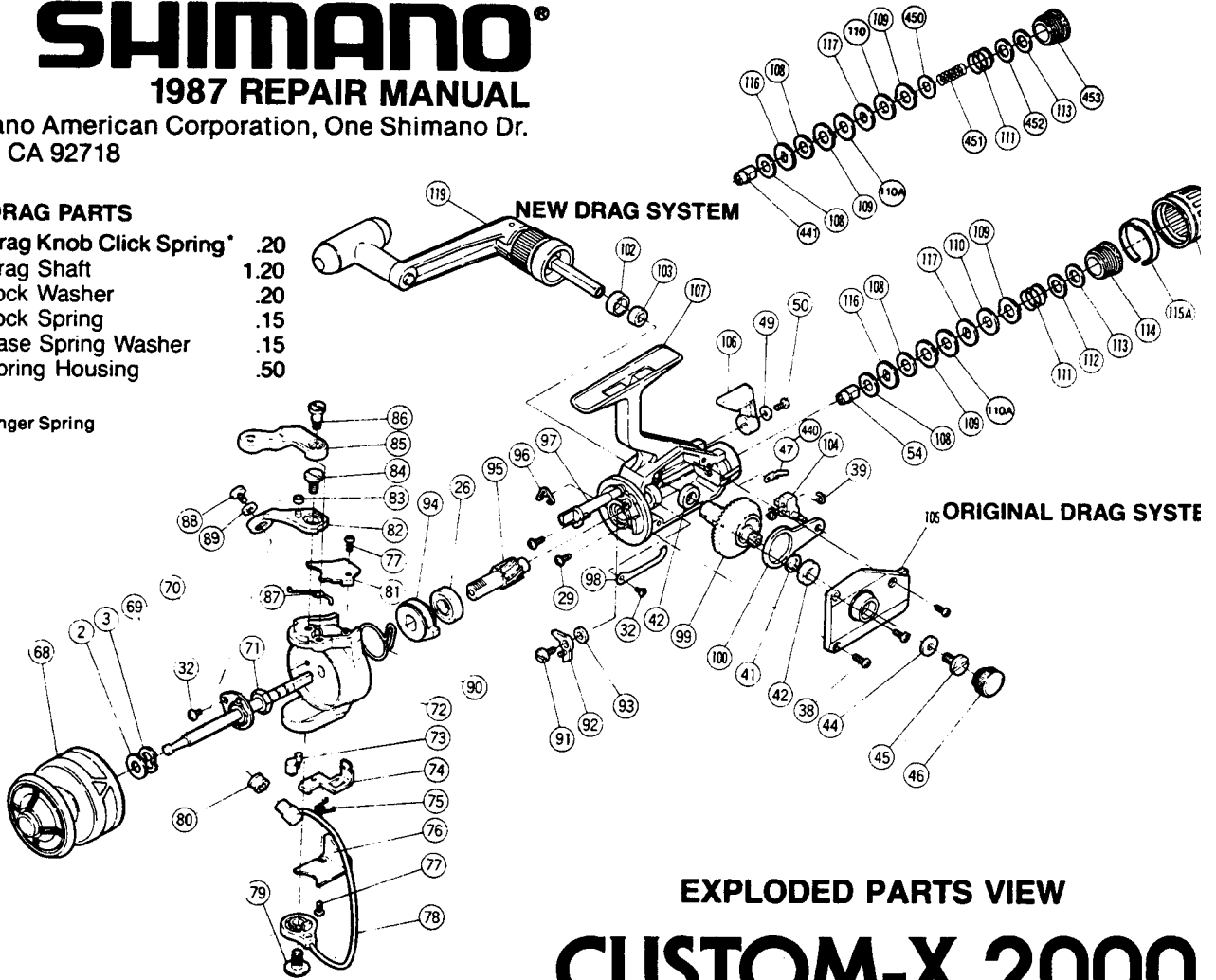

EXPLODED PARTS VIEW

CUSTOM-X 2000

TO ORDER:

This reel belongs to the "Rear Drag" series.
Please order parts using the abbreviation
"RD" and the part number.

PARTS LIST

| PART# DESCRIPTION | PART# DESCRIPTION | PART# DESCRIPTION |
|-------------------|-------------------|-------------------|
|-------------------|-------------------|-------------------|