

SHIMANO

CHRONARCH S A-RB

CH-50E

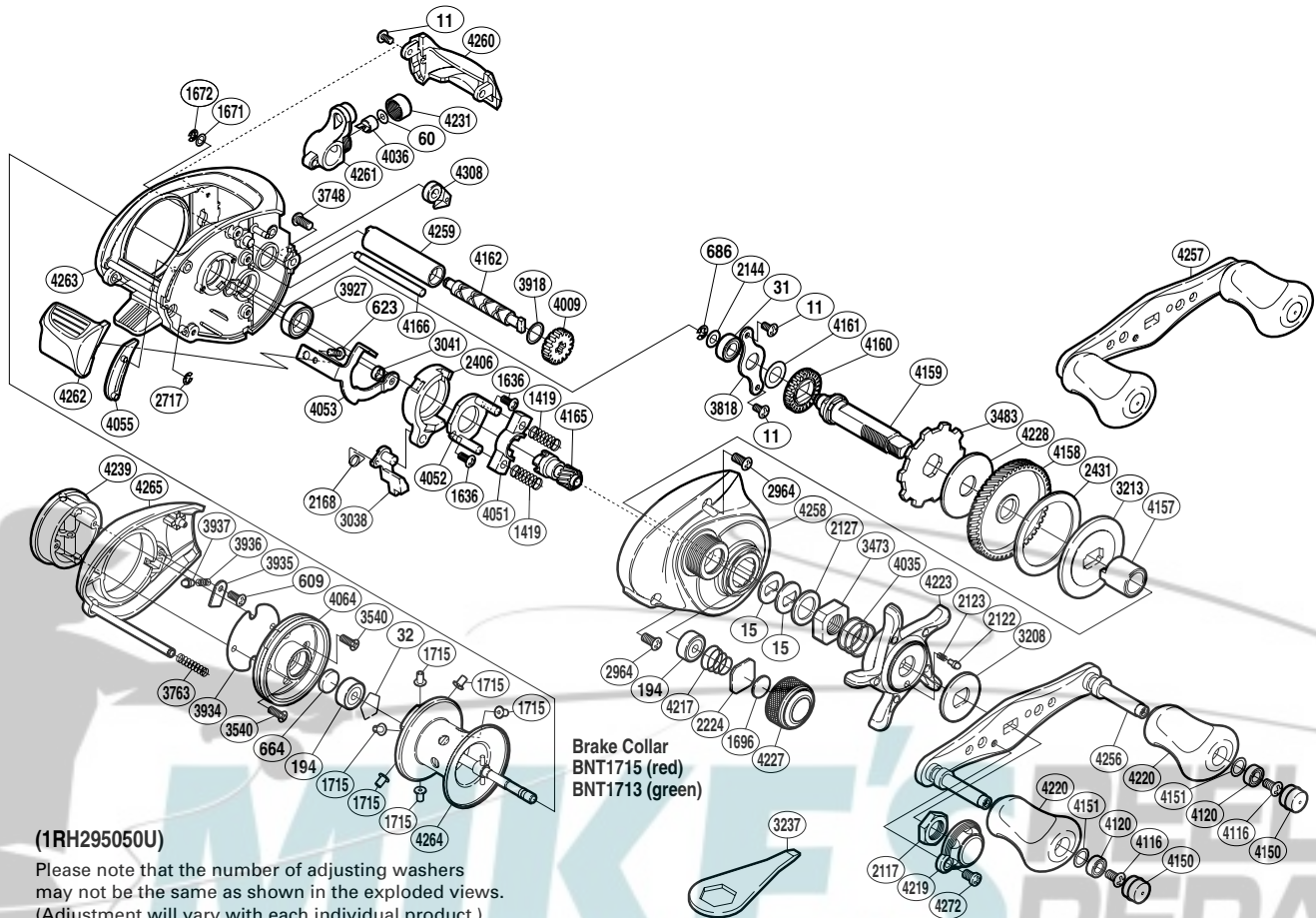

(1RH295050U)

Please note that the number of adjusting washers may not be the same as shown in the exploded views. (Adjustment will vary with each individual product.)

Part No.	Description	Part No.	Description	Part No.	Description
BNT0011	Screw	BNT3208	Star Drag Click Plate	BNT4160	Idle Gear
BNT0015	Drag Spring Washer	BNT3213	Key Washer	BNT4161	Washer
BNT0031	Ball Bearing	BNT3473	Star Drag Nut	BNT4162	Worm Shaft
BNT0032	Bearing Retainer	BNT3483	Anti-Reverse Ratchet	BNT4165	Pinion Gear
BNT0060	Spacer	BNT3540	Screw	BNT4166	Level Wind Guide
BNT0194	Ball Bearing	BNT3748	Screw	BNT4217	Spool Tension Spring
BNT0609	Screw	BNT3763	Side Plate Spring	BNT4219	Handle Retainer
BNT0623	Screw	BNT3818	Drive Shaft Retainer	BNT4220	Handle Knob
BNT0664	Spacer B	BNT3918	Washer	BNT4223	Star Drag
BNT0686	E Lock	BNT3927	Ball Bearing	BNT4227	Cast Control Cap
BNT1419	Yoke Spring	BNT3934	Brake Case Spacer	BNT4228	Drag Washer
BNT1636	Screw	BNT3935	Brake Spring Retainer	BNT4231	Pawl Cap
BNT1671	Washer	BNT3936	Click Spring	BNT4239	Turnkey Dial
BNT1672	E Lock	BNT3937	Click Pin	BNT4256	Handle Shank Assembly
BNT1696	Cast Control Spacer	BNT4009	Idle Gear	BNT4257	Handle Assembly
BNT1715	Brake Collar (red)	BNT4035	Star Drag Spring	BNT4258	Right Side Plate
BNT2117	Handle Nut	BNT4036	Line Guide Pawl	BNT4259	Level Wind Guard
BNT2122	Click Pin	BNT4051	Yoke	BNT4260	Level Wind Protector
BNT2123	Click Spring	BNT4052	Clutch Cam Retainer	BNT4261	Line Guide
BNT2127	Star Drag Spacer	BNT4053	Clutch Plate	BNT4262	Quick-Fire II Clutch Bar
BNT2144	Washer	BNT4055	Clutch Bar Guide	BNT4263	One-Piece Frame
BNT2168	Clutch Pawl Spring	BNT4064	Brake Case	BNT4264	Spool Assembly
BNT2224	Spool Tension Spacer	BNT4116	Screw	BNT4265	Left Side Plate
BNT2406	Clutch Cam	BNT4120	Ball Bearing	BNT4272	Screw
BNT2431	Drag Washer	BNT4150	Handle Knob Seal	BNT4308	Anti-Reverse Pawl
BNT2717	E Lock	BNT4151	Washer		
BNT2964	Screw	BNT4157	Roller Clutch Inner Tube		
BNT3038	Clutch Pawl	BNT4158	Drive Gear	BNT1713	Brake Collar (green) (accessory)
BNT3041	Clutch Plate Shaft Support	BNT4159	Drive Shaft	BNT3237	Wrench (accessory)