

SHIMANO®

CURADO®

CU-200BSF

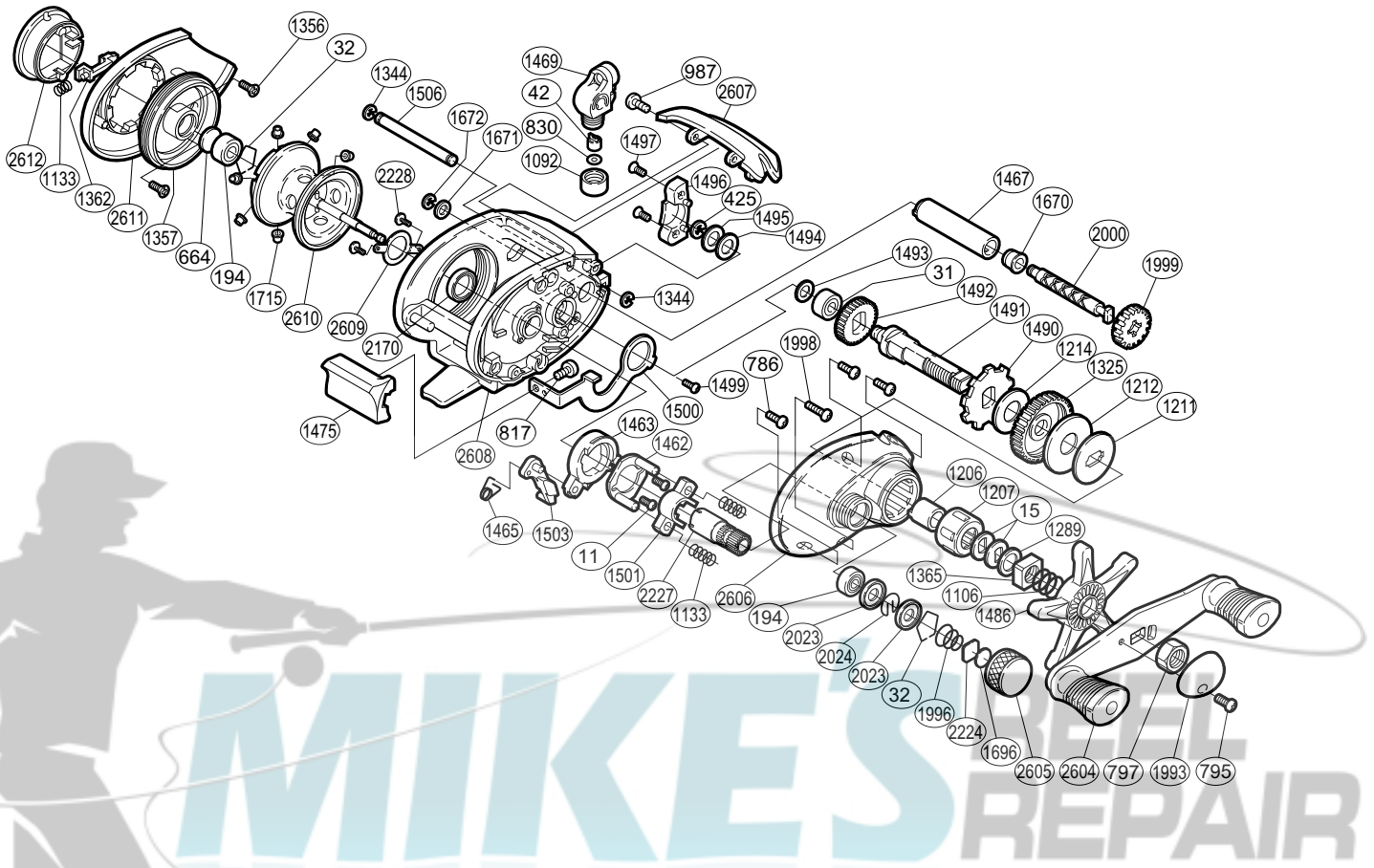

Part No.	Description	Part No.	Description	Part No.	Description
BNT0011	Clutch Cam Screw	BNT1356	Brake Case Retainer Screw	BNT1671	Worm Shaft Washer (B)
BNT0015	Drag Spring Washer	BNT1357	Brake Case	BNT1672	"E" Lock
BNT0031	Ball Bearing	BNT1362	Turnkey Pawl	BNT1696	Cast Control Spacer (B)
BNT0032	Bearing Retainer	BNT1365	Star Drag Nut	BNT1715	Brake Collar (red)
BNT0042	Line Guide Pawl	BNT1462	Clutch Cam Retainer	BNT1993	Handle Nut Plate Assembly
BNT0194	Ball Bearing	BNT1463	Clutch Cam	BNT1996	Spool Tension Spring
BNT0425	"E" Lock	BNT1465	Clutch Pawl Spring	BNT1998	Side Plate Screw (long)
BNT0664	Spacer (B)	BNT1467	Level Wind Guard	BNT1999	Idle Gear (C)
BNT0786	Side Plate Screw (short)	BNT1469	Line Guide	BNT2000	Worm Shaft
BNT0795	Handle Nut Plate Screw	BNT1475	Quick-Fire II Clutch Bar	BNT2023	Spool Shaft Clip Holder
BNT0797	Handle Nut	BNT1486	Star Drag	BNT2024	Spool Shaft Clip
BNT0817	Clutch Bar Screw	BNT1490	Anti-Reverse Ratchet	BNT2170	Ball Bearing
BNT0830	Spacer (optional)	BNT1491	Drive Shaft	BNT2224	Spool Tension Spacer (A)
BNT0987	Thumb Rest Screw	BNT1492	Idle Gear (A)	BNT2227	Pinion Gear
BNT1106	Star Drag Spring	BNT1493	Drive Gear Washer	BNT2228	Bearing Retainer Screw
BNT1133	Yoke / Turnkey Pawl Spring	BNT1494	Drive Shaft Washer (B)	BNT2604	Handle Assembly
BNT1206	Roller Clutch Inner Tube	BNT1495	Drive Shaft Washer (A)	BNT2605	Cast Control Cap
BNT1207	Roller Clutch Bearing	BNT1496	Drive Shaft Cover	BNT2606	Right Side Plate
BNT1211	Key Washer	BNT1497	Drive Shaft Cover Screw	BNT2607	Thumb Rest
BNT1212	Drag Washer (C)	BNT1499	Clutch Plate Screw	BNT2608	One-Piece Frame
BNT1214	Drag Washer (A)	BNT1500	Clutch Plate	BNT2609	Bearing Retainer
BNT1289	Star Drag Spacer	BNT1501	Yoke	BNT2610	Spool Assembly
BNT1325	Drive Gear	BNT1503	Clutch Pawl	BNT2611	Left Side Plate
BNT1344	"C" Lock	BNT1506	Line Guard	BNT2612	Turnkey Dial
		BNT1670	Worm Bushing		