

# SHIMANO

## ANTARES S A-RB

## ANT-R

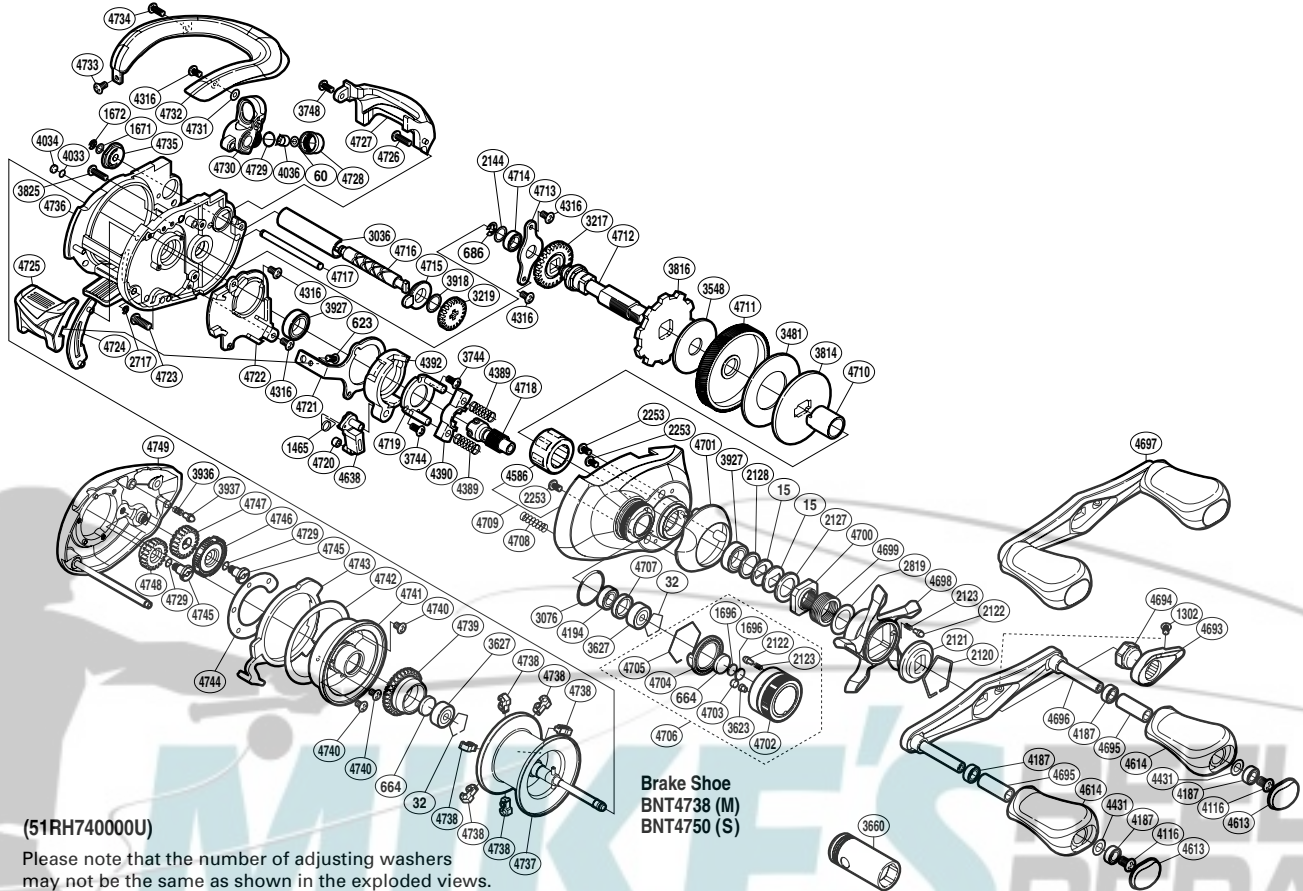

(51RH74000U)

Please note that the number of adjusting washers may not be the same as shown in the exploded views. (Adjustment will vary with each individual product.)

| Part No. | Description               | Part No. | Description               | Part No. | Description              |
|----------|---------------------------|----------|---------------------------|----------|--------------------------|
| BNT0015  | Drag Spring Washer        | BNT4033  | Washer                    | BNT4716  | Worm Shaft               |
| BNT0032  | Bearing Retainer          | BNT4034  | Anti-Thrust Washer        | BNT4717  | Stabilizer Bar           |
| BNT0060  | Spacer                    | BNT4036  | Line Guide Pawl           | BNT4718  | Pinion Gear              |
| BNT0623  | Screw                     | BNT4116  | Screw                     | BNT4719  | Clutch Cam Retainer      |
| BNT0664  | Spacer B                  | BNT4187  | Ball Bearing              | BNT4720  | Clutch Pawl Bushing      |
| BNT0686  | E Lock                    | BNT4194  | Ball Bearing              | BNT4721  | Clutch Plate             |
| BNT1302  | Screw                     | BNT4316  | Screw                     | BNT4722  | Clutch Guard             |
| BNT1465  | Clutch Pawl Spring        | BNT4389  | Yoke Spring               | BNT4723  | Screw                    |
| BNT1671  | Washer                    | BNT4390  | Yoke                      | BNT4724  | Clutch Bar Guide B       |
| BNT1672  | E Lock                    | BNT4392  | Clutch Cam                | BNT4725  | Quick-Fire II Clutch Bar |
| BNT1696  | Cast Control Spacer       | BNT4431  | Washer                    | BNT4726  | Screw                    |
| BNT2120  | Click Plate Retainer      | BNT4586  | Roller Clutch Bearing     | BNT4727  | Level Wind Protector     |
| BNT2121  | Star Drag Click           | BNT4613  | Handle Knob Seal          | BNT4728  | Pawl Cap                 |
| BNT2122  | Click Pin                 | BNT4614  | Handle Knob               | BNT4729  | O Ring                   |
| BNT2123  | Click Spring              | BNT4638  | Clutch Pawl               | BNT4730  | Line Guide               |
| BNT2127  | Star Drag Spacer          | BNT4693  | Handle Nut Plate          | BNT4731  | Spacer                   |
| BNT2128  | Bearing Washer            | BNT4694  | Handle Nut                | BNT4732  | Thumb Rest               |
| BNT2144  | Washer                    | BNT4695  | Handle Knob Pipe          | BNT4733  | Screw                    |
| BNT2253  | Screw                     | BNT4696  | Handle Shank Assembly     | BNT4734  | Screw                    |
| BNT2717  | E Lock                    | BNT4697  | Handle Assembly           | BNT4735  | Worm Bushing B           |
| BNT2819  | Washer                    | BNT4698  | Star Drag                 | BNT4736  | One-Piece Frame          |
| BNT3036  | Level Wind Guard          | BNT4699  | Star Drag Spring          | BNT4737  | Spool Assembly           |
| BNT3076  | O Ring                    | BNT4700  | Star Drag Nut             | BNT4738  | Brake Shoe M             |
| BNT3217  | Idle Gear                 | BNT4701  | Clutch Button Attachment  | BNT4739  | Brake Ring Gear          |
| BNT3219  | Idle Gear                 | BNT4702  | Cast Control Cap          | BNT4740  | Screw                    |
| BNT3481  | Drag Washer               | BNT4703  | Retainer Sheet            | BNT4741  | Brake Case               |
| BNT3548  | Drag Washer               | BNT4704  | Cast Control Click Plate  | BNT4742  | Washer                   |
| BNT3623  | Cast Control Cap Retainer | BNT4705  | Cast Control Click Holder | BNT4743  | Side Plate Cam Lever     |
| BNT3627  | Ball Bearing              | BNT4706  | Cast Control Cap Assembly | BNT4744  | Brake Case Washer        |
| BNT3744  | Screw                     | BNT4707  | Bearing Spacer            | BNT4745  | Screw                    |
| BNT3748  | Screw                     | BNT4708  | Damper Spring             | BNT4746  | BR Dial                  |
| BNT3814  | Key Washer                | BNT4709  | Right Side Plate          | BNT4747  | BR Dial Gear             |
| BNT3816  | Anti-Reverse Ratchet      | BNT4710  | Roller Clutch Inner Tube  | BNT4748  | Idle Gear                |
| BNT3825  | Screw                     | BNT4711  | Drive Gear                | BNT4749  | Left Side Plate          |
| BNT3918  | Washer                    | BNT4712  | Drive Shaft               |          |                          |
| BNT3927  | Ball Bearing              | BNT4713  | Drive Shaft Retainer      | BNT3660  | Reel Wrench (accessory)  |
| BNT3936  | Click Spring              | BNT4714  | Ball Bearing              | BNT4692  | B-100 Oil (accessory)    |
| BNT3937  | Click Pin                 | BNT4715  | Worm Bushing A            | BNT4750  | Brake Shoe S (accessory) |