

# SKP 2000C

For Parts and Service  
 Call 1-888-404-1119  
 www.mikesreelrepair.com

SKP 2000C

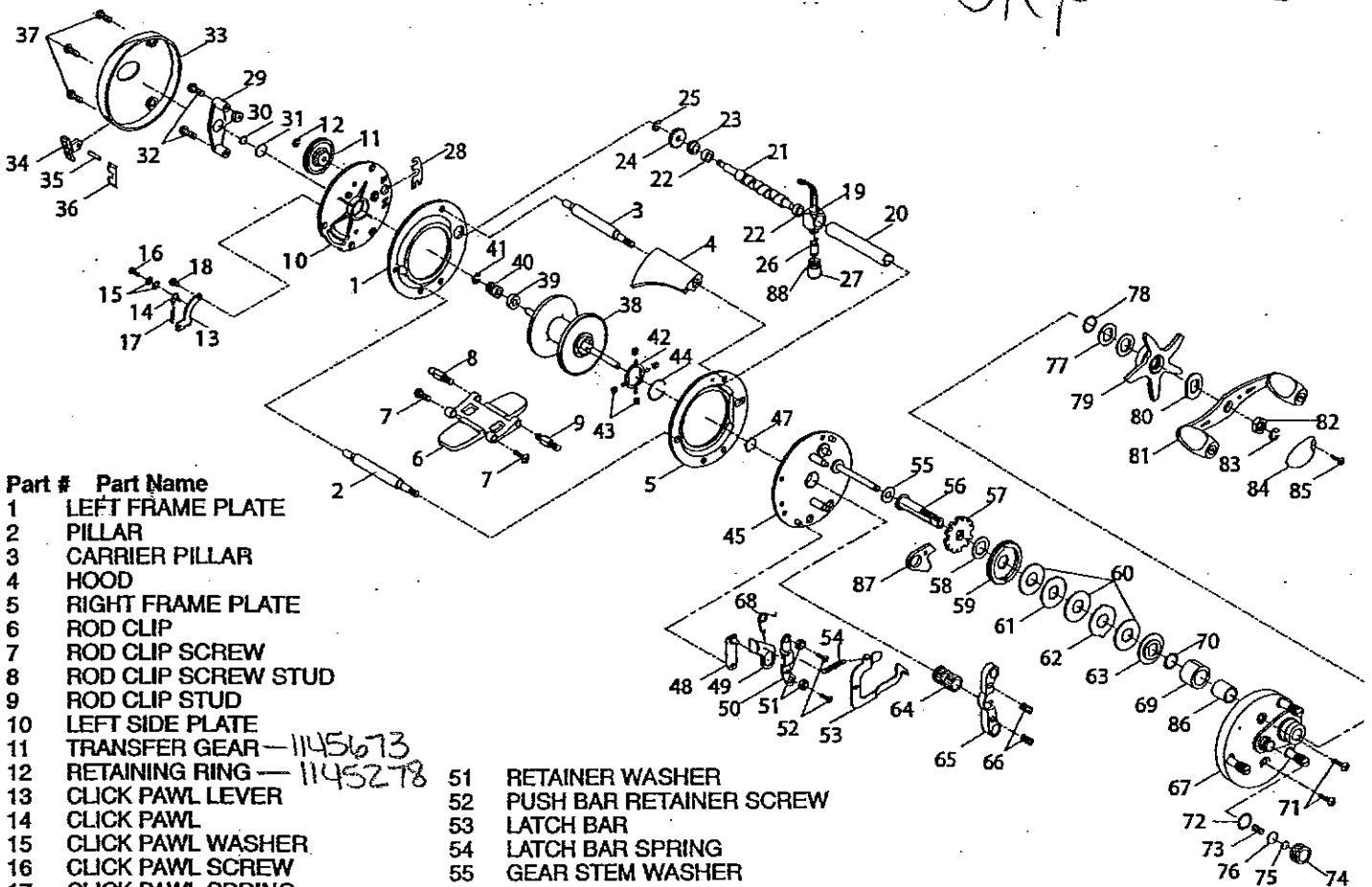

**Part # Part Name**

- |                            |                                |
|----------------------------|--------------------------------|
| 1 LEFT FRAME PLATE         | 51 RETAINER WASHER             |
| 2 PILLAR                   | 52 PUSH BAR RETAINER SCREW     |
| 3 CARRIER PILLAR           | 53 LATCH BAR                   |
| 4 HOOD                     | 54 LATCH BAR SPRING            |
| 5 RIGHT FRAME PLATE        | 55 GEAR STEM WASHER            |
| 6 ROD CLIP                 | 56 GEAR STEM                   |
| 7 ROD CLIP SCREW           | 57 RATCHET                     |
| 8 ROD CLIP SCREW STUD      | 58 FRICTION WASHER (SMALL)     |
| 9 ROD CLIP STUD            | 59 DRIVE GEAR                  |
| 10 LEFT SIDE PLATE         | 60 FRICTION WASHER (LARGE)     |
| 11 TRANSFER GEAR—1145673   | 61 KEYED DRAG WASHER           |
| 12 RETAINING RING—1145278  | 62 EARED WASHER                |
| 13 CLICK PAWL LEVER        | 63 DRAG WASHER                 |
| 14 CLICK PAWL              | 64 PINION                      |
| 15 CLICK PAWL WASHER       | 65 PINION YOKE                 |
| 16 CLICK PAWL SCREW        | 66 PINION YOKE SPRING          |
| 17 CLICK PAWL SPRING       | 67 RIGHT COVER ASSEMBLY        |
| 18 CLICK LEVER SCREW       | 68 OFF SPRING                  |
| 19 LINE GUIDE CARRIER      | 69 BEARING ASSEMBLY—1145068    |
| 20 CARRIER GUIDE           | 70 TEFLON WASHER               |
| 21 SHUTTLE SCREW           | 71 RIGHT COVER SCREW—1146219   |
| 22 SHUTTLE SCREW BUSHING   | 72 O RING                      |
| 23 SHUTTLE SCREW RING      | 73 TENSION KNOB SPRING—1146775 |
| 24 SHUTTLE GEAR—1145675    | 74 TENSION KNOB—1146941        |
| 25 RETAINING RING—1145278  | 75 RUBBER WASHER               |
| 26 LINE GUIDE PAWL—1145923 | 76 TENSION KNOB SPACER         |
| 27 PAWL COVER—1145239      | 77 SPRING D WASHER             |
| 28 CARRIER GUIDE RETAINER  | 78 WASHER                      |
| 29 SPOOL COVER             | 79 STAR DRAG                   |
| 30 RUBBER WASHER           | 80 CRANK SPRING WASHER—1146858 |
| 31 SPOOL SHIM              | 81 CRANK ARM—1145467           |
| 32 SPOOL SHIM HOLDER SCREW | 82 CRANK NUT                   |
| 33 LEFT COVER              | 83 RETAINING RING—1145281      |
| 34 BAIT CLICK BUTTON       | 84 CRANK NUT LOCK CAP          |
| 35 SPRING PIN              | 85 LOCK CAP SCREW—1146219      |
| 36 B-CCLICK BUTTON SPRING  | 86 SPACER                      |
| 37 LEFT COVER SCREW        | 87 N-R PAWL                    |
| 38 SPOOL                   | 88 PAWL WASHER—1146818         |
| 39 SPOOL BEARING           |                                |
| 40 SPOOL GEAR              |                                |
| 41 RETAINING RING—1145278  |                                |
| 42 BRAKE MOUNTING          |                                |
| 43 BRAKE SHOES             |                                |
| 44 LOCK RING               |                                |
| 45 RIGHT SIDE PLATE        |                                |
| 47 BEARING LOCK SPRING     |                                |
| 48 PILOT LEVER             |                                |
| 49 PUSH BAR                |                                |
| 50 PUSH BAR RETAINER       |                                |