

Prius BC Bailcast Reel

500

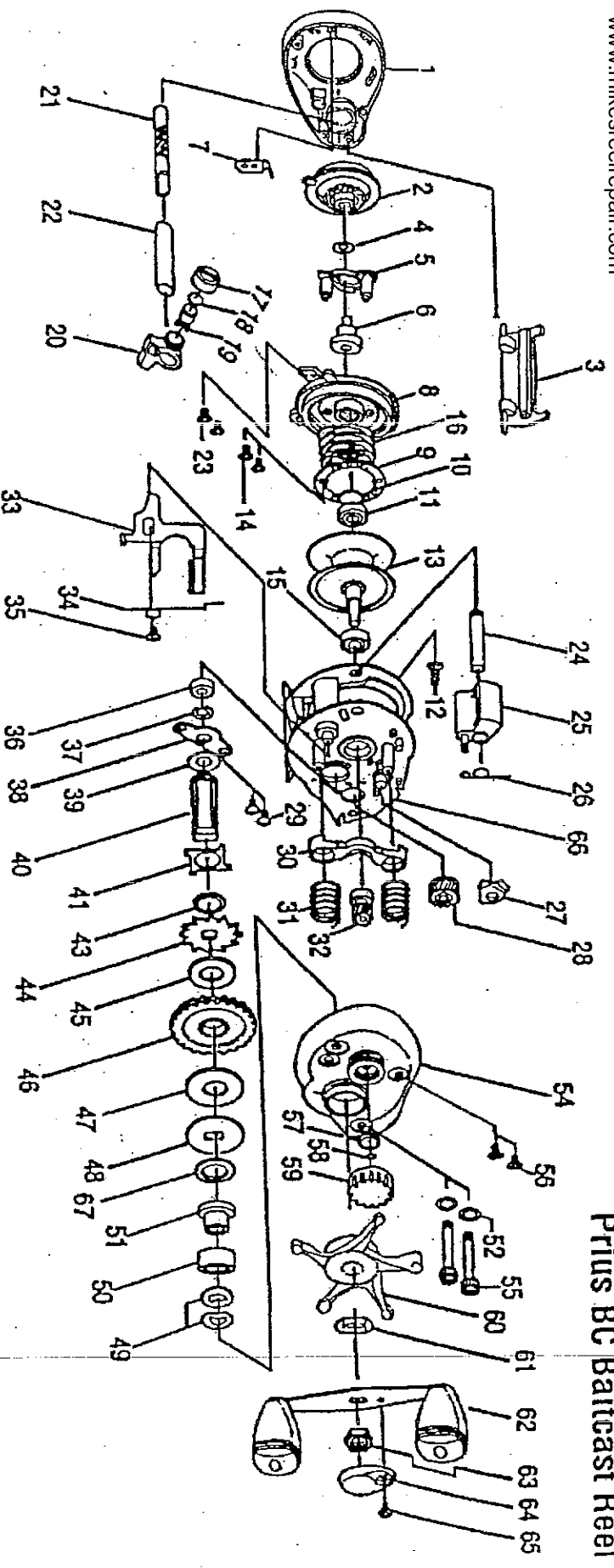

- | | | |
|------------------------------|-------------------------------|--------------------------------|
| 1 Left Side Cover | 20 Level Wind Assembly | 37 Crank Shaft E-Ring |
| 2 Magnetic Control Dial | 21 Worm Shaft | 38 Crank Shaft Retainer |
| 3 Level Wind Cover | 22 Pipe | 39 Crank Shaft Washer |
| 4 O Ring | 23 Screw | 40 Crank Shaft |
| 5 Slider Cam A | 24 Thumb Bar Pin | 41 Trip Ratchet |
| 6 Slider Cam B | 25 Thumb Bar Assembly | 43 Ratchet Washer |
| 7 Click Claw | 26 Thumb Bar Spring | 44 Anti-Reverse Ratchet |
| 8 Spool Cover | 27 Anti-Reverse Pawl Assembly | 45 Drive Gear Washer |
| 9 Magnetic Plate Assembly | 28 Level Wind Gear | 46 Drive gear |
| 10 Spool Tension Shim Washer | 29 Crank Shaft Retainer Screw | 47 Drive Disc |
| 11 Bearing | 30 Pinion Yoke | 48 Drag "D" Washer |
| 12 Screw | 31 Pinion Yoke Spring | 49 Spring Washer |
| 13 Spool Assembly | 32 Pinion Gear | 50 Ball Bearing—1145103 |
| 14 Magnetic Plate Screw | 33 Slide Plate | 51 Bushing |
| 15 Bearing | 34 Slide Plate Spring | 52 O Ring |
| 16 Coil Spring | 35 Screw | 54 Right Side Cover |
| 17 Level Wind Nut | 36 Crank Shaft Bushing | 55 Thumb Screw |
| 18 Level Wind Pin Washer | | 56 Right Cover Screw |
| 19 Level Wind Pin | | 57 Tension Knob O Ring—1146073 |
| | | 58 Tension Knob Washer—1146842 |
| | | 59 Tension Knob—1145214 |
| | | 60 Star Drag |
| | | 61 Handle Washer |
| | | 62 Handle Assembly |
| | | 63 Handle Nut—1145790 |
| | | 64 Handle Nut Cover |
| | | 65 Handle Nut Cap |
| | | 66 Frame |
| | | 67 Washer |

57 Thru 59 Tension Knob Assy
 1146962