

### SPECIFICATIONS :

Medium Light Freshwater  
 120 yds / 8 lb Line Capacity  
 5.8:1 Gear Ratio  
 10.8 oz.  
 Bearings:

E7-4 - 6 BB; 1 RB  
 E5-4 - 4 BB; 1 RB  
 E3-4 - 2 BB; 1 RB  
 E2-4 - 1 BB; 1 RB

### FEATURES :

Front Drag  
 Tru-Balanced Rotor  
 Balanced Handle  
 Twist Reducer Line Roller  
 Selective Continuous A/R  
 Worm Gear Oscillation  
 Spare Alum. Spool (E7-4 / E7-4A)  
 Alum. Spool ("A" models w/ holes in skirt)  
 Color:

E7-4 - Light Silver  
 E7-4A - Medium Brown  
 E5-4 - Cream  
 E5-4A - White  
 E3-4 - Dark Grey  
 E2-4 - Black

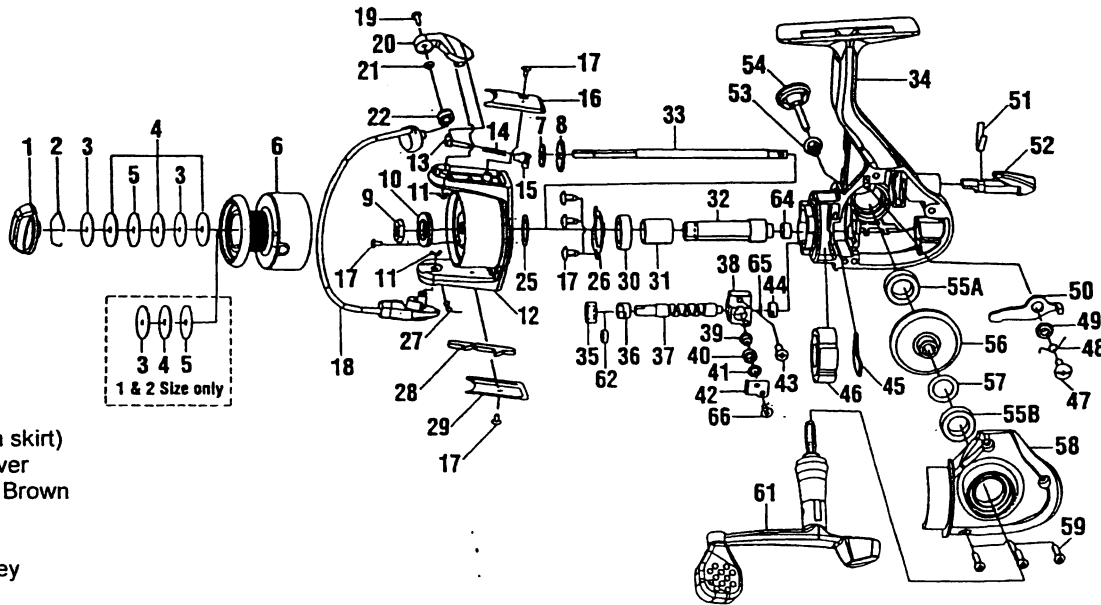

| Key No. | E7-4 / A | E5-4 / A  | E3-4     | E2-4     | Description         | Price | Key No. | E7-4 / A | E5-4 / A  | E3-4     | E2-4     | Description          | Price |
|---------|----------|---|----------|----------|---------------------|-------|---------|----------|---|----------|----------|----------------------|-------|
| 1       | GH332-02 | GH332-01  | GH332-02 | GH332-03 | Drag Knob           | 2.97  | 34      | GH301-04 | GH301-01  | GH301-02 | GH301-03 | Body Assy.           | 13.   |
| 1 ▽     | GH332-11 | GH332-10  |          |          | Drag Knob           | 2.97  | 34 ▽    | GH301-08 | GH301-07  | N/A      | N/A      | Body Assy.           | 13.   |
| 2       | AQ038-01 |   | ←        | ←        | Drag Retainer       | 0.32  | 35      | GH200-01 | ←   | ←        | ←        | Level Wind Gear      | 1.7   |
| 3       | TU080-01 | ←   | ←        | ←        | Drag Washer "D"     | 1.16  | 36      | N/A      | TU202-01  | ←        | ←        | Wm Shft Bushng (L)   | 0.5   |
| 4       | GH033-01 | ←   | ←        | ←        | Drag Washer "B"     | 2.68  | 36      | GH202-01 | N/A   | N/A      | N/A      | Wm Shft Bearing (L)  | 7.6   |
| 5       | TU081-01 | ←   | ←        | ←        | Drag Washer "A"     | 1.16  | 37      | TU201-01 | ←   | ←        | ←        | Worm Shaft           | 2.4   |
| 6       | GH321-04 | GH321-01  | GH321-02 | GH321-03 | Spool Asy.          | 7.21  | 38 Δ    | GH204-01 | ←   | ←        | ←        | Pawl Holder          | 3.2   |
| 6 ▽     | GH321-10 | ←   | N/A      | N/A      | Spool Asy.          | 7.21  | 39      | TU207-01 | ←   | ←        | ←        | Pawl                 | 2.5   |
| 7       | TU030-01 | ←   | ←        | ←        | Click Gear Washer   | 0.96  | 40      | UQ208-03 | ←   | ←        | ←        | Pawl Collar          | 0.2   |
| 8       | TU037-01 | ←   | ←        | ←        | Click Gear Washer   | 1.22  | 41 Δ    | RU209-01 | ←   | ←        | ←        | Pawl Washer          | 0.2   |
| 9       | RU006-01 | ←   | ←        | ←        | Rotor Nut           | 0.93  | 42 Δ    | FH205-01 | ←   | ←        | ←        | Pawl Holder Retainer | 1.0   |
| 10      | TL065-01 | ←   | ←        | ←        | Rotor "D" Washer    | 1.16  | 43      | UQ100-03 | ←   | ←        | ←        | Main Shaft Screw     | 0.4   |
| 11      | GH034-01 | ←   | ←        | ←        | E-Clip              | 0.32  | 44      | N/A      | GH203-01  | ←        | ←        | Wm Shft Bushng (Rt)  | 0.2   |
| 12      | GH009-04 | GH009-01  | GH009-02 | GH009-03 | Rotor               | 7.85  | 44      | GH202-02 | N/A   | N/A      | N/A      | Wm Shft Bearing (Rt) | 7.6   |
| 12 ▽    | GH009-12 | GH009-11  | N/A      | N/A      | Rotor               | 7.85  | 45      | TU206-01 | ←   | ←        | ←        | Worm Shaft Retainer  | 1.0   |
| 13      | QL031-01 | ←   | ←        | ←        | Bail Spring Shaft   | 0.27  | ▲ 46    | GH074-01 | ←   | ←        | ←        | Clutch Bearing       | 11.   |
| 14      | KQ049-05 | ←   | ←        | ←        | Bail Spring         | 0.32  | 46      | RU074-01 | → → → Use GH074-01 (clutch bearing) & TU052-01 (bearing sleeve) |          |          |                      |       |
| 15      | QL020-01 | ←   | ←        | ←        | Bail Spring Holder  | 0.32  | 47      | GH077-01 | ←   | ←        | ←        | A/R Pawl Screw       | 0.2   |
| 16      | GH087-04 | GH087-01  | GH087-02 | GH087-03 | Arm Lvr Spring Cvr  | 2.67  | 48      | TU061-01 | ←   | ←        | ←        | A/R Pawl Spring      | 0.2   |
| 16 ▽    | GH087-11 | GH087-10  | N/A      | N/A      | Arm Lvr Spring Cvr  | 2.67  | 49      | TU091-01 | ←   | ←        | ←        | A/R Pawl Post        | 1.2   |
| 17A     | UQ057-01 | ←   | ←        | ←        | Screw               | 0.32  | 50      | RU063-01 | ←   | ←        | ←        | A/R Pawl             | 1.2   |
| 17B     | UQ057-03 | ←   | N/A      | N/A      | Screw               | 0.32  | 51      | GH089-01 | ←   | ←        | ←        | A/R Lever Spring     | 1.2   |
| 18      | GH347-04 | GH347-01  | GH347-02 | GH347-03 | Bail Assy.          | 3.92  | 52      | GH090-03 | ←   | GH090-02 | ←        | A/R Lever            | 2.2   |
| 18 ▽    | GH347-13 | GH347-12  | N/A      | N/A      | Bail Assy.          | 3.92  | 52 ▽    | GH090-05 | GH090-04  | N/A      | N/A      | A/R Lever            | 2.2   |
| 19      | AQ108-01 | ←   | ←        | ←        | Line Slider Screw   | 0.31  | 53      | RU105-01 | ←   | ←        | ←        | Handle Cap Washer    | 0.2   |
| 20      | GH007-04 | GH007-01  | GH007-02 | GH007-03 | Arm Lever           | 2.39  | 54      | ZQ073-01 | ←   | ←        | ←        | Handle Cap Screw     | 1.2   |
| 20 ▽    | GH007-12 | GH007-11  | N/A      | N/A      | Arm Lever           | 2.39  | 55A     | BL157-01 | ←   | N/A      | N/A      | Ball Bearing (Body)  | 5.2   |
| 21      | GU105-25 | ←   | ←        | ←        | Line Roller Washer  | 0.32  | 55A     | N/A      | N/A   | GH013-01 | ←        | Bushing (Body)       | 1.0   |
| 22      | TU004-02 | ←   | N/A      | N/A      | L/Roller w/Bearing  | 6.90  | 55B     | BL157-01 | ←   | ←        | N/A      | B. Brng (Body Cvr)   | 5.2   |
| 23      | N/A      | N/A   | GH016-01 | ←        | Line Roller Bushing | 1.16  | 55B     | N/A      | N/A   | N/A      | GH013-01 | Bushing (Body Cvr)   | 1.0   |
| 24      | N/A      | N/A   | GH004-02 | ←        | Line Roller         | 4.69  | 56      | GH012-01 | ←   | ←        | ←        | Drive Gear           | 1.2   |
| 25      | GU105-12 | ←   | ←        | ←        | Rotor Washer        | 0.32  | 57      | GU105-13 | ←   | ←        | ←        | Adjust Washer        | 0.1   |
| 26      | TU040-02 | ←   | ←        | ←        | Bearing Plate       | —     | 58      | GH023-04 | GH023-01  | GH023-02 | GH023-03 | Side Cover           | 5.4   |
| 27      | GH049-01 | ←   | ←        | ←        | Kick Lever Spring   | 0.32  | 58 ▽    | GH023-08 | GH023-07  | N/A      | N/A      | Side Cover           | 5.4   |
| 28      | GH019-01 | ←   | ←        | ←        | Kick Lever          | 1.11  | 59      | KQ057-01 | ←   | ←        | ←        | Side Cover Screws    | 0.2   |
| 29      | GH024-04 | GH024-01  | GH024-02 | GH024-03 | Kick Lever Cover    | 2.76  | 59 ▽    | KQ057-03 | ←   | N/A      | N/A      | Side Cover Screws    | 0.2   |
| 29 ▽    | GH024-12 | GH024-11  | N/A      | N/A      | Kick Lever Cover    | 2.76  | 61      | GH318-03 | GH318-01  | GH318-02 | GH318-03 | Handle Asy.          | 11.   |
| 30      | UK028-01 | ←   | ←        | ←        | Pinion Ball Bearing | 5.57  | 61 ▽    | GH318-07 | GH318-06  | N/A      | N/A      | Handle Asy.          | 11.   |
| ▲ 31    | TU052-01 | → → → Use TU052-01 (bearing sleeve) & GH074-01 (clutch bearing) | ←        | ←        | Bearing Sleeve      | 2.76  | 62      | GH212-01 | N/A   | N/A      | N/A      | Worm Shaft Collar    | 1.2   |
| 31      | RU139-01 | → → → Use TU052-01 (bearing sleeve) & GH074-01 (clutch bearing) | ←        | ←        | Bearing Sleeve      | 2.76  | 64      | RU141-01 | ←   | ←        | ←        | Pinion Bushing       | 1.0   |
| 32      | GH011-01 | ←   | ←        | ←        | Pinion Gear         | 3.55  | 65      | GU105-31 | ←   | ←        | ←        | Worm Shaft Washer    | 0.2   |
| 33      | TU015-01 | ←   | TU015-02 | ←        | Main Shaft          | 2.60  | 66 Δ    | GH123-01 | ←   | ←        | ←        | Plate Screw          | 0.2   |

▽ = Special parts for E7-4A and E5-4A.

Δ = Send Key No.'s 38, 41, 42, and 66 if any of these are ordered.

□ = Send Key No.'s 53, 54, and 61 if either part is ordered.

▲ = Both parts must be shipped together if either one is ordered.