

QUANTUM®

Indicator ID20LC

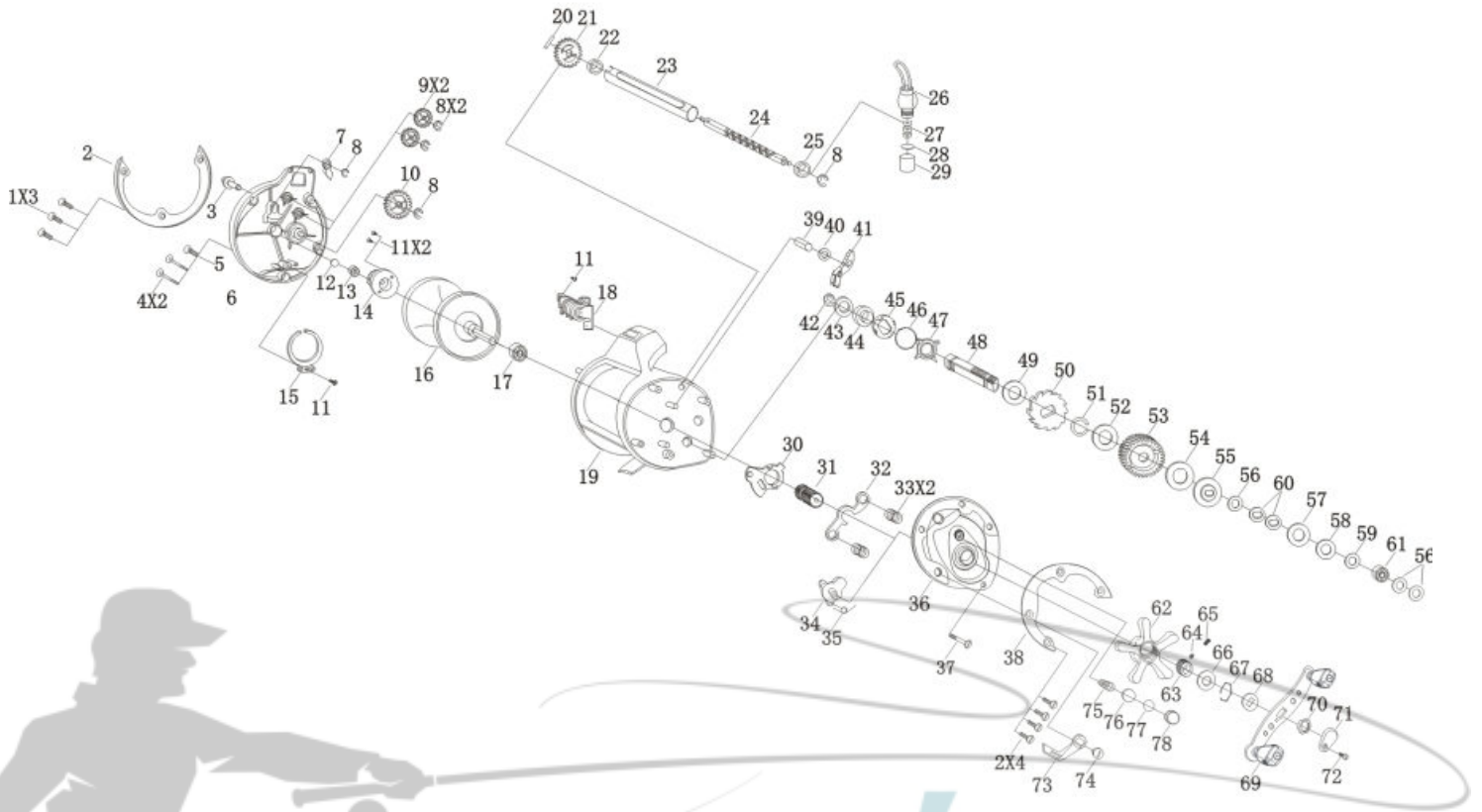

Quantum Line Counter ID20LC Trolling Reel Part List

Key #	Description	Part No.		Key #	Description	Part No.	
		ID20LC				ID20LC	
1	Side Cover Screw - A	RI123-01		40	Anti Reverse Pawl Washer	RI081-01	
2	Palm Side Cover Metal Ring	RI113-01		41	Anti reverse Pawl Assembly	RI363-01	
3	Bait Click Lever	EI109-01		42	E-Clip	QW120-01	
4	Side Cover Screw - C	RI050-01		43	Washer	FI035-01	
5	Side Cover Screw - D	RI076-01		44	Crank Shaft Bushing	EI117-01	
6	Palm Side Cover	RI024-01		45	Trip Ratchet	EI038-01	
7	Bait Click Pawl	EI114-01		46	Trip Ratchet Spring	EI097-01	
8	E-Clip	NE092-01		47	Trip Ratchet Spring Holder	EI103-01	
9	Idle Gear	RI127-01		48	Crank Shaft	RI008-01	
10	Oscillate Pinion Gear	RI152-01		49	Anti Reverse Washer	RI111-01	
11	Screw	WW107-01		50	Anti Reverse Ratchet - A	FI083-01	
12	Spool Shaft Washer	EI035-01		51	C-Clip	RI075-01	
13	Bushing	EI017-01		52	Anti Reverse Ratchet Washer	RI059-01	
14	Oscillate Drive Gear	RI112-01		53	Drive Gear	RI012-01	
15	Spring Clip	EI110-01		54	Drive Disc -A	RI048-01	
16	Spool Assembly	RI321-01		55	Drag "D" Washer - A	RI045-01	
17	Ball Bearing	GI017-01		56	Drag Key Washer	RI060-01	
18	Line Counter	RI155-01		57	Drag Disc "B"	RI038-01	
19	Frame Assembly	RI301-01		58	Drag "D" Washer - B	RI035-01	
20	Pin	RI093-01		59	Washer	RI126-01	
21	Oscillate Pinion Gear	RI085-01		60	Spring "D" Washer	EI046-01	
22	Worm Shaft Bushing A	RI067-01		61	Ball Bearing	RI058-01	
23	Worm Shaft Guide	RI016-01		62	Star Drag	RI055-01	
24	Worm Shaft	RI072-01		63	Click Ratchet	RI108-01	
25	Worm Shaft Bushing B	RI068-01		64	Click Pawl	RI103-01	
26	Line Guide Carrier Assembly	RI347-01		65	Click Spring	RI141-01	
27	Line Guide Pawl	EI006-01		66	Washer	RI121-01	
28	Line Guide Pawl Washer	BV035-04		67	Clip Ring	RI022-01	
29	Line Guide Pawl Washer Screw	EI007-01		68	Washer	RI046-01	
30	Release Slider	EI093-01		69	Handle Assembly	RI318-01	
31	Pinion Gear	RI011-01		70	Handle Nut	EI033-01	
32	Pinion Yoke	EI025-01		71	Handle Nut Cap	RI145-01	
33	Pinion Yoke Spring	EI040-01		72	Handle Screw	HI033-01	
34	Release Slider Cam	EI141-01		73	Release Lever	LI114-01	
35	Release Slider Cam Spring	EI104-01		74	Release Lever Screw	EI053-01	
36	Gear Side Cover Assembly	RI324-01		75	Tension Knob Spring	RI105-01	
37	Side Cover Screw - B	RI094-01		76	Spool Cushion Washer	EI082-01	
38	Gear Side Cover Metal Ring	RI159-01		77	Spool Tension Washer	EI032-01	
39	Anti Reverse Pawl Post	RI100-01		78	Spool Tension Knob	GI033-01	