

QUANTUM IR1F

SPECIFICATIONS:

Ultra Light Fresh Water
 110 yds/4 lb. Line Capacity
 5.3:1 Ratio
 6.4 oz. Weight
 4 Ball Bearings

FEATURES:

Forged-brass drive and pinion gear for maximum strength and wear
 Aluminum side plate for superior drive gear support
 Posi-Lok anti-reverse for reduced reverse slack and less reel shock
 Aluminum one-piece spool
 Corrosion-resistant, stainless-steel hardware
 4 ball-bearing, super-smooth operation
 Oversized drag system
 Ball-bearing line roller
 Balanced handle/rotor
 Ironside support system encases forged-brass gearing in a solid aluminum side cover for maximum strength and rigidity under load

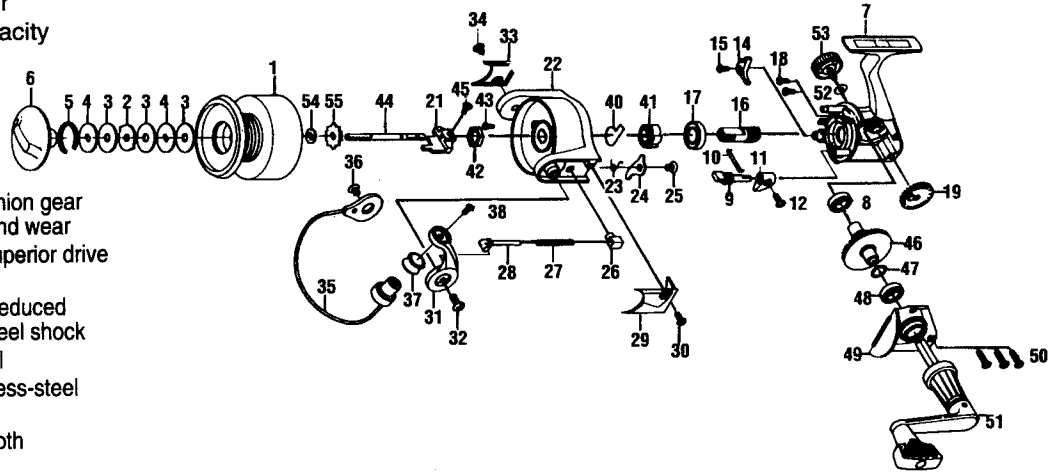

Key No.	Part No.	Description	Price	Key No.	Part No.	Description	Price
1	BH321-02	Spool Assembly	7.75	29	BH046-02	Arm Lever Cover	2.60
2	BH081-01	Spool Washer "A"	.55	30	BH085-14	Cover Screw	.60
3	BH033-11	Spool Washer "B"	.62	31	BH007-02	Arm Lever	3.00
4	BH080-01	Spool Washer "D"	.90	32	BH044-14	Arm Lever Screw	.60
5	BH038-11	Drag Retainer	.98	33	BH024-02	Bail Holder Cover	1.65
6	BH332-02	Drag Knob Assembly	3.15	34	BH085-14	Cover Screw	.60
7	BH001-02	Body	6.00	35	BH347-02	Bail Assembly	6.25
8	BH027-01	Ball Bearing	5.95	36	BH044-14	Bail Holder Screw	.60
9	BH090-11	Stopper Cam	1.55	37	BH004-02	Line Roller Ball Bearing	6.70
10	BH089-11	Stopper Cam Spring	.90	38	BH108-02	Bail Screw	.60
11	BH059-14	Stopper Lever	1.05	40	BH086-01	Silent Spring	1.55
12	BH135-13	Stopper Lever Screw	.62	41	BH060-02	Ratchet Gear	1.70
14	BH063-02	Stopper	1.45	42	BH006-01	Rotor Nut	1.15
15	BH077-01	Stopper Screw	.60	43	BH094-11	Rotor Nut Lock Screw	.62
16	BH011-01	Pinion Gear	3.15	44	BH015-01	Main Shaft	2.45
17	BH028-01	Ball Bearing	7.00	45	BH100-01	Main Shaft Screw	.60
18	BH041-11	Bearing Screw	.62	46	BH012-02	Driver Gear	5.20
19	BH053-01	O/S Gear	1.55	47	BH026-01	Adjust Washer	.65
21	BH025-01	O/S Slider	2.55	48	BH027-01	Ball Bearing	5.95
22	BH009-02	Rotor	6.50	49	BH023-02	Body Cover	5.00
23	BH049-01	Kick Lever Spring	.90	50	BH057-02	Body Cover Screw	.60
24	BH019-01	Kick Lever	1.85	51	BH318-02	Handle Assembly	7.25
25	BH136-01	Kick Lever Screw	.60	52	BH105-11	Handle Cap Washer	.46
26	BH020-11	Spring Holder	.93	53	BH073-13	Handle Screw Cap	2.85
27	BH022-01	Arm Lever Spring	.60	54	BH030-01	Click Gear Washer	.95
28	BH031-01	Spring Shaft	.90	55	BH037-01	Click Gear	.25

MODEL INTRODUCED	1997	EFFECTIVE DATE OF PARTS LIST/DIAGRAM	Sept. 1996	DISCONTINUED	N/A
-------------------------	------	---	------------	---------------------	-----

Prices subject to change without notice. Prices do not include postage and handling.

PLEASE ORDER BY PART NUMBER Zebco Division Brunswick Corporation, Box 270, Tulsa, OK 74101 USA 918-831-6965

