

# QUANTUM<sup>®</sup>

## Catalyst Inshore

### CI40PTs

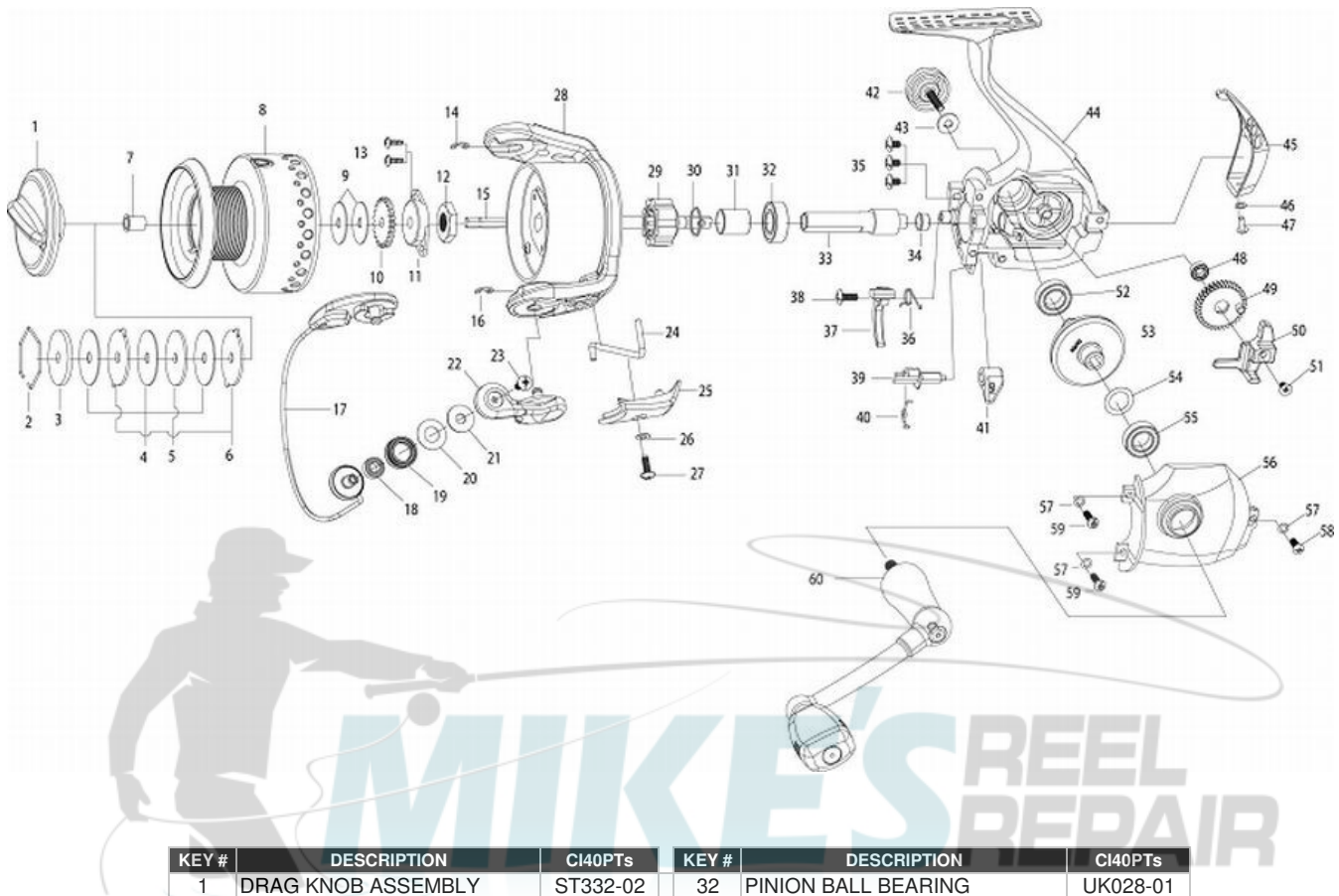

KEY #	DESCRIPTION	CI40PTs	KEY #	DESCRIPTION	CI40PTs
1	DRAG KNOB ASSEMBLY	ST332-02	32	PINION BALL BEARING	UK028-01
2	DRAG RETAINER	RQ038-01	33	PINION GEAR	SQ011-01
3	DRAG WASHER "D"	SQ080-01	34	PINION BUSHING	SQ141-01
4	DRAG WASHER "B"	RQ033-01	35	BEARING SCREW	RQ041-01
5	DRAG WASHER "D"	RQ080-01	36	ANTI REVERSE PAWL SPRING	RQ061-01
6	DRAG WASHER "A"	RQ081-01	37	ANTI-REVERSE PAWL	SQ063-01
7	SPOOL SLEEVE	TQ160-01	38	ANTI-REVERSE PAWL SCREW	RQ077-01
8	SPOOL ASSEMBLY	TQ321-53	39	ANTI REVERSE CAM	RQ090-01
9	SPOOL WASHER	RQ030-01	40	ANTI REVERSE CAM SPRING	RQ089-01
10	CLICK GEAR	RQ037-01	41	ANTI REVERSE LEVER	RQ059-01
11	MAIN SHAFT BUSHING	SQ214-01	42	HANDLE CAP SCREW ASSY	AT373-01
12	ROTOR NUT	TH006-01	43	HANDLE SCREW WASHER	AT029-01
13	ROTOR NUT LOCK SCREW	RQ094-01	44	BODY ASSEMBLY	SQ301-56
14	E-CLIP	GH034-01	45	BODY REAR COVER	SQ140-51
15	MAIN SHAFT	TQ015-01	46	BODY REAR COVER WASHER	RQ142-01
16	E-CLIP	GH034-01	47	BODY REAR COVER SCREW	RQ062-01
17	BAIL ASSEMBLY	TQ347-51	48	O/S GEAR BUSHING	N/A
18	LINE ROLLER BUSHING	N/A	48	O/S GEAR BALL BEARING	EH158-01
18	LINE ROLLER BEARING	GH202-01	49	OSCILLATOR GEAR	TQ053-51
19	LINE ROLLER	CH004-04	50	OSCILLATOR SLIDER	SQ025-01
20	LINE ROLLER WASHER	DH102-01	51	MAIN SHAFT SCREW	RQ100-01
21	LINE ROLLER COLLAR	CH102-01	52	GEAR SHAFT BALL BEARING	BL157-01
22	ARM LEVER ASSEMBLY	SQ307-02	53	DRIVE GEAR ASSY	RT312-01
23	LINE SLIDER SCREW	AQ108-01	54	ADJUST WASHER	GU105-13
24	KICK LEVER	TQ019-01	55	GEAR SHAFT BALL BEARING	BL157-01
25	ARM LEVER COVER	TQ087-01	56	BODY COVER	SQ023-56
26	ARM LEVER COVER WASHER	SQ142-01	57	BODY COVER SCREW WASHER	RQ142-01
27	ARM LEVER COVER SCREW	GU077-15	58	BODY COVER SCREW	SQ057-01
28	ROTOR ASSEMBLY	TQ309-52	59	BODY COVER SCREW	RQ057-01
29	CLUTCH ASSEMBLY	SQ360-01	60	HANDLE ASSEMBLY	RT318-02
30	CLUTCH WASHER	RQ167-01	61	CAM SPRING SCREW	N/A
31	CLUTCH SLEEVE	SQ139-01			