

# QUANTUM<sup>®</sup>

## BSP60PTSB

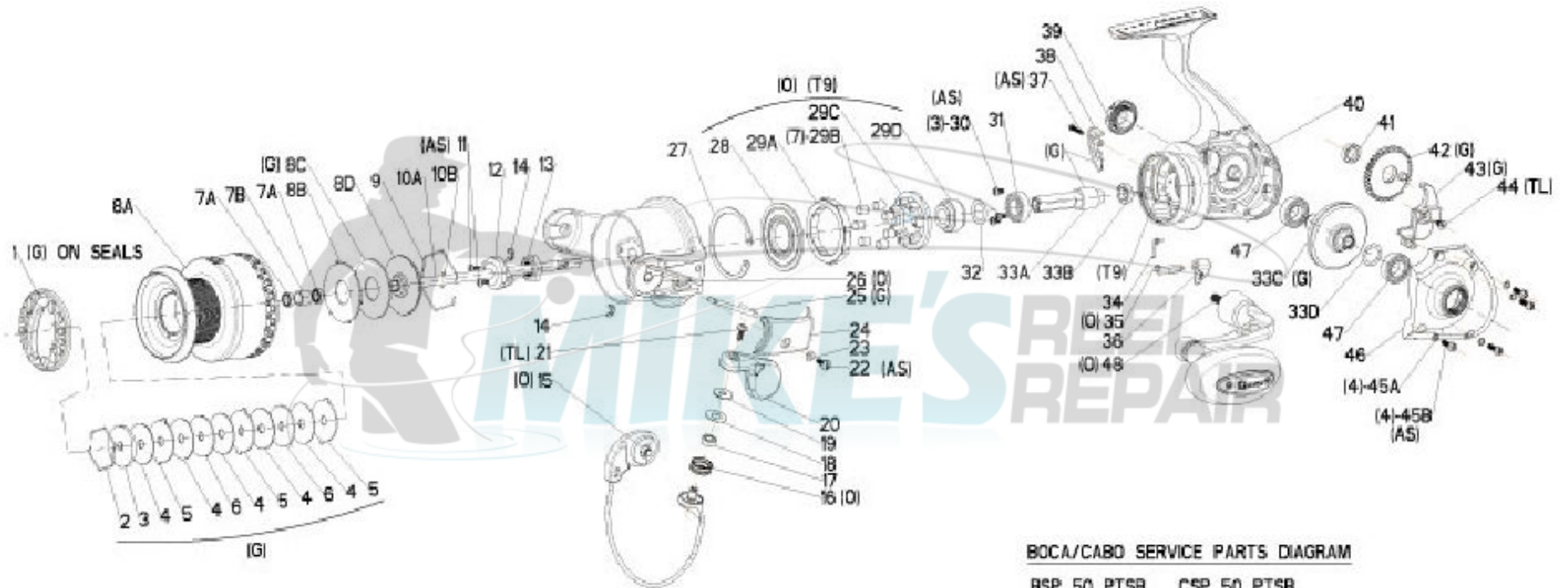

### BOCA/CABO SERVICE PARTS DIAGRAM

BSP 50 PTSB    CSP 50 PTSB  
 BSP 60 PTSB    CSP 60 PTSB

(O) = OIL - HOT SAUCE  
 (G) = GREASE - HOT SAUCE  
 (AS) = ANTI-SEIZE (ON SCREW THREADS)  
 (TL) = THREAD LOCKING COMPOUND (ON SCREW THREADS)  
 (T) = ANTI-CORROSION LUBRICANT

# QUANTUM®

## BSP60PTSB

### Quantum BSP60PTsB Spinning Reel Part List

Key #	Description	Part No.	Key #	Description	Part No.
1	DRAG KNOB ASSEMBLY	BT332-01	23	ARM LEVER COVER WASHER	SQ142-01
2	SPOOL RETAINER - TOP	BT038-02	24	ARM LEVER COVER	BT087-01
3	DRAG WASHER "C"	CT080-01	25	KICK LEVER	BT019-01
4	DRAG WASHER "B" - FRICTION	BT033-01	26	ROTOR ASSEMBLY	BT309-02
5	DRAG WASHER "D"	BT081-01	27	RETAINER RING - CLUTCH SEAL	DT160-01
6	DRAG WASHER "A"	BT080-01	28	CLUTCH SEAL	QAA166-01
7	SPOOL BUSHING OR BEARING KIT	BT4160-01	29	CLUTCH ASSEMBLY KIT	QAA4363-01
	7A - SPOOL BUSHING OR BEARING	N/A		29A - CLUTCH LOCK RING	N/A
	7B - SPOOL SPACER	N/A		29B - CLUTCH ROLLER (7)	N/A
8	SPOOL ASSEMBLY KIT	CT4321-01		29C - CLUTCH RETAINER	N/A
	8A - SPOOL ASSEMBLY	N/A		29D - CLUTCH SLEEVE	N/A
	2 - SPOOL RETAINER - TOP	N/A	30	SCREW (3)	TK057-01
	3 - DRAG WASHER "C"	N/A	31	PINION BALL BEARING	BT157-01
	4 - DRAG WASHER "B" (5) - FRICTION	N/A	32	PINION GEAR WASHER	BT110-01
	5 - DRAG WASHER "D" (3)	N/A	33	GEAR KIT	BT4011-01
	6 - DRAG WASHER "A" (2)	N/A		33A - PINION GEAR	N/A
	7 - SPOOL BUSHING OR BEARING KIT	N/A		33B - PINION BUSHING/BEARING	N/A
	8B - SPOOL WASHER	N/A		33C - DRIVE GEAR ASSEMBLY	N/A
	8C - DRAG WASHER "E"	N/A		33D - D.GEAR ADJUST WASHER	N/A
	8D - DRAG CLICK ASSEMBLY	N/A	34	A/R CAM SPRING	TK089-01
	9 - SPOOL RETAINER - BOTTOM	N/A	35	A/R CAM	BT090-01
9	SPOOL RETAINER - BOTTOM	BT038-01	36	A/R LEVER	RQ059-01
10	MAIN SHAFT KIT	BT4015-01	37	TRIP RAMP SCREW	BT136-01
	10A - MAIN SHAFT	N/A	38	TRIP RAMP	CT243-01
	10B - MAIN SHAFT PIN	N/A	39	HANDLE COVER - DUST CAP	BT373-01
11	ROTOR NUT LOCK SCREW	RQ094-01	40	BODY ASSEMBLY	BT301-04
12	MAIN SHAFT BUSHING	BT214-01	41	O/S GEAR BUSHING OR BEARING	BT158-01
13	ROTOR NUT	BT006-01	42	O/S GEAR	BT053-01
14	E-CLIP - BAIL ASSEMBLY	GH034-01	43	O/S SLIDER	BT025-01
15	BAIL ASSEMBLY	BT347-02	44	MAIN SHAFT SCREW	RQ100-01
16	LINE ROLLER	CH004-02	45	BODY COVER SCREW KIT	AT4057-02
17	LINE ROLLER BEARING	GH202-01		45A - SCRATCH PROTECT WASHER (4)	N/A
18	SPACER	DH102-01		45B - BODY COVER SCREW (4)	N/A
19	LINE ROLLER WASHER	CH102-01	46	BODY COVER	BT023-02
20	ARM LEVER ASSEMBLY	BT407-03	47	BODY BALL BEARING	BT157-01
21	SCREW - LINE SLIDER	AQ108-01	48	HANDLE ASSY	BT318-03
22	A/L COVER SCREW	GU077-02			