



BR140 / BR340 / BR340A

SPECIFICATIONS :

M FW / Lt SW
 200 yds / 10 lb Line Capacity
 Ball Bearings:
 BR140 - 1 B.B.
 BR340 / BR340A - 3 B.B.
 5.7:1 Gear Ratio
 11.6 oz.

FEATURES :

Front Drag
 Balanced Rotor
 Oversized Twist Reducer Line Roller
 POSI-Loc Selective Anti-Reverse (15 stop)
 Aluminum Long Stroke Max-Cast Spool
 Color: BR140 / 340 - Light Tan
 BR340A - Dark Grey

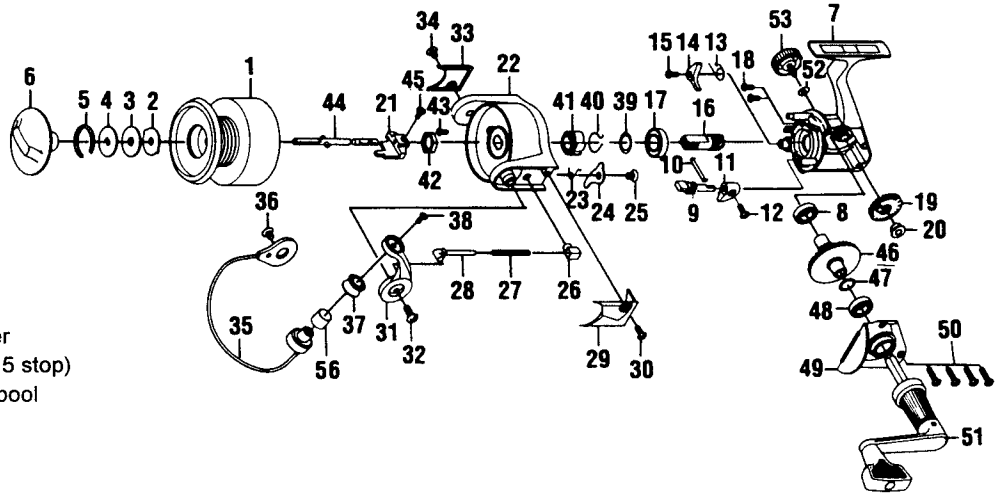

| Key No. | Part No. | DESCRIPTION | Price | Key No. | Part No. | DESCRIPTION | Price | |
|---------|----------|------------------------------------|-------|---------|----------|----------------------------|---------|------|
| 1 | BH321-21 | Spool Assembly | 8.22 | 29 | N / A | Arm Lever Cover (BR340A) | 1.43 | |
| 1 | N / A | Spool Assembly (BR340A) | 8.22 | 30 | BH085-11 | Cover Screw | 0.64 | |
| 2 | BH081-21 | Spool Washer "A" | 0.59 | 30 | N / A | Cover Screw (BR340A) | 0.47 | |
| 3 | BH033-21 | Spool Washer "B" | 0.64 | 31 | BH007-12 | Arm Lever | 3.18 | |
| 4 | BH080-21 | Spool Washer "D" | 0.96 | 31 | N / A | Arm Lever (BR340A) | 2.44 | |
| 5 | BH038-21 | Drag Retainer | 1.01 | 32 | BH044-11 | Arm Lever Screw | 0.64 | |
| 6 | BH332-21 | Drag Knob Assembly | 3.29 | 32 | N / A | Arm Lever Screw (BR340A) | 0.44 | |
| 6 | N / A | Drag Knob Assembly (BR340A) | 3.29 | 33 | BH024-11 | Bail Holder Cover | 1.65 | |
| 7 | BH001-21 | Body (before A8 date code) | 5.57 | 33 | N / A | Bail Holder Cover (BR340A) | 0.84 | |
| 7 | BH001-18 | Body (after A8 date code) | 5.57 | 34 | BH085-11 | Cover Screw | 0.64 | |
| 7 | N / A | Body (BR340A) | 5.57 | 34 | N / A | Cover Screw (BR340A) | 0.47 | |
| 8 | BH027-11 | Bushing | 0.77 | 35 | BH347-22 | Bail Assembly | 5.73 | |
| 8 | N / A | Ball Bearing | 6.58 | 35 | N / A | Bail Assembly (BR340A) | 5.73 | |
| 9 | BH090-11 | Stopper Cam | 1.60 | 36 | BH044-11 | Bail Holder Screw | 0.64 | |
| 10 | BH089-11 | Stopper Cam Spring | 0.96 | 36 | N / A | Bail Holder Screw (BR340A) | 0.42 | |
| 11 | BH059-11 | Stopper Lever | 1.08 | 37 | BH004-12 | Line Roller | 3.19 | |
| 11 | N / A | Stopper Lever (BR340A) | 1.08 | 38 | BH108-11 | Bail Screw | 0.64 | |
| 12 | BH135-11 | Stopper Lever Screw | 0.64 | 38 | N / A | Bail Screw (BR340A) | 0.42 | |
| 12 | N / A | Stopper Lever Screw (BR340A) | 0.64 | 39 | BH110-11 | Bearing Washer | 0.54 | |
| 13 | BH061-11 | Stopper Spring | 0.46 | 40 | BH086-11 | Silent Spring | 1.65 | |
| 14 | BH063-12 | Stopper | 1.49 | 41 | BH060-12 | Ratchet Gear | 1.75 | |
| 15 | BH077-11 | Stopper Screw | 0.64 | 42 | BH006-11 | Rotor Nut | 1.11 | |
| 16 | BH011-13 | Pinion Gear (before A8 date code) | 2.76 | 43 | BH094-11 | Rotor Nut Lock Screw | 0.64 | |
| 16 | BH011-14 | Pinion Gear (after A8 & BR340A) | 2.76 | 44 | BH315-21 | Main Shaft Assembly | 5.73 | |
| 17 | BH028-11 | Ball Bearing (before A8 date code) | 8.70 | 45 | BH100-11 | Main Shaft Screw | 0.64 | |
| 17 | BH028-12 | Ball Bearing (after A8 & BR340A) | 8.70 | 46 | BH012-13 | Driver Gear | 2.49 | |
| 18 | BH041-11 | Bearing Screw | 0.64 | 47 | BH026-11 | Adjust Washer | 0.69 | |
| 19 | BH053-21 | O/S Gear | 1.53 | 48 | BH027-11 | N / A | Bushing | 0.77 |
| 20 | BH158-11 | O/S Gear Bushing | 0.98 | 48 | N / A | Ball Bearing | 6.58 | |
| 21 | BH025-11 | O/S Slider | 2.66 | 49 | BH023-21 | Body Cover | 3.45 | |
| 22 | BH009-21 | Rotor | 5.30 | 49 | N / A | Body Cover (BR340A) | 3.45 | |
| 22 | N / A | Rotor (BR340A) | 5.30 | 50 | BH057-11 | Body Cover Screw | 0.64 | |
| 23 | BH049-21 | Kick Lever Spring | 0.96 | 50 | N / A | Body Cover Screw (BR340A) | 0.42 | |
| 24 | BH019-21 | Kick Lever | 1.91 | 51 | BH318-11 | Handle Assembly | 6.37 | |
| 25 | BH136-11 | Kick Lever Screw | 0.64 | 51 | N / A | Handle Assembly (BR340A) | 6.37 | |
| 26 | BH020-11 | Spring Holder | 0.96 | 52 | BH105-11 | Handle Cap Washer | 0.47 | |
| 27 | BH022-21 | Arm Lever Spring | 0.64 | 53 | BH073-11 | Handle Screw Cap | 2.34 | |
| 28 | BH031-21 | Spring Shaft | 0.96 | 53 | N / A | Handle Screw Cap (BR340A) | 2.34 | |
| 29 | BH046-21 | Arm Lever Cover | 1.43 | 56 | BH016-11 | Line Roller Bushing | 1.06 | |

 = These parts are not interchangeable with parts from different date code (ie., use Pinion Gear before A8 along with Ball Bearing and Body before A8)

| | | |
|--------------------------|--------------------------------------|-----------------------------|
| MODEL | EFFECTIVE DATE OF | |
| INTRODUCED : 1997 | PARTS LIST/DIAGRAM: Sept. '98 | DISCONTINUED : N / A |

Prices subject to change without notice. Prices do not include postage and handling.

PLEASE ORDER BY PART NUMBER

Zebco, P.O. Box 270, Tulsa, Ok. 74101; 918-831-6965 Phone or 800-FIXREEL (349-7335) FAX

