

# QUANTUM

# BR180A/BR380A

### SPECIFICATIONS:

Heavy Saltwater  
 330 yds/20 lb Line Capacity  
 4.8:1 Gear Ratio  
 21.1 oz. Weight

**BR180A:** 1 Ball Bearing

**BR380A:** 3 Ball Bearing

### FEATURES:

Oversized Front Drag and Center Shaft  
 Right/Left Interchangeable Handle

Magnum Gears  
 Selective Anti-Reverse  
 Internal Bail Trip

Oversized "Twist Reducer" Line Roller

Aluminum Long Stroke

Color: BR180A - Light Tan  
 BR380B - Dark Grey

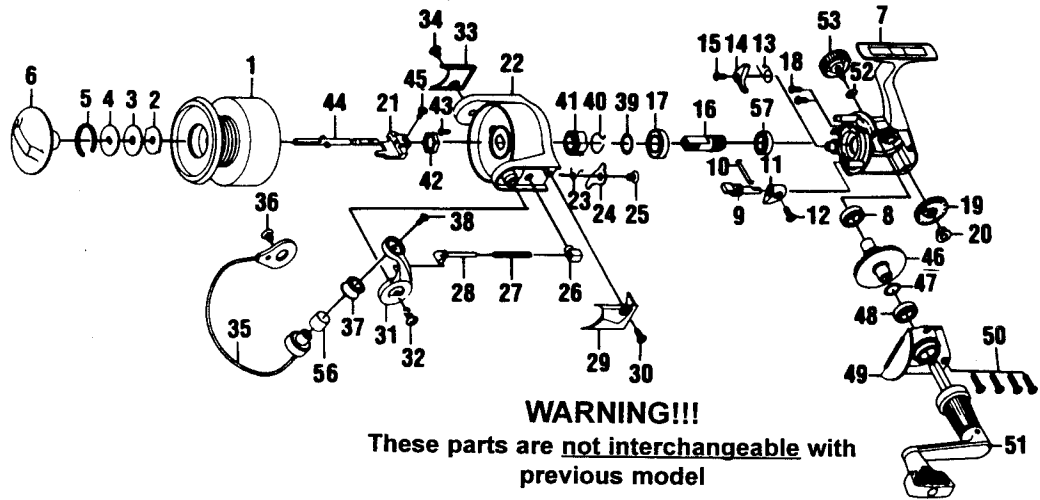

### Distinguishing Features:

The OLD model has an Anti-Reverse slide switch on the very back of reel. The NEW model has an Anti-Reverse lever on the bottom of reel just behind rotor.

### Special Handling Instructions:

If specific model version cannot be identified for parts order, send one of each part (for old and new model) and charge for one part.

Key No.	BR180A Part No.	BR380B Part No.	Description	Price	Key No.	BR180A Part No.	BR380B Part No.	Description	Price
1	BH321-72	BH321-73	Spool Assembly	11.89	29	BH046-72	BH046-73	Arm Lever Cover	1.03
2	BH081-21	BH081-21	Spool Washer "A"	.59	30	BH085-11	BH085-13	Cover Screw	.47
3	BH033-21	BH033-21	Spool Washer "B"	.64	31	BH007-62	BH007-61	Arm Lever	1.60
4	BH080-31	BH080-31	Spool Washer "D"	.96	32	BH044-11	BH044-13	Arm Lever Screw	.64
5	BH038-21	BH038-21	Drag Retainer	1.01	33	BH024-62	BH024-63	Bail Holder Cover	1.03
6	BH332-41	BH332-46	Drag Knob Assembly	3.34	34	BH085-11	BH085-13	Cover Screw	.64
7	BH001-62	BH001-63	Body	6.70	35	BH347-72	BH347-71	Bail Assembly	3.19
8	BH027-71	N/A	Body Bushing	.77	36	BH044-11	BH044-13	Bail Holder Screw	.64
8	N/A	BH027-61	Ball Bearing	7.96	37	BH004-12	BH004-12	Line Roller	3.19
9	BH090-11	BH090-11	Stopper Cam	1.60	38	BH108-11	BH108-13	Bail Screw	.42
10	BH089-11	BH089-11	Stopper Cam Spring	.96	39	BH110-61	BH110-61	Bearing Washer	1.28
11	BH059-11	BH059-14	Stopper Lever	1.08	40	BH086-61	BH086-61	Silent Spring	1.65
12	BH135-11	BH135-12	Stopper Lever Screw	.64	41	BH060-61	BH060-61	Ratchet Gear	1.28
13	BH061-61	BH061-61	Stopper Spring	1.44	42	BH006-61	BH006-61	Rotor Nut	1.28
14	BH063-61	BH063-61	Stopper	1.28	43	BH094-11	BH094-11	Rotor Nut Lock Screw	.94
15	BH077-61	BH077-61	Stopper Screw	.52	44	BH315-71	BH315-71	Main Shaft Assembly	3.08
16	BH011-61	BH011-61	Pinion Gear	3.34	45	BH100-61	BH100-61	Main Shaft Screw	.54
17	BH028-61	BH028-61	Ball Bearing	7.96	46	BH012-71	BH012-71	Driver Gear	3.23
18	BH041-61	BH041-61	Bearing Screw	.54	47	BH026-61	BH026-61	Adjust Washer	1.06
19	BH053-61	BH053-61	O/S Gear	1.65	48	BH027-71	N/A	Body Cover Bushing	.77
20	BH158-61	BH158-61	O/S Gear Bushing	.93	48	N/A	BH027-61	Ball Bearing	7.96
21	BH025-61	BH025-61	O/S Slider	2.17	49	BH023-62	BH023-63	Body Cover	2.76
22	BH009-72	BH009-73	Rotor	6.90	50	BH057-11	BH057-13	Body Cover Screw	.64
23	BH049-71	BH049-71	Kick Lever Spring	.96	51	BH318-62	BH318-63	Handle Assembly	7.43
24	BH019-71	BH019-71	Kick Lever	1.65	52	BH105-11	BH105-11	Handle Cap Washer	.47
25	BH136-61	BH136-61	Kick Lever Screw	.64	53	BH073-31	BH073-33	Handle Screw Cap	3.23
26	BH020-11	BH020-11	Spring Holder	.96	56	BH016-11	BH016-11	Line Roller Bushing	1.06
27	BH022-71	BH022-71	Arm Lever Spring	1.06	57	BH141-61	BH141-61	Pinion Bushing	.95
28	BH031-71	BH031-71	Spring Shaft	.96					

<b>MODEL INTRODUCED</b>	Dec. 1997	<b>EFFECTIVE DATE OF PARTS LIST/DIAGRAM</b>	Dec. 1997	<b>DISCONTINUED</b>	N/A
-------------------------	-----------	---	-----------	---------------------	-----

Prices subject to change without notice. Prices do not include postage and handling.

**PLEASE ORDER BY PART NUMBER** Zebco Division Brunswick Corporation, Box 270, Tulsa, OK 74101 USA 918-836-5581

