



BR160 / BR360 / BR360A

SPECIFICATIONS :

Hvy FW / Med. Lt. SW
 225 yds / 12 lb Line Capacity
 Ball Bearings:
 BR160 - 1 B.B.
 BR360 / BR360A - 3 B.B.
 4.8:1 Gear Ratio
 13.8 oz.

FEATURES :

Front Drag
 Balanced Rotor
 Oversized Twist Reducer Line Roller
 POSI-Loc Selective Anti-Reverse (15 stop)
 Aluminum Long Stroke Max-Cast Spool
 Color: BR160 / 360 - Light Tan
 BR360A - Dark Grey

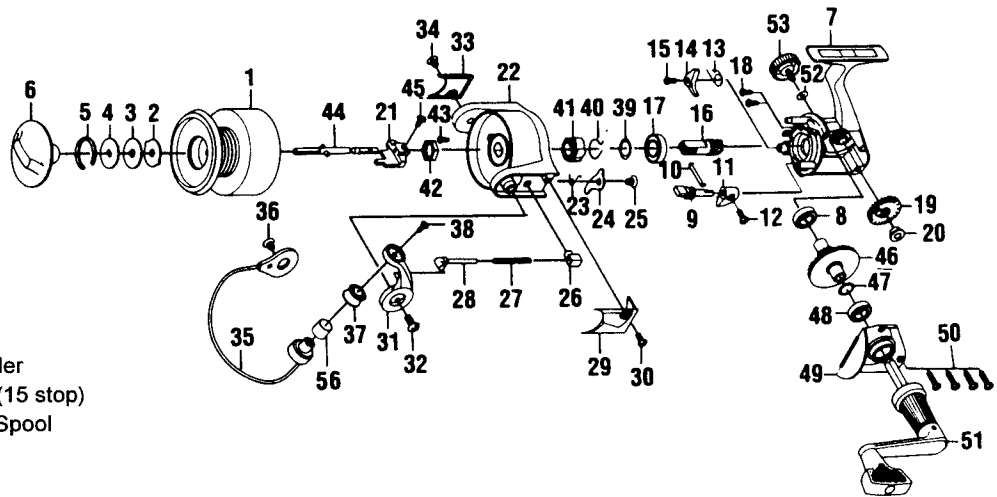

Key No.	Part No.	DESCRIPTION	Price	Key No.	Part No.	DESCRIPTION	Price	
1	BH321-41	Spool Assembly	8.22	29	N / A	Arm Lever Cover (BR360A)	1.85	
1	N / A	Spool Assembly (BR360A)	8.22	30	BH085-11	Cover Screw	0.47	
2	BH081-21	Spool Washer "A"	0.59	30	N / A	Cover Screw (BR360A)	0.47	
3	BH033-21	Spool Washer "B"	0.64	31	BH007-12	Arm Lever	3.19	
4	BH080-31	Spool Washer "D"	0.96	31	N / A	Arm Lever (BR360A)	3.19	
5	BH038-21	Drag Retainer	1.01	32	BH044-11	Arm Lever Screw	0.64	
6	BH332-41	Drag Knob Assembly	3.34	32	N / A	Arm Lever Screw (BR360A)	0.64	
6	N / A	Drag Knob Assembly (BR360A)	3.34	33	BH024-31	Bail Holder Cover	1.75	
7	BH001-41	Body (before A8 date code)	6.63	33	N / A	Bail Holder Cover (BR360A)	1.75	
7	BH001-38	Body (after A8 date code)	6.63	34	BH085-11	Cover Screw	0.64	
7	N / A	Body (BR360A)	6.63	34	N / A	Cover Screw (BR360A)	0.64	
8	BH027-11	Bushing	0.77	35	BH347-42	Bail Assembly	6.63	
8	N / A	BH027-12	Ball Bearing	6.58	35	N / A	Bail Assembly (BR360A)	6.63
9	BH090-11	Stopper Cam	1.60	36	BH044-11	Bail Holder Screw	0.64	
10	BH089-11	Stopper Cam Spring	0.96	36	N / A	Bail Holder Screw (BR360A)	0.64	
11	BH059-11	Stopper Lever	1.08	37	BH004-12	Line Roller	3.19	
11	N / A	BH059-14	Stopper Lever (BR360A)	1.08	38	BH108-11	Bail Screw	0.42
12	BH135-11	Stopper Lever Screw	0.64	38	N / A	Bail Screw (BR360A)	0.42	
12	N / A	BH135-12	Stopper Lever Screw (BR360A)	0.64	39	BH110-31	Bearing Washer	0.54
13	BH061-11	Stopper Spring	0.46	40	BH086-31	Silent Spring	1.65	
14	BH063-32	Stopper	1.53	41	BH060-32	Ratchet Gear	1.80	
15	BH077-11	Stopper Screw	0.64	42	BH006-31	Rotor Nut	1.22	
16	BH011-31	Pinion Gear (before A8 date code)	3.34	43	BH094-11	Rotor Nut Lock Screw	0.94	
16	BH011-32	Pinion Gear (after A8 & BR360A)	3.34	44	BH315-41	Main Shaft Assembly	6.31	
17	BH028-31	Ball Bearing (before A8 date code)	7.43	45	BH100-11	Main Shaft Screw	0.64	
17	BH028-32	Ball Bearing (after A8 & BR360A)	7.43	46	BH012-31	Driver Gear	5.52	
18	BH041-11	Bearing Screw	0.64	47	BH026-11	Adjust Washer	0.69	
19	BH053-31	O/S Gear	1.69	48	BH027-11	N / A	Bushing	0.77
20	BH158-11	O/S Gear Bushing	0.98	48	N / A	BH027-12	Ball Bearing	6.58
21	BH025-31	O/S Slider	2.71	49	BH023-41	Body Cover	5.30	
22	BH009-41	Rotor	6.90	49	N / A	BH023-46	Body Cover (BR360A)	5.30
22	N / A	BH009-46	Rotor (BR360A)	6.90	50	BH057-11	Body Cover Screw	0.64
23	BH049-41	Kick Lever Spring	0.96	50	N / A	BH057-13	Body Cover Screw (BR360A)	0.64
24	BH019-41	Kick Lever	1.97	51	BH318-31	Handle Assembly	7.69	
25	BH136-11	Kick Lever Screw	0.64	51	N / A	BH318-37	Handle Assembly (BR360A)	7.69
26	BH020-11	Spring Holder	0.96	52	BH105-11	Handle Cap Washer	0.47	
27	BH022-41	Arm Lever Spring	0.64	53	BH073-31	Handle Screw Cap	3.23	
28	BH031-31	Spring Shaft	0.96	53	N / A	BH073-33	Handle Screw Cap (BR360A)	3.23
29	BH046-41	Arm Lever Cover	2.76	56	BH016-11	Line Roller Bushing	1.06	

☐ = These parts are not interchangeable with parts from different date code (i.e., use Pinion Gear before A8 along with Ball Bearing and Body before A8)

MODEL INTRODUCED : 1997	EFFECTIVE DATE OF PARTS LIST/DIAGRAM: Sept. '98	DISCONTINUED : N / A
--------------------------------	--	-----------------------------

Prices subject to change without notice. Prices do not include postage and handling.

PLEASE ORDER BY PART NUMBER

Zebco, P.O. Box 270, Tulsa, Ok. 74101; 918-831-6965 Phone or 800-FIXREEL (349-7335) FAX

