

part 40  
500  
3000



**Towrist**  
PFLPURISTLP

For Parts and Service  
Call 1-888-404-1119  
www.mikesreelrepair.com

(19)

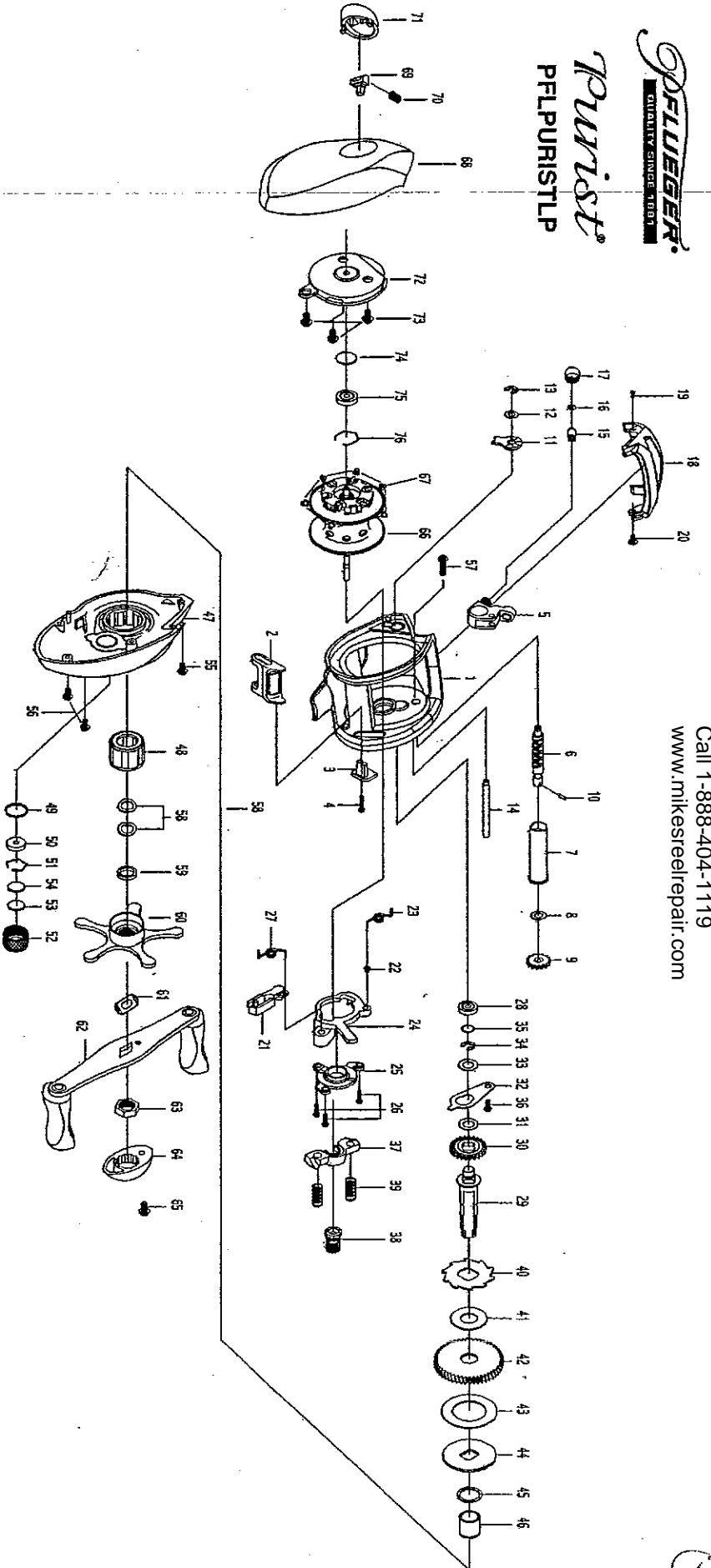

Part #	Part Name	Part #	Part Name	Part #	Part Name
1	Frame	17	Pawl Cap - 1145245	34	Crank Shaft Spacer(Optional)
2	Clutch Bar	18	Front Cover	35	Bearing Plate Screw - 1145283
3	Clutch Link	19	Front Cover Screw-A	36	Pinion Gear
4	Clutch Bar Screw	20	Front Cover Screw-B	37	Pinion Yoke
5	Line Guide Pipe - 1145147	21	Return Pawl	38	Pinion Gear - 1145984
6	Worm Shaft - 1146301	22	Clutch Spring Bushing - 1145288	39	Pinion Yoke Spring(s) - 1146751
7	Line Guide Pipe	23	Clutch Spring - 1146743	40	Ratchet
8	Idler(s) Washer(Optional)	24	Clutch Claw	41	Ratchet Washer
9	Idler(s) - 1145641	25	Cam Plate	42	Drive Gear
10	Worm Shaft Pin - 1145950	26	Cam Plate Screw	43	Drag Washer (B) - 1146854
11	Worm Shaft Bushing(B)	27	Return Pawl Spring - 1146750	44	Drag Washer (D)
12	Worm Shaft Washer(Optional) - 1146823	28	Crank Shaft - 1145089	45	Sleeve Washer(Optional)
13	E-Ring - 1145278	29	Idler(s) Washer(A) - 1145618	46	Sleeve - 1146329
14	Pillar	30	Bearing Plate	47	Right Side Cover
15	Line Guide Pawl - 1145927	31	Idler(s) Washer(B)	48	One Way Clutch - 1145087
16	Spacer(Optional) - 1146818	32	E-Ring	49	O-Ring - 1146069
		33		50	Bushing - 1145081
				51	Bearing Retainer - 1146066
				52	Cast Control Cap - 1146948
				53	Tension Washer
				54	Spool Spacer (B)
				55	Right Side Cover Screw (A)
				56	Right Side Cover Screw (B) - 1146229
				57	Right Side Cover Screw (C)
				58	Drag Spring Washer
				59	Spacer
				60	Slat Drag Assembly
				61	Leaf Spring - 1146859
				62	Handle Assembly
				63	Handle Nut - 1145790
				64	Handle Nut Cap - 1145210
				65	Handle Nut Cap Screw - 1146178
				66	Spool Assembly (incl 188)
				67	Brake Collar (White) (X5) - 1145287
				68	Left Side Cover - 1146947
				69	Loading Pin
				70	Locking Pin Spring
				71	Push Button Assembly
				72	Spool Cover Assembly
				73	Spool Cover Screw
				74	Spool Spacer
				75	Rail Bearing - 1145088
				76	Bearing Retainer - 1146728

#S2THRU'S4 Cost Control Assy  
1146940