

Use this parts list for ordering replacement parts for your Pflueger Baitcast Reel. When ordering, please specify which reel you own and the model number printed on the reel body.

For Parts and Service  
Call 1-888-404-1119  
www.mikesreelrepair.com

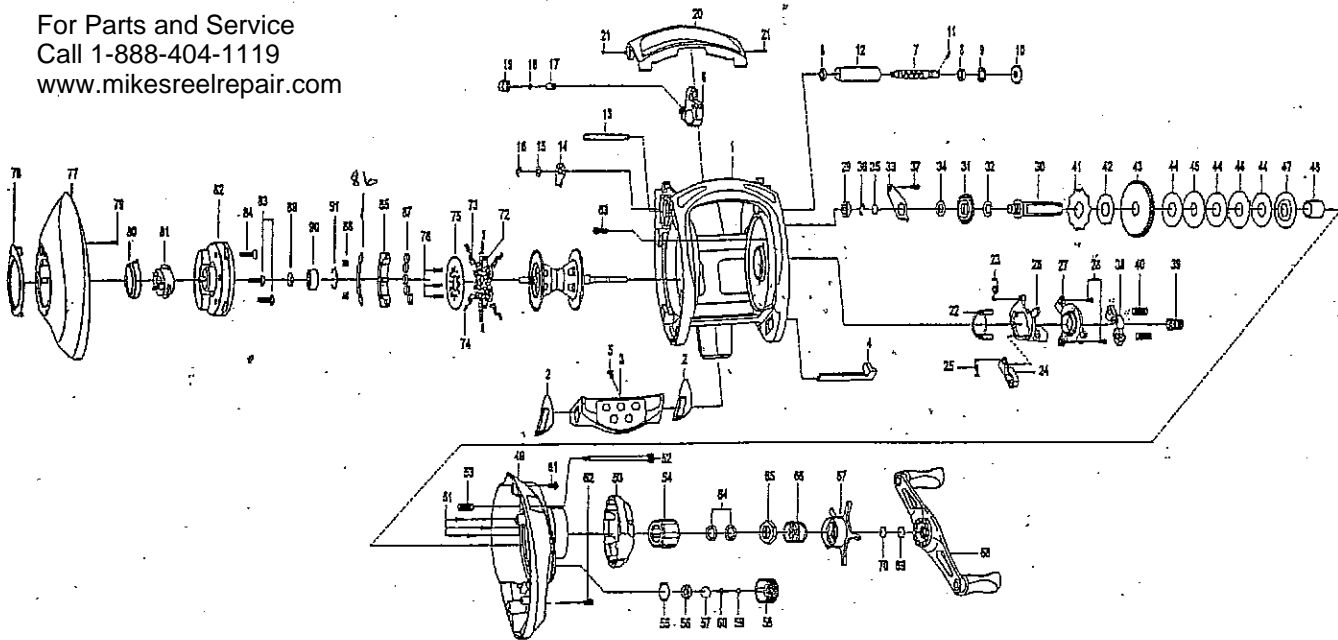

| 1# | Part Name                        | 34 | IDLER(L) WASHER (B)                    | 69 | CUSHION WASHER — 1146891             |
|----|----------------------------------|----|--|----|--------------------------------------|
| 1  | FRAME ASSEMBLY                   | 35 | CRANK SHAFT SPACER(OPTIONAL) — 1146825 | 70 | HANDLE SPACER — 1146891              |
| 2  | CLUTCH BAR PLATE — 1146026       | 36 | E-RING — 1145282                       | 71 | SPOOL ASSEMBLY (INCL 1BB) — 1146589  |
| 3  | CLUTCH BAR ASSEMBLY — 1146963    | 37 | BEARING PLATE SCREW                    | 72 | BRAKE SHOE HOLDER                    |
| 4  | CLUTCH LINK                      | 38 | PINION YOKE — 1146913                  | 73 | BRAKE SHOE (WHITE) (6) — 1145292     |
| 5  | CLUTCH BAR SCREW                 | 39 | PINION GEAR — 1146012                  | 74 | BRAKE SHOE SPRING (6) — 1146789      |
| 6  | LINE GUIDE ASSEMBLY — 1145151    | 40 | PINION YOKE SPRING (2) — 1146788       | 75 | BRAKE HOLDER PLATE                   |
| 7  | WORM SHAFT — 1146324             | 41 | RATCHET                                | 76 | BRAKE HOLDER PLATE SCREW(3) — 114626 |
| 8  | BALL BEARING (2) — 1145115       | 42 | RATCHET WASHER — 1146902               | 77 | LEFT SIDE COVER — 1146964            |
| 9  | WORM SHAFT BUSHING (A) — 1145175 | 43 | DRIVE GEAR                             | 78 | LEFT SIDE COVER PLATE                |
| 10 | IDLER(S) — 1145641               | 44 | DRAG WASHER "L"(3) — 1146903           | 79 | LEFT SIDE COVER PLATE SCREW          |
| 11 | WORM SHAFT PIN — 1145950         | 45 | DRAG WASHER (D1)                       | 80 | CONTROL DIAL ASSEMBLY                |
| 12 | LINE GUIDE PIPE                  | 46 | DRAG WASHER (A)                        | 81 | SIDE CAM                             |
| 13 | PILLAR                           | 47 | DRAG WASHER "D2"                       | 82 | SPOOL COVER ASSEMBLY                 |
| 14 | WORM SHAFT BUSHING (B)           | 48 | SLEEVE — 1146321                       | 83 | SPOOL COVER SCREW (2)                |
| 15 | WORM SHAFT WASHER — 1146901      | 49 | RIGHT SIDE COVER                       | 84 | SPOOL COVER SCREW (1)                |
| 16 | E-RING — 1145282                 | 50 | RIGHT SIDE COVER CAP                   | 85 | MAGNET HOLDER                        |
| 17 | LINE GUIDE PAWL — 1145943        | 51 | RIGHT SIDE COVER CAP SCREW(3)          | 86 | MAGNET HOLDER PLATE                  |
| 18 | SPACER (OPTIONAL) — 1146822      | 52 | THUMB SCREW                            | 87 | MAGNET (5)                           |
| 19 | PAWL CUP — 1145275               | 53 | THUMB SCREW SPRING — 1146798           | 88 | MAGNET HOLDER SPRING (2)             |
| 20 | FRONT COVER                      | 54 | ONE WAY CLUTCH — 1145127               | 89 | SPOOL SPACER (A)                     |
| 21 | FRONT COVER SCREW (2)            | 55 | O-RING — 1146074                       | 90 | BALL BEARING — 1145095               |
| 22 | YOKE HOLDER — 1146916            | 56 | BALL BEARING                           | 91 | BEARING RETAINER — 1146063           |
| 23 | CLUTCH SPRING — 1146749          | 57 | BEARING RETAINER                       |    |                                      |
| 24 | RETURN PAWL — 1145942            | 58 | CAST CONTROL CAST ASSEMBLY — 1146965   |    |                                      |
| 25 | RETURN PAWL SPRING — 1146750     | 59 | SPOOL SPACER — 1146891                 |    |                                      |
| 26 | CLUTCH CAM — 1145186             | 60 | TENSION WASHER — 1146892               |    |                                      |
| 27 | CAM PLATE — 1145185              | 61 | RIGHT SIDE COVER SCREW (A) — 1146261   |    |                                      |
| 28 | CAM PLATE SCREW (A) (2)          | 62 | RIGHT SIDE COVER SCREW (B) — 1146262   |    |                                      |
| 29 | BALL BEARING — 1145089           | 63 | RIGHT SIDE COVER SCREW (C)             |    |                                      |
| 30 | CRANK SHAFT                      | 64 | DRAG SPRING WASHER (2) — 1146895       |    |                                      |
| 31 | IDLER(L) — 1145607               | 65 | DRAG NUT — 1146895                     |    |                                      |
| 32 | IDLER(L) WASHER (A) (OPTIONAL)   | 66 | STAR DRAG SPRING                       |    |                                      |
| 33 | BEARING PLATE                    | 67 | STAR DRAG ASSEMBLY                     |    |                                      |
|    |                                  | 68 | HANDLE ASSEMBLY (INCL 4BB) — 1145523   |    |                                      |