

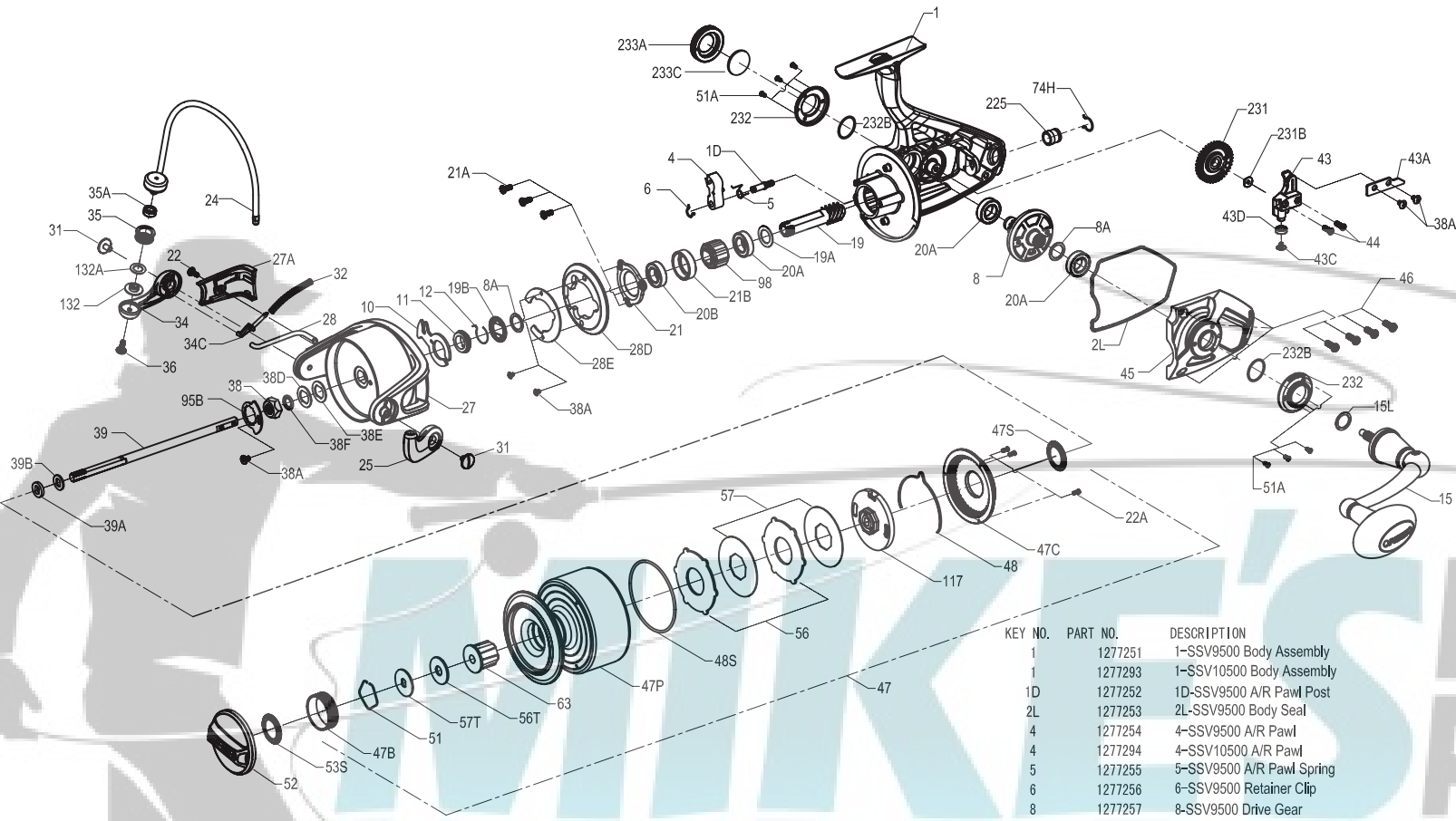

PARTS LIST FOR MODEL SSV9500/SSV10500



KEY NO.	PART NO.	DESCRIPTION
27	1277296	27-SSV10500 Rotor
27A	1277266	27A-SSV9500 Rotor Cover
28	1277267	28-SSV9500 Bail Trip Lever
28D	1277268	28D-SSV9500 Rotor Brake
28D	1277297	28D-SSV10500 Rotor Brake
28E	1294661	28E-SSV9500 Rotor Brake Cover
28E	1294662	28E-SSV10500 Rotor Brake Cover
31	1277055	31-SSV5500 Bail Arm Screw (2req)
32	1277270	32-SSV9500 Bail Spring
34	1277163	34-SSV7500 Bail Arm
34C	1277164	34C-SSV7500 Pivot Arm
35	1277165	35-SSV7500 Line Roller
35A	1277060	35A-SSV5500 Line Roller Ball Bearing
36	1277166	36-SSV7500 Line Roller Screw
38	1309004	38-SSV9500 Rotor Nut
38A	1277063	38A-SSV5500 Rotor Nut Lock Plate Screw(5req)
38D	1277168	38D-SSV7500 Rotor Washer
38E	1309005	38E-SSV9500 Pinion Washer
38F	1309006	38F-SSV9500 Mainshaft Seal
39	1277271	39-SSV9500 Main Shaft
39A	1288190	39A-SSV9500 Spool Adjust Washer
39B	1288191	39B-SSV9500 Mainshaft Washer
43	1277272	43-SSV9500 Oscillation Slider
43A	1277273	43A-SSV9500 Oscillation Slider Guide
43C	1277071	43C-SSV5500 Oscillation Slider Bushing Screw
43D	1279457	43D-SSV3500 Oscillation Slider Bushing
44	1277174	44-SSV7500 Main Shaft Screw (2req)
45	1277274	45-SSV9500 Body Cover
45	1277298	45-SSV10500 Body Cover
46	1277275	46-SSV9500 Body Cover Screw (4req)
47	1277276	47-SSV9500 Spool Assembly
47	1277299	47-SSV10500 Spool Assembly
47B	1277208	47B-SSV8500 Spool Band
47C	1277277	47C-SSV9500 Drag Cover
47P	1277279	47P-SSV9500 Spool
47P	1277301	47P-SSV10500 Spool
47S	1277280	47S-SSV9500 Drag Drive Plate Seal
48	1277281	48-SSV9500 Spool Clicker
48S	1277282	48S-SSV9500 Drag Cover Seal
51	1277085	51-SSV5500 Drag Washer Retainer
51A	1277183	51A-SSV7500 Bearing Retainer Screw (6req)
52	1277283	52-SSV9500 Drag Knob Assembly
52	1277302	52-SSV10500 Drag Knob Assembly
53S	1293253	53S-SSV7500 Drag Knob Seal
56	1277284	56-SSV9500 Drag Friction Washer (2req)
56T	1277089	56T-SSV5500 Drag Friction Washer
57	1277285	57-SSV9500 Keyed Drag Washer (2req)
57T	1277187	57T-SSV7500 Keyed Drag Washer
63	1277286	63-SSV9500 Spool Bushing
74H	1277287	74H-SSV9500 Rear Bushing E-Clip
95B	1277189	95B-SSV7500 Rotor Nut Locking Plate
98	1277190	98-SSV7500 Clutch / Sleeve Assembly
117	1277288	117-SSV9500 Drag Drive Plate
132	1277192	132-SSV7500 Line Roller Collar
132A	1277097	132A-SSV5500 Line Roller Washer
225	1277289	225-SSV9500 Rear Bushing
231	1277290	231-SSV9500 Oscillation Gear
231B	1277100	231B-SSV5500 Oscillation Gear Screw
232	1277292	232-SSV9500 Bearing Retainer (2req)
232	1277303	232-SSV10500 Bearing Retainer (2req)
232B	1302503	232B-SSV7500 Bearing Retainer O - Ring (2 req.)
233A	1277196	233A-SSV7500 Handle Cap
233C	1277197	233C-SSV7500 Handle Cap Washer
1	1277251	1-SSV9500 Body Assembly
1	1277293	1-SSV10500 Body Assembly
1D	1277252	1D-SSV9500 A/R Pawl Post
2L	1277253	2L-SSV9500 Body Seal
4	1277254	4-SSV9500 A/R Pawl
4	1277294	4-SSV10500 A/R Pawl
5	1277255	5-SSV9500 A/R Pawl Spring
6	1277256	6-SSV9500 Retainer Clip
8	1277257	8-SSV9500 Drive Gear
8A	1277146	8A-SSV7500 Drive Gear Shim Washer
10	1277258	10-SSV9500 A/R Pawl Holder
11	1288189	11-SSV9500 A/R Bushing
12	1309001	12-SSV9500 A/R Bushing Spring
15	1277259	15-SSV9500 Handle Assembly
15L	1292784	15L-SSV7500 Handle Seal
19	1277260	19-SSV9500 Pinion Gear
19A	1309002	19A-SSV9500 Pinion Gear Washer/Bushing
19B	1309003	19B-SSV9500 Pinion Seal
20A	1277152	20A-SSV7500 Ball Bearing (3req)
20B	1277261	20B-SSV9500 Ball Bearing
21	1277262	21-SSV9500 Pinion Bearing Retainer
21A	1277154	21A-SSV7500 Pinion Retainer Screw (3req)
21B	1277263	21B-SSV9500 Pinion Ball Bearing Collar
22	1277046	22-SSV5500 Rotor Cover Screw
22A	1277047	22A-SSV5500 Drag Cover Screw (3req)
24	1277264	24-SSV9500 Bail Assembly
24	1277295	24-SSV10500 Bail Assembly
25	1277157	25-SSV7500 Bail Holder
27	1277265	27-SSV9500 Rotor