

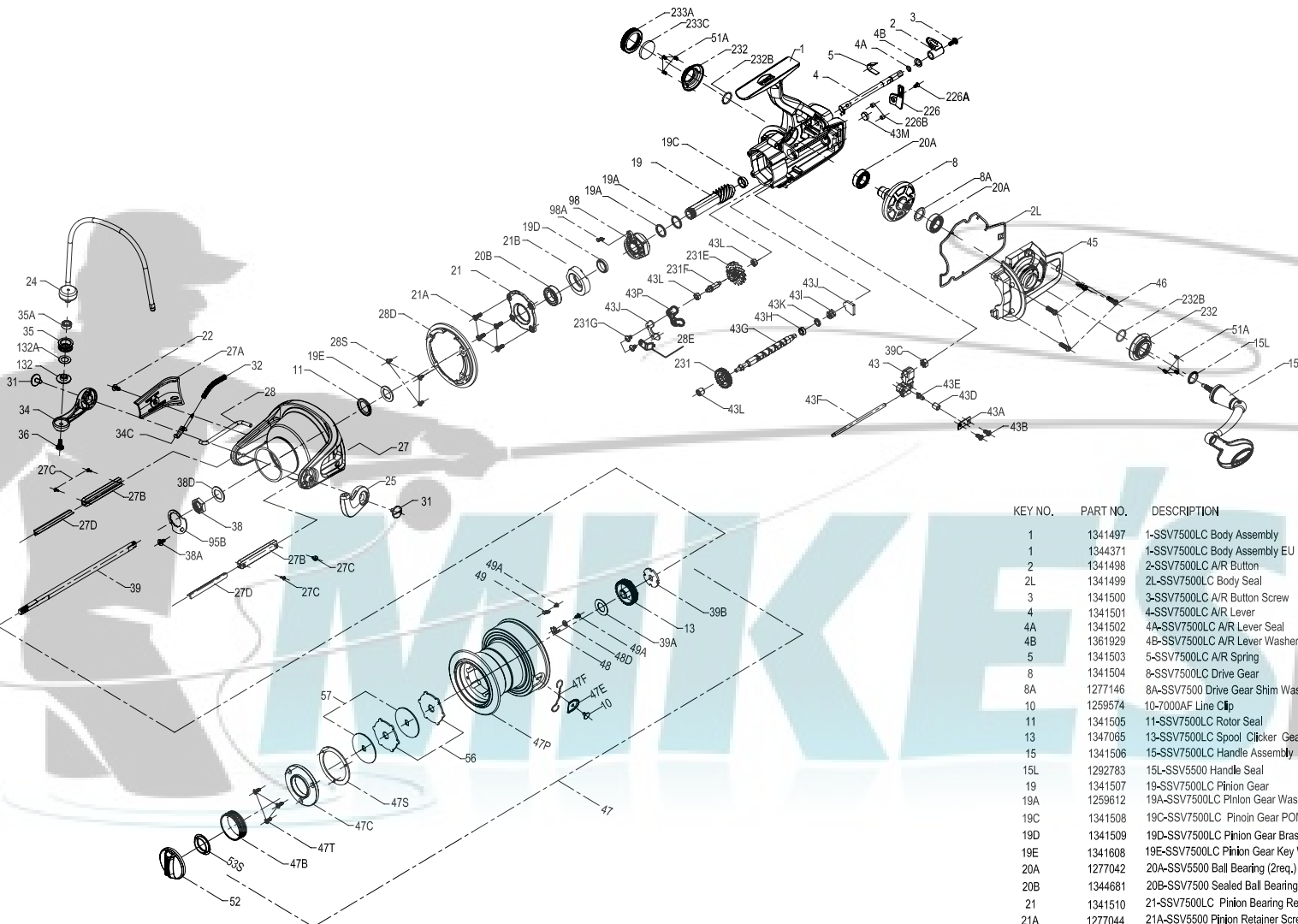

PARTS LIST FOR MODEL SSV7500LC-USA / SSV7500LC-EU



KEY NO.	PART NO.	DESCRIPTION
28E	1341520	28E-SSV7500LC Brake Retainer Plate
28S	1277054	28S-SSV5500 Rotor Brake Screw (3req.)
31	1277055	31-SSV5500 Bail Arm Screw (2req.)
32	1259546	32-7000AF Bail Spring
34	1277163	34-SSV7500 Bail Arm
34C	1277164	34C-SSV7500 Pivot Arm
35	1277165	35-SSV7500 Line Roller
35A	1277060	35A-SSV5500 Line Roller Ball Bearing
36	1277166	36-SSV7500 Line Roller Screw
38	1309004	38-SSV9500 Rotor Nut
38A	1277063	38A-SSV5500 Rotor Nut Lock Plate Screw
38D	1341521	38D-SSV7500LC Rotor Washer
39	1341522	39-SSV7500LC-USA Main Shaft
39	1341523	39-SSV7500LC-EU Main Shaft
39A	1341524	39A-SSV7500LC Spool Adjust Washer
39B	1341525	39B-SSV7500LC Main Shaft Washer
39C	1259637	39C-7000AF Main Shaft Nut
43	1341526	43-SSV7500LC O/S Slider
43A	1259635	43A-7000AF Slider Retainer Plate
43B	1276992	14-SSV6500LL O/S Slider Retainer Screw (2req.)
43D	1122193	43D-7000AF Guide Claw Bushing
43E	1122192	43E-7000AF Guide Claw
43F	1341527	43F-SSV7500LC Guide Shaft
43G	1341528	43G-SSV7500LC Worm Shaft
43H	1341529	43H-SSV7500LC Worm Shaft Ball Bearing
43I	1341530	43I-SSV7500LC Compression Spring
43J	1259620	43J-7000AF Worm Shaft Top Retainer Plate
43K	1341531	43K-SSV7500LC Rear Retainer Plate
43K	1341532	43K-SSV7500LC Worm Shaft Washer
43L	1341533	43L-SSV7500LC Worm Shaft Bushing
43L	1122132	43L-7000AF Worm Shaft Bushing (2req.)
43M	1341534	43M-SSV7500LC Worm Shaft Seal
43P	1361931	43P-SSV7500LC Worm Shaft Retainer Seal
45	1341536	45-SSV7500LC Body Cover
46	1277074	46-SSV5500 Body Cover Screw (4req.)
47	1341536	47-SSV7500LC-USA Spool Assembly
47	1341537	47-SSV7500LC-EU Spool Assembly
47B	1341538	47B-SSV7500LC-USA Spool Band
47B	1341539	47B-SSV7500LC-EU Spool Band
47C	1341540	47C-SSV7500LC Drag Cover
47E	1277079	47E-SSV5500 Line Clip Bushing
47F	1277112	47F-SSV6500 Line Clip Retainer
47P	1341541	47P-SSV7500LC-USA Spool
47P	1341542	47P-SSV7500LC-EU Spool
47S	1341543	47S-SSV7500LC Drag Cover Seal
47T	1341544	47T-SSV7500LC Drag Cover Screw(3req.)
48	1259577	48-7000AF Spool Click Plate
48D	1341546	48D-SSV7500LC Spool Clicker Spacer Ring
49	1259579	49-7000AF Spool Click Spring
49A	1341547	49A-SSV7500LC Spool Clicker Spring Screw(2req.)
51A	1277086	51A-SSV5500 Bearing Retainer Screw (6req.)
52	1341548	52-SSV7500LC-USA Drag Knob Assembly
52	1341549	52-SSV7500LC-EU Drag Knob Assembly
53S	1293252	53S-SSV5500 Drag Knob Seal
56	1341550	56-SSV7500LC Drag Friction Washer (2req.)
57	1341551	57-SSV7500LC Keyed Drag Washer (2req.)
95B	1277189	95B-SSV7500 Rotor Nut Locking Plate
98	1259618	98-7000AF One Way Clutch Bearing Assembly
98A	1361930	98A-SSV7500LC Clutch Assembly Spring
132	1277192	132-SSV7500 Line Roller Collar
132A	1277097	132A-SSV5500 Line Roller Washer
226	1341552	226-SSV7500LC Rear Cover
226A	1341553	226A-SSV7500LC Rear Cover Screw
226B	1341554	226B-SSV7500LC Body Rear Seal (2req.)
231	1341555	231-SSV7500LC O/S Gear
231E	1341556	231E-SSV7500LC Slow O/S Gear Pin
231F	1259621	231F-7000AF Slow O/S Gear Pin
231G	1277070	231G-SSV5500 O/S Gear Pin Screw(2req.)
232	1341557	232-SSV7500LC Bearing Retainer (2req.)
232B	1302502	232B-SSV3500 Bearing Retainer O-Ring(2req.)
233A	1277103	233A-SSV5500 Handle Cap
233C	1277104	233C-SSV5500 Handle Cap Washer