

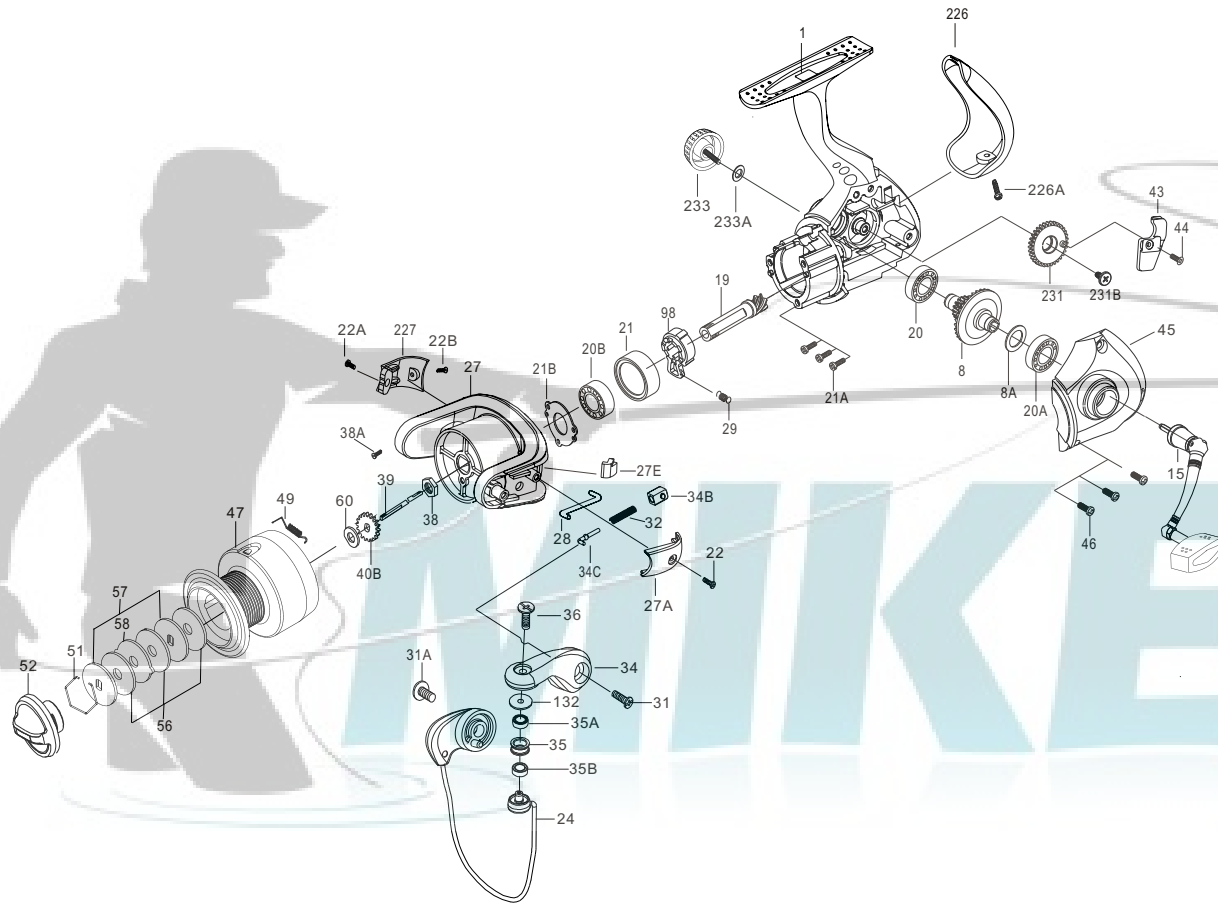

PARTS LIST FOR MODEL SV4000



KEY

NO. DESCRIPTION

NO.	DESCRIPTION	NO.
1	HOUSING	001 4000SV
8	Main Gear Assembly	008 4000SV
8A	Main Gear Shim	008A 5000CV
15	Handle Assembly	015 4000SV
19	Pinion Gear	019 4000SV
20	Housing Ball Bearing	020 5000CV
20A	Housing Cover Ball Bearing	020 5000SV
20B	Pinion Ball Bearing	020B500CV
21	Collar	021 2000SV
21A	Bearing Mounting Screw(3 req.)	021A2000SV
21B	Ball Bearing Fixed Washer	021B4000SV
22	Bail Arm Cover Screw	022 2000SV
22A	Side Cover Screw	022A2000SV
22B	Side Cover Screw	022B2000SV
24	Bail Wire	024 4000SV
27	Rotor Cup	027 4000SV
27A	Bail Pivot Cover	027A4000SV
27E	Balance Weight	027E4000SV
28	Trip Lever	028 4000SV
29	Spring	029 4000SV
31	Bail Arm Screw	031 2000SV
31A	Bail Wire Screw	031 2000SV
32	Bail Spring	032 2000SV
34	Bail Arm	034 4000SV
34B	Pivot Guide	034B2000SV
34C	Pivot Arm	034C4000SV
35	Line Roller	035 4000SV
35A	Line Roller Ball Bearing	035A2000CV
35B	Line Roller Bushing	035B2000SV
36	Bail Stud Screw	036 4000SV
38	Rotor Nut	038 2000CV
38A	Rotor Nut Screw	038A2000CV
39	Spool Shaft	039 4000SV
40B	Click Ratchet	040B2000CV
43	Crosswind Block	043 4000SV
44	Crosswind Block Screw	044 2000SV
45	Housing Cover	045 4000SV
46	Housing Cover Screw(3 req.)	046 2000SV
47	Spool Assembly	047 4000SV
49	Spool Click Spring	049 2000CV
51	Retaining Ring	051 2000CV
52	Drag Knob	052 2000SV
56	Friction Drag Washer(3 req.)	056 2000CV
57	Keyed Washer(2 req.)	057 2000CV
58	Drag Washer Earred	058 2000CV
60	Thrust Washer	060 2000CV
98	Clutch Retainer	098 4000SV
132	Roller Washer	132 2000CV
226	Rear Cap	226 4000SV
226A	Rear Cap Screw	226A2000SV
227	Cam Cover	227 4000SV
231	Crosswind Gear	2314000SV
231B	Crosswind Gear Screw	231B2000SV
233	Bearing Cover	233 2000SV
233A	Bearing Cover Washer	233A2000SV

PART

NO.