

PARTS LIST FOR MODEL PGV1000

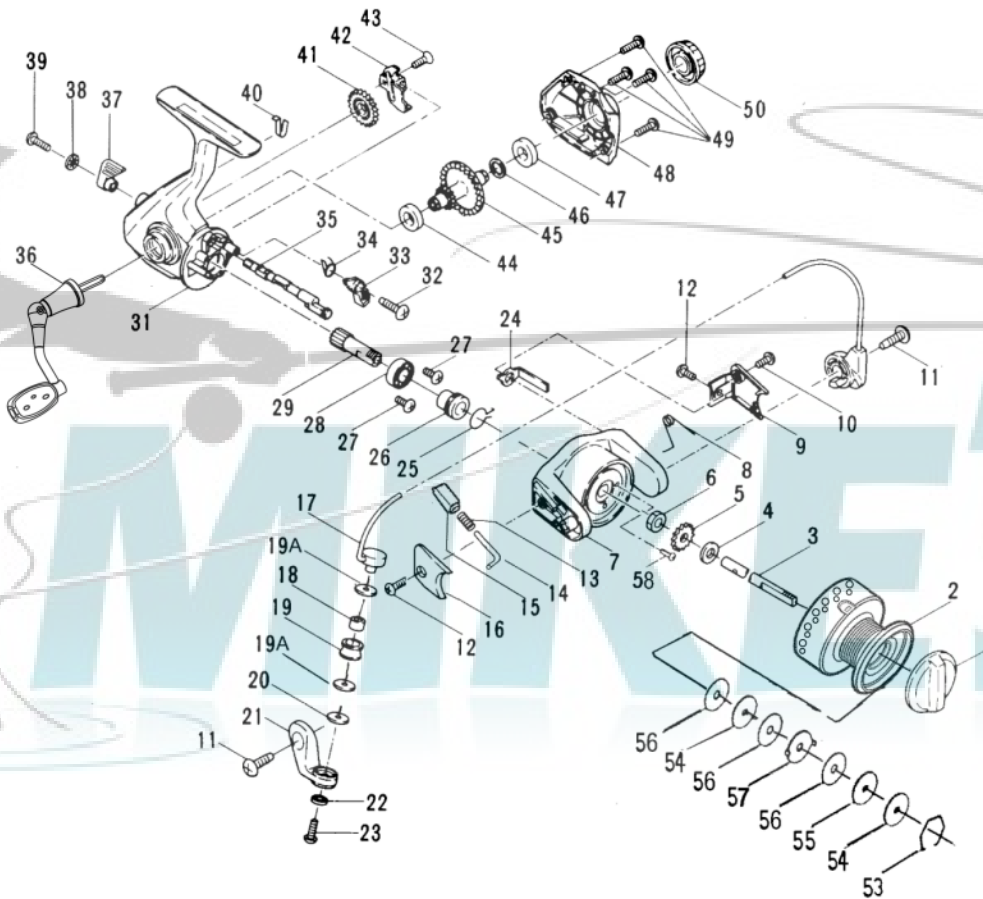

KEY NO.	PART NO.	DESCRIPTION
1	52-1000V	Drag Knob ASM. w/Spring
2	47-1000V	Spool Assembly
3	39-1000	Spool Shaft
4	60-1000	Thrust Washer
5	40B-1000	Click Ratchet
6	38-1000	Rotor Nut
7	27-1000V	Rotor Cup
8	106-1000P	Cam Lever Spring
9	227-1000V	Cam Lever Cover
10	50-1000	Cover Screw
11	31A-1000	Arm Screw (2)
12	28B-1000	Cam Lever Mtg. Screw (2)
13	34C-1000P	Pivot Spring
14	34B-1000P	Pivot Shaft
15	34D-1000P	Pivot Guide
16	27A-1000V	Bail Pivot Cover
17	24-1000P	Bail Wire Assembly
18	35A-1000V	Line Roller Ball Bearing
19	35-1000	Line Roller
19A	35B-1000P	Line Roller Teflon Washer (2)
20	132-1000	Line Roller Washer
21	34-1000V	Bail Arm
22	036A-103	Lock Washer
23	36-1000	Bail Stud Screw
24	28A-1000P	Cam Lever
25	230-1000	Silent Dog Spring
26	19A-1000	Pinion Spacer
27	23-1000	Bearing Mtg. Screw (2)
28	20-1000	Ball Bearing
29	19-1000	Pinion Gear
31	1-1000V	Housing
32	3-1000	Dog Mounting Screw
33	4-1000	Anti-Reverse Dog
34	4A-1000	Dog Spring
35	6A-1000	Eccentric Shaft
36	15-1000V	Handle Assembly(w/ball brg)
37	6E-1000V	Eccentric Lever
38	6G-1000	Lock Washer
39	6F-1000	Ecc. Lever Mounting Scr.
40	6D-1000	Ecc. Shaft Spring
41	231-1000	Crosswind Gear
42	43-1000	Crosswind Block
43	44-1500	Crosswind Block Screw
44	2B-1000	Housing Bearing
45	8-1000P	Main Gear
46	8A-3000	Main Gear Shim
47	2B-1500	Housing Cover Bearing
48	45-1000V	Housing Cover
49	46-1000	Cover Screw (4)
50	233-1000V	Bearing Cover
**51	48-1000P	Spool Click Tongue
**51A	049-103CS	Click Tongue Spring
**52	022-103CS	Click Tongue Screw
53	51-1000	Drag Retaining Ring
54	57-1000	Keyed Drag Washer (2)
55	52A-1000	Thick Drag Washer (1)
56	6-1000	Teflon Drag Washer (3)
57	58-1000	Ear Drag Washer (1)
58	38A-1000	Rotor Nut Locking Screw