

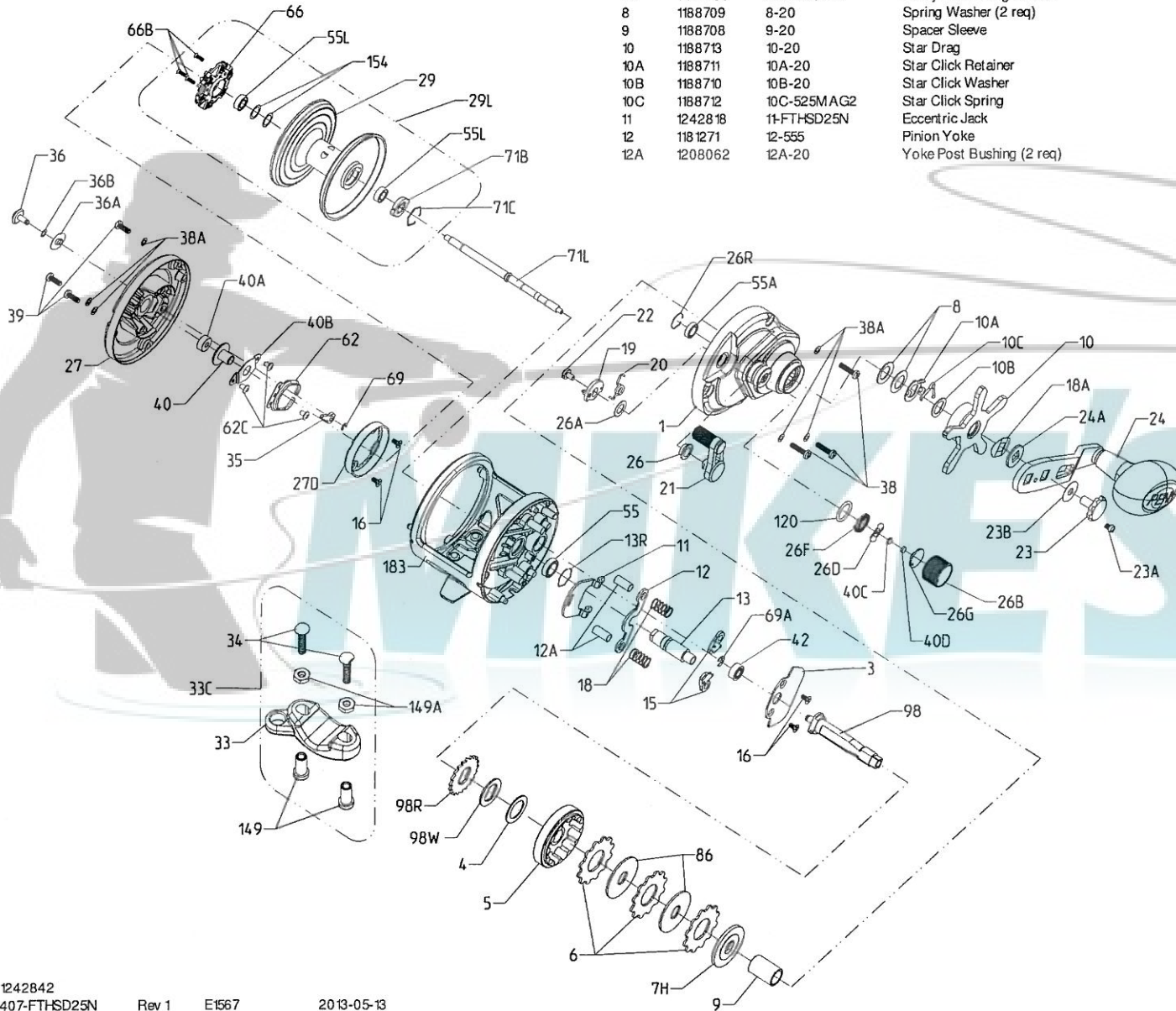

**PARTS LIST FOR MODEL FATHOM SD 25N**  
REEL PART NO. 1238444



| Key No. | Part No. | PENN Style No. | Description               |
|---------|----------|----------------|---------------------------|
| 1       | 1242812  | 1-FTHSD25N     | Right Side Plate          |
| 3       | 1242817  | 3-FTHSD25N     | Bridge                    |
| 4       | 1180775  | 4-349          | Drag Washer               |
| 5       | 1242789  | 5-FTHSD12      | Main Gear                 |
| 6       | 1237037  | 6-TRQ40        | Drag Washer Tab (3 req)   |
| 7H      | 1242788  | 7H-FTHSD12     | Heavy Metal Drag Washer   |
| 8       | 1188709  | 8-20           | Spring Washer (2 req)     |
| 9       | 1188708  | 9-20           | Spacer Sleeve             |
| 10      | 1188713  | 10-20          | Star Drag                 |
| 10A     | 1188711  | 10A-20         | Star Click Retainer       |
| 10B     | 1188710  | 10B-20         | Star Click Washer         |
| 10C     | 1188712  | 10C-525MAG2    | Star Click Spring         |
| 11      | 1242818  | 11-FTHSD25N    | Eccentric Jack            |
| 12      | 1181271  | 12-555         | Pinion Yoke               |
| 12A     | 1208062  | 12A-20         | Yoke Post Bushing (2 req) |

|      |         |              |                            |
|------|---------|--------------|----------------------------|
| 13   | 1242790 | 13-FTHSD12   | Pinion                     |
| 13R  | 1229364 | 13R-TRQ40    | Retaining Ring             |
| 15   | 1188675 | 15-20        | Anti Reverse Dog (2 req)   |
| 16   | 1188686 | 16-20        | Bridge Screw (4 req)       |
| 18   | 1188688 | 18-20        | Pinion Yoke Spring (2 req) |
| 18A  | 1188714 | 18A-20       | Keyed Spring Washer        |
| 19   | 1188691 | 19-20        | Eccentric                  |
| 20   | 1242806 | 20-FTHSD12   | Eccentric Spring           |
| 21   | 1242831 | 21-FTHSD25N  | Eccentric Lever            |
| 22   | 1188690 | 22-20        | Eccentric Screw            |
| 23   | 1208117 | 23-FTH20LW   | Handle Screw               |
| 23A  | 1188717 | 23A-20       | Handle Lock Screw          |
| 23B  | 1207784 | 23B-20       | Handle Screw Washer        |
| 24   | 1242787 | 24-FTHSD12   | Handle Assembly            |
| 24A  | 1188715 | 24A-20       | Handle Thrust Washer       |
| 26   | 1188692 | 26-20        | Bushing                    |
| 26A  | 1242792 | 26A-FTHSD12  | Washer                     |
| 26B  | 1208114 | 26B-FTH20LW  | Spool Tension Control Cap  |
| 26D  | 1125769 | 26D-525MAG2  | Click Spring               |
| 26F  | 1125768 | 26F-525MAG2  | Click Plate A              |
| 26G  | 1125772 | 26G-525MAG2  | Click Plate B              |
| 26R  | 1214654 | 26R-525MAG2  | Ring Retaining             |
| 27   | 1242813 | 27-FTHSD25N  | Left Side Plate            |
| 27D  | 1242794 | 27D-FTHSD12  | Centrifugal Brake Path     |
| 29   | 1242814 | 29-FTHSD25N  | Spool                      |
| 29L  | 1242837 | 29L-FTHSD25N | Spool Assembly             |
| 33   | 1182754 | 33-113       | Rod Clamp                  |
| 33C  | 1229936 | 33C-TRQ40    | Rod Clamp Kit              |
| 34   | 1182788 | 34-45        | Screw (2 req)              |
| 35   | 1188656 | 35-20        | Click Tongue               |
| 36   | 1242819 | 36-FTHSD25N  | Click Button               |
| 36A  | 1208113 | 36A-FTH20LW  | Click Washer               |
| 36B  | 1188651 | 36B-20       | Click PVC Washer           |
| 38   | 1188698 | 38-20        | Screw (3 req)              |
| 38A  | 1188649 | 38A-20       | Flat Washer (6 req)        |
| 39   | 1188638 | 39-20        | Screw (3 req)              |
| 40   | 1230004 | 40-TRQ40     | Bushing L.S. Spool         |
| 40A  | 1242804 | 40A-FTHSD12  | Bearing                    |
| 40B  | 1242805 | 40B-FTHSD12  | Protector Bearing          |
| 40C  | 1208115 | 40C-525MAG2  | Washer, Metal Thrust       |
| 40D  | 1125771 | 40D-525MAG2  | Washer, Rubber Thrust      |
| 42   | 1188661 | 40-20        | Ball Bearing               |
| 55   | 1214665 | 55-525MAG2   | Ball Bearing               |
| 55A  | 1214666 | 55A-525MAG2  | Ball Bearing 6x10x2.5      |
| 55L  | 1192031 | 55L-965      | Ball Bearing (2 req)       |
| 62   | 1188664 | 62-20        | Click Spring               |
| 62C  | 1188654 | 62C-20       | Screw (3 req)              |
| 66   | 1242797 | 66-FTHSD12   | Centrifugal Brake          |
| 66B  | 1242798 | 66B-FTHSD12  | Screw (3 req)              |
| 69   | 1188657 | 69-20        | Retainer                   |
| 69A  | 1188659 | 69A-20       | Retainer                   |
| 71B  | 1230226 | 71B-TRQ40    | Spool Driver               |
| 71C  | 1230227 | 71C-TRQ40    | Retaining Ring             |
| 71L  | 1242815 | 71L-FTHSD25N | Spool Shaft                |
| 86   | 1184251 | 86-49L       | Drag Washer Keyed (2 req)  |
| 98   | 1188700 | 98-20        | Main Gear Shaft            |
| 98R  | 1242800 | 98R-FTHSD12  | Anti Reverse Ratchet       |
| 98W  | 1242801 | 98W-FTHSD12  | Ratchet Thrust Washer      |
| 120  | 1184522 | 120113H      | O-ring                     |
| 149  | 1184702 | 149-45       | Nut, Rod Clamp (2 req)     |
| 149A | 1184706 | 149-200      | Nut, Hex (2 req)           |
| 154  | 1242803 | 154-FTHSD12  | Shim (As Needed)           |
| 183  | 1242816 | 183-FTHSD25N | Frame Assembly             |