



# INTERNATIONAL® 975LD SPECIFICATIONS AND PARTS LIST

Congratulations on the purchase of your new

Penn International® baitcaster! For general

features, operating instructions, casting control

information, maintenance, lubrication and

servicing, please refer to the main International®

manual (featuring the 965). Keep this sheet

for reference to 975LD part numbers and

specifications. Good fishing!

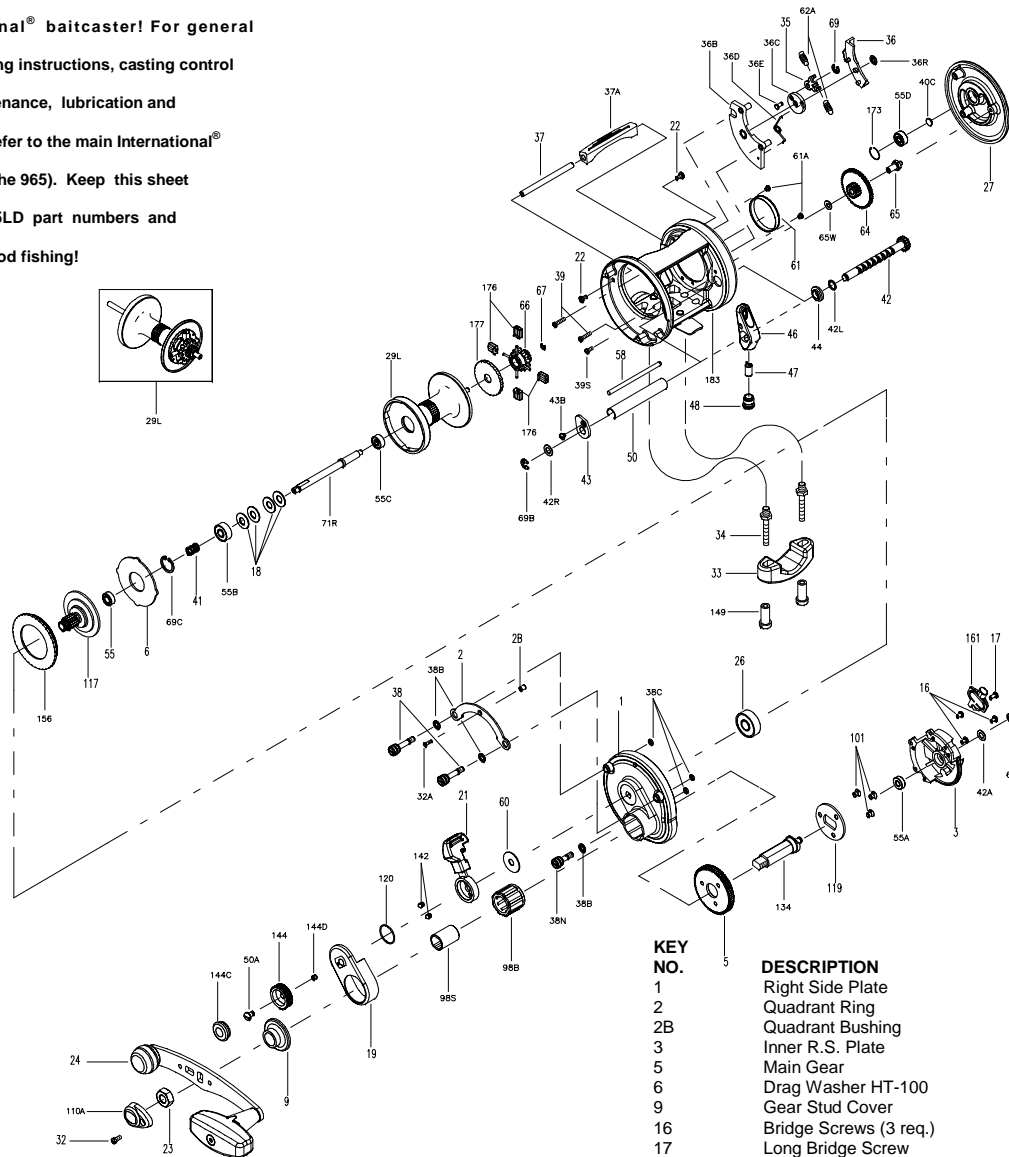

## LINE CAPACITY

300 YDS / 15 LBS  
275 METERS / 0.40 MM

## GEAR RATIO

4.4-1

## WEIGHT

17 OZ  
480 GRAMS

## KEY NO.

1  
2  
2B  
3  
5  
6  
9  
16  
17  
18  
19  
21  
22  
23  
24  
26  
27  
29L  
32  
32A  
33

## DESCRIPTION

Right Side Plate  
Quadrant Ring  
Quadrant Bushing  
Inner R.S. Plate  
Main Gear  
Drag Washer HT-100  
Gear Stud Cover  
Bridge Screws (3 req.)  
Long Bridge Screw  
Disc Clutch Spring (4 req.)  
Cam Assembly  
Eccentric Lever  
Post Screw (2 req.)  
Handle Nut  
Handle Assembly  
R.S. Plate Bearing  
Left Side Plate  
Spool Assembly  
Handle Cap Screw  
Quadrant Screw  
Rod Clamp

## PART NO.

001 975LD  
002 975LD  
002B975LD  
003 975LD  
005 975LD  
006 975LD  
009 975LD  
016 975LD  
017 975LD  
018 975LD  
019 975LD  
021 975LD  
050 716  
023 555  
024 975  
026N025  
027 975  
029L975LD  
032 015  
032 975LD  
033 113

## KEY NO.

34  
35  
36  
36B  
36C  
36D  
36E  
36R  
37  
37A  
38  
38B  
38C  
38N  
39  
39S  
40C  
41  
42  
42A  
42L  
42R  
43  
43B  
44  
46  
47  
48  
50  
50A  
55  
55A  
55B  
55C  
55D  
58  
60  
61  
61A  
62A  
64  
65  
65W  
66  
67  
69  
69C  
69B  
71R  
98B  
98S  
101  
110A  
117  
119  
120  
134  
142  
144  
144C  
144D  
149  
156  
161  
173  
176  
177  
183

## DESCRIPTION

Rod Clamp Screw (2 req.)  
Click Tongue  
Click Button  
Click Housing  
Click Wheel  
Click Wheel Spring  
Click Tongue Pin  
Retaining Ring  
Thumb Bar Post  
Thumb Bar  
Take-Apart Screw (2 req.)  
Side Plate Washer (3 req.)  
Screw 'O' Ring (3 req.)  
Take-Apart Screw  
L.S. Plate Screw (2 req.)  
L.S. Plate Short Screw  
Metal Thrust Washer  
Bearing Spring  
Worm Shaft  
Metal Washer  
L.S. Worm Shaft Washer  
R.S. Worm Shaft Washer  
R.S. Worm Shaft Bushing  
Worm Bushing Screw  
L.S. Worm Shaft Bushing  
Line Guide  
Pawl  
Pawl Cover Screw  
Worm Shield  
Pre-Set Knob Screw  
Ball Bearing  
Gear Stud Bushing  
Spool Bearing  
Spool Bearing  
Left Side Bearing  
Line Guide Post  
Eccentric Washer  
Brake Drum  
Brake Drum Screw (2 req.)  
Click Spring (2 req.)  
Idler Gear  
Idler Gear Pin  
Idler Gear Washer  
Spool Gear Click Ratchet  
Lock Ring  
Retaining Ring  
Spool Retaining Ring  
Retaining Ring (2 req.)  
Spool Spindle  
Roller Bearing  
Bearing Clutch Shaft  
Retaining Plate Screw (3 req.)  
Handle Nut Cap  
Drive Plate Assembly  
Retaining Plate  
Eccentric O-Ring  
Gear Stud  
Cam Follower (2 req.)  
Preset Knob  
Preset Knob Cap  
Preset Knob Click  
Rod Clamp Nut (2 req.)  
Drag Cover  
Strike Button  
L.S. Bearing Retainer  
Anti-Backlash Brakes (4 req.)  
Brake Selection Knob  
Frame Assembly

## PART NO.

034 975  
035 965  
036 975  
036B975  
036C965  
036D965  
036E965  
036R965  
037 975  
037A975  
038 975LD  
038BN965  
038CN965  
038N965  
039 965  
039S965  
040C310  
041 975LD  
042 975  
042R965  
042L965  
042R965  
043 965  
043B965  
044 975  
046 975  
047 975  
048 965  
050 975  
050 716  
055 965  
055A965  
055 116  
055 113H  
055 113H  
058 975  
060 975LD  
061 965  
043B965  
062A965  
064 975  
065 965  
065W965  
066M965  
067 016S  
069B050  
069 975LD  
069B600  
071R975LD  
098B525  
098S525  
101 050S  
110A555  
117 975LD  
119 030S  
026R965  
134 975  
142 975LD  
144 975LD  
144C975LD  
144D975LD  
149 045  
156 975LD  
161 975LD  
173 965  
176 975LD  
177 965  
183N975LD