

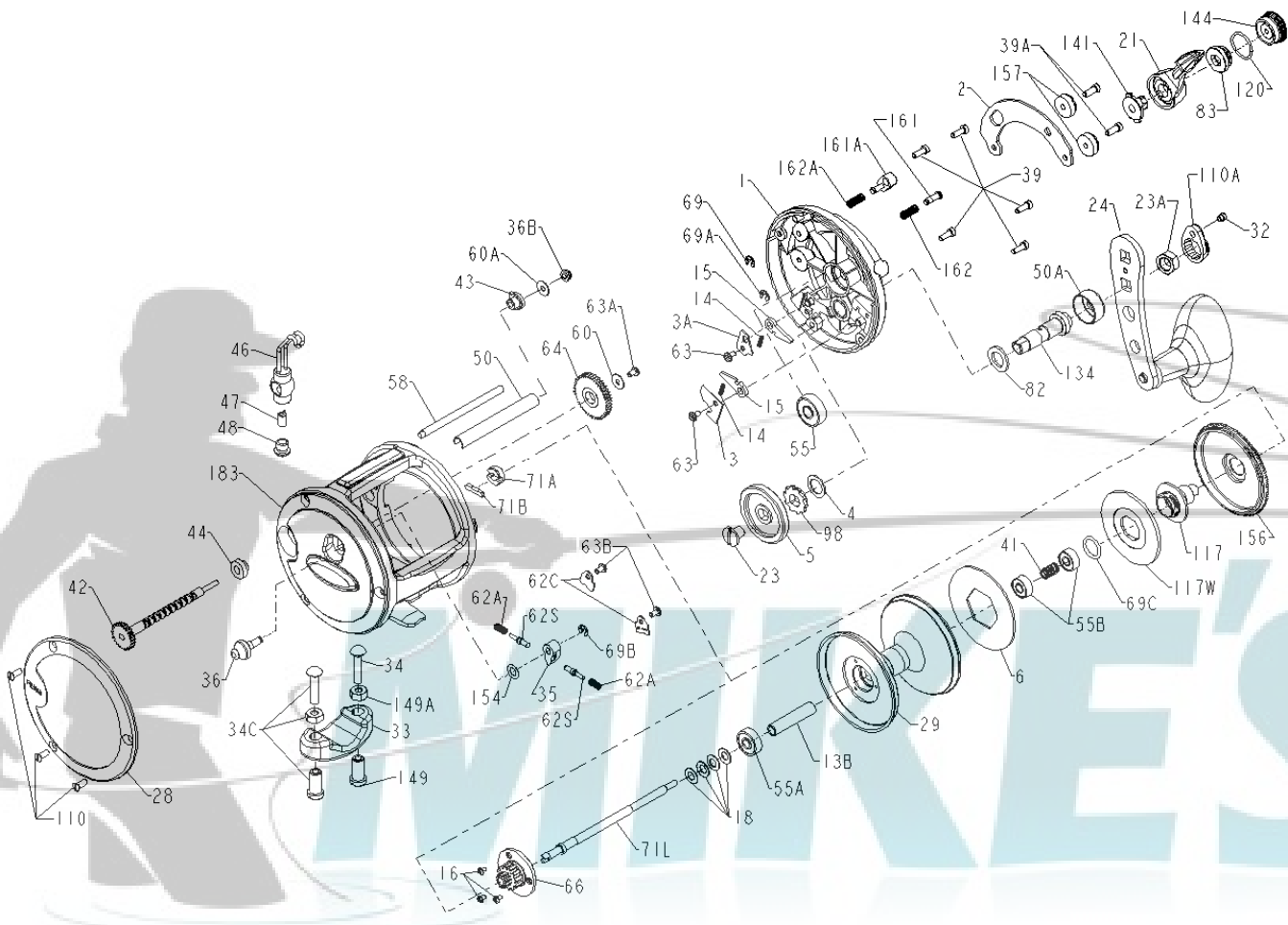

PARTS LIST FOR MODEL 330LD



| KEY NO. | PART NO. | DESCRIPTION |
|---------|-----------|----------------------------------|
| 23 | 023 006CH | Gear Mounting Screw |
| 23A | 023 555 | Handle Nut |
| 24 | 024 330LD | Handle Assembly |
| 28 | 028N330 | Left Side Ring |
| 29L | 029L330LD | Spool |
| 32 | 032 015 | Handle Lock Screw |
| 33 | 033 113 | Rod Clamp |
| * | *033R200 | *Ringed Rod Clamp (Optional) |
| 34 | 034 045 | Clamp Screw Only |
| 34C | 034C045 | Clamp Screw w/Nuts |
| 35 | 035 310N | Click Tongue |
| 36 | 036 330 | Click Button |
| 36B | 036 700 | Worm Shaft Nut |
| 39 | 039 004CH | R.S. Plate Screw (5 req.) |
| 39A | 039 004CH | Spacer Quadrant Screw (2 req.) |
| 41 | 041 320LD | Bearing Spring |
| 42 | 042 330N | Worm |
| 43 | 043 330 | Right Side Worm Bearing |
| 44 | 044 330 | Left Side Worm Bearing |
| 46 | 046 330N | Line Guide Carriage |
| 47 | 047 975 | Pawl |
| 48 | 048 330N | Pawl Cover Screw |
| 50 | 050N330 | Worm Shield |
| 50A | 050 025 | Cover Gear Stud |
| 55 | 026N025 | R.S. Plate Ball Bearing |
| 55A | 055 320LD | L.S. Spool Bearing |
| 55B | 055 116 | Spool Bearing (2 req.) |
| 58 | 058 330 | Line Guide Post |
| 60 | 060 320 | Idler Gear Washer |
| 60A | 060 320 | Worm Bearing Washer |
| 62A | 062A310 | Click Spring (2 req.) |
| 62C | 062C321LH | Click Spring Cover (2 req.) |
| 62S | 062S310 | Click Pin (2 req.) |
| 63 | 063 500S | Dog Bridge Screw (2 req.) |
| 63A | 063 500S | Idler Gear Screw |
| 63B | 063 500S | Click Spring Screw (2 req.) |
| 64 | 064 330 | Idler Gear |
| 66 | 066 320LD | Spool Gear |
| 69 | 069B050 | Strike Button Retaining Ring |
| 69A | 069B050 | Free Spool Button Retaining Ring |
| 69B | 069B600 | Click Tongue Retaining Ring |
| 69C | 069C225 | Retaining Ring |
| 71A | 071A320LD | Bushing |
| 71B | 071B320LD | Key |
| 71L | 071L330LD | Spindle Spool |
| 82 | 082 025 | Handle Shim |
| 83 | 083 225 | Preset Collar |
| 98 | 098 330LD | Main Gear Ratchet |
| 110 | 110 050 | L.S. Ring Screw (3 req.) |
| 110A | 110A555 | Handle Nut Cap |
| 117 | 117 330LD | Pinion Drive Plate |
| 117W | 117W330LD | Washer, Drive Plate |
| 120 | 120 113H | O-Ring |
| 134 | 134 330LD | Gear Stud |
| 141 | 141 225 | Cam Follower |
| 144 | 144 320LD | Preset Knob |
| 149 | 149 045 | Clamp Nut (2 req.) |
| 149A | 149 200 | Hex Nut (2 req.) |
| 154 | 154 117 | Click Shim |
| 156 | 156 225 | Drag Cover |
| 157 | 157 330LD | Quadrant Spacer (2 req.) |
| 161 | 161 025 | Free Spool Button |
| 161A | 161 040 | Strike Button |
| 162 | 162 050 | Free Spool Button Spring |
| 162A | 162 050 | Strike Button Spring |
| 183 | 183N330LD | Frame Assembly |

| KEY NO. | PART NO. | DESCRIPTION |
|---------|-----------|-----------------------------|
| 1 | 001 330LD | Right Side Plate |
| 2 | 002 330LD | Quadrant Ring |
| 3 | 003 330LD | Dog Bridge |
| 3A | 003A330LD | R.S. Dog Bridge |
| 4 | 004 025 | Gear Stud Washer |
| 5 | 005 320LD | Main Gear |
| 6 | 006 025 | Drag Washer HT-100 |
| 13B | 013B320LD | Spool Sleeve |
| 14 | 014 99 | Dog Spring (2 req.) |
| 15 | 015N025 | Dog (2 req.) |
| 16 | 016 975LD | Spool Gear Screw (3 req.) |
| 18 | 018 975LD | Clutch Disc Spring (4 req.) |
| 21 | 021 330LD | Drag Cam Lever |

* Not Shown