

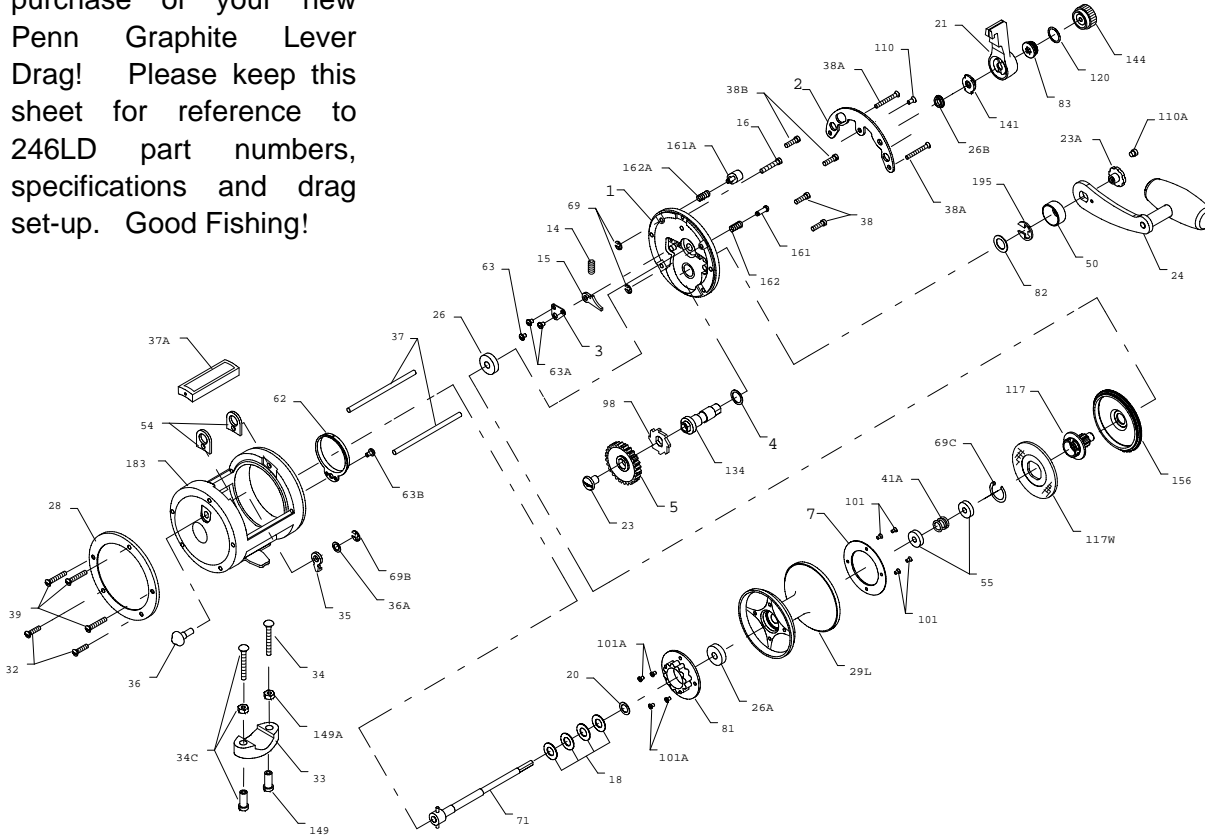

**PARTS LIST FOR MODEL 246LD**

Congratulations on the purchase of your new Penn Graphite Lever Drag! Please keep this sheet for reference to 246LD part numbers, specifications and drag set-up. Good Fishing!



| KEY NO. | DESCRIPTION                 | PART NO. |
|---------|-----------------------------|----------|
| 24      | Handle Assembly             | 024B040P |
| 26      | R.S. Plate Ball Bearing     | 026N040  |
| 26A     | L.S. Spool Ball Bearing     | 026 040  |
| 26B     | R.S. Bushing                | 026 045  |
| 28      | Left Side Ring              | 028 040  |
| 29L     | Spool Assembly              | 029L245  |
| 32      | Lower L.S. Ring Screw (2)   | 032 310  |
| 33      | Rod Clamp                   | 033 113  |
|         | Ringed Rod Clamp            | *033R200 |
| 34      | Rod Clamp Screw (2)         | 034 045  |
| 35      | Click Tongue                | 035 040  |
| 36      | Click Button                | 036N209  |
| 36A     | Click Button Washer         | 036A040  |
| 37      | Frame Post (2)              | 037 040  |
| 37A     | Top Spacer Bar              | 037A246  |
| 38      | Lower R.S. Plate Screw (2)  | 039 005  |
| 38A     | R.S. Post Screw (2)         | 038 040  |
| 38B     | Upper R.S. Plate Screw (2)  | 032 022  |
| 39      | L.S. Post Screw (3)         | 039 009  |
| 41A     | Bearing Spring              | 041A045  |
| 50      | Gear Stud Cover             | 050 040  |
| 54      | Harness Lug (2)             | 054 113  |
| 55      | R.S. Spool Ball Bearing (2) | 055 006  |
| 62      | Click Spring                | 062 040  |
| 63      | Lower Dog Bridge Screw      | 063 349  |
| 63A     | Upper Dog Bridge Screw (2)  | 063 500S |
| 63B     | Click Spring Screw          | 063 500S |
| 69      | Retaining Ring (2)          | 069B050  |
| 69B     | Click Button Retaining Ring | 069B600  |
| 69C     | Retaining Ring              | 069C245  |
| 71      | Spool Spindle Assembly      | 071 040  |
| 81      | Click Ratchet.              | 081 040  |
| 82      | Handle Shim                 | 082 040  |
| 83      | Preset Collar               | 083 245  |
| 98      | Main Gear Ratchet           | 098 040  |
| 101     | Metal Drag Washer Screw (4) | 101 030  |
| 101A    | Click Ratchet Screw (4)     | 101 030  |
| 110     | Quadrant Ring Screw         | 110 050  |
| 110A    | Handle Lock Screw           | 110 060  |
| 117     | Drive Plate Assembly        | 117 245  |
| 117W    | Drive Plate Washer          | 117W245  |
| 120     | O-Ring                      | 120 245  |
| 134     | Gear Stud                   | 134 040  |
| 141     | Lever Cam Follower          | 141 245  |
| 144     | Pre-Set Knob                | 144 040  |
| 149     | Rod Clamp Nut (2)           | 149 045  |
| 149A    | Hex Nut (2 req.)            | 149 200  |
| 156     | Drag Cover                  | 156 245  |
| 161     | Free Spool Button           | 161 025  |
| 161A    | Strike Button Assembly      | 161 040  |
| 162     | Free Spool Button Spring    | 162 050  |
| 162A    | Strike Button Spring        | 162 050  |
| 183     | Frame Assembly              | 183 246  |
| 195     | Gear Stud Retaining Ring    | 195 040  |

| KEY NO. | DESCRIPTION               | PART NO.  |
|---------|---------------------------|-----------|
| 1       | Right Side Plate Assembly | 001 245   |
| 2       | Quadrant Ring             | 002 246   |
| 3       | Dog Bridge                | 003 040   |
| 4       | Gear Stud Washer          | 004 040   |
| 5       | Main Gear                 | 005 045   |
| 7       | Metal Drag Washer         | 007 040   |
| 14      | Dog Spring.               | 014 040   |
| 15      | Dog                       | 015 040   |
| 16      | Top R.S. Plate Screw      | 016 009   |
| 18      | Clutch Disc Spring (4)    | 018 040   |
| 20      | Thrust Washer             | 020 040   |
| 21      | Drag Lever Assembly       | 021 246   |
| 23      | Gear Mounting Screw       | 023 006CH |
| 23A     | Handle Screw Assembly     | 023 114   |

**SPECIFICATIONS AND PRE-SETTING OF DRAG**

| LINE CAPACITY                       | GEAR RATIO | LINE CLASS            | STRIKE SETTING             | FULL OR MAX. SETTING          |
|-------------------------------------|------------|-----------------------|----------------------------|-------------------------------|
| <u>475yds/30 lb</u><br>435M/0,55 mm | 3.9-1      | <u>30 lb</u><br>15 kg | <u>7-10 lb</u><br>3-4,5 kg | <u>12-16 lb</u><br>5,5 - 7 kg |