

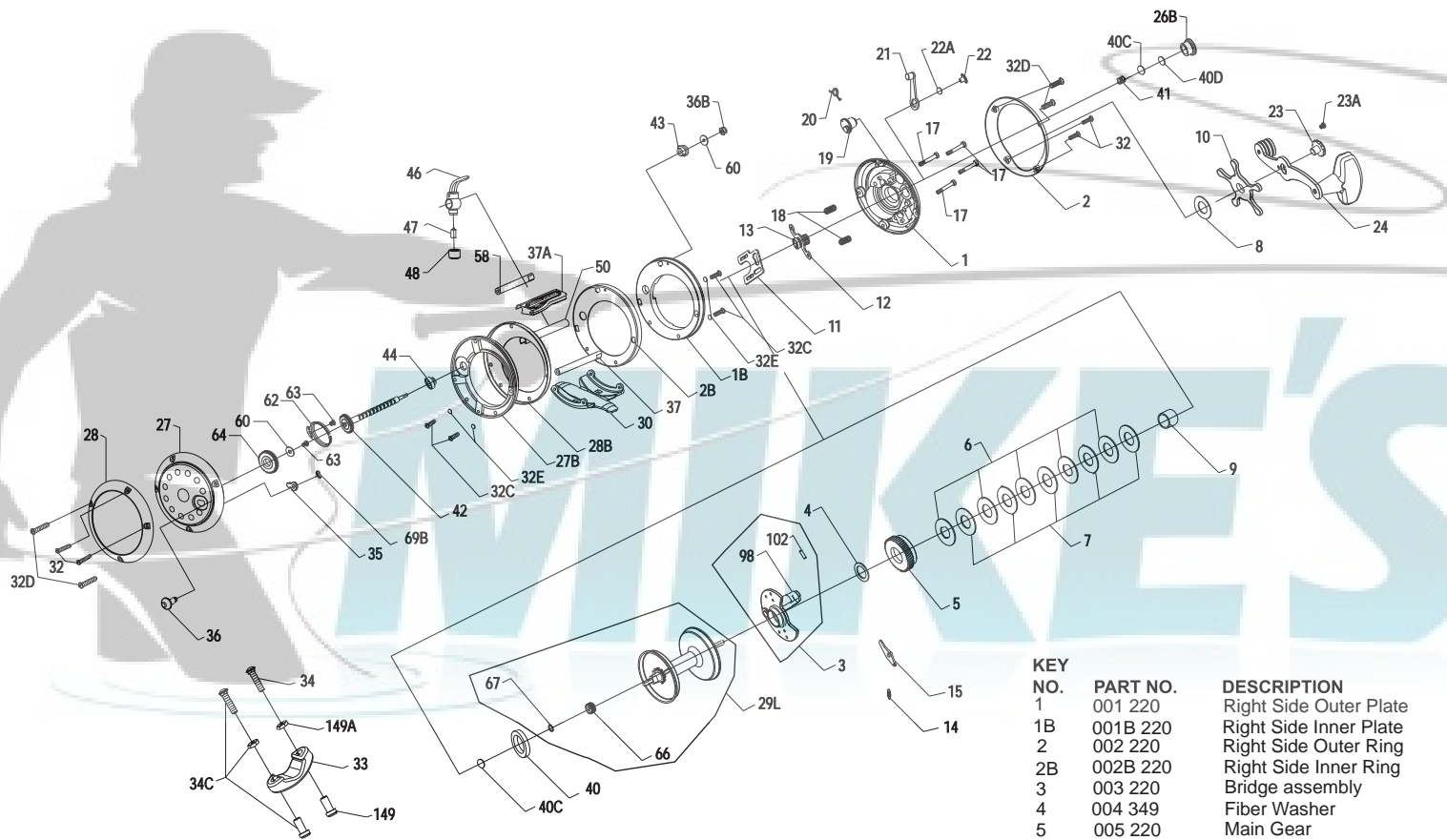

MODEL 220GTO

PARTS LIST FOR MODEL 220GTO



| KEY NO. | PART NO. | DESCRIPTION                   |
|---------|----------|-------------------------------|
| 19      | 019 220  | Eccentric Cam                 |
| 20      | 020 220  | Eccentric Spring              |
| 21      | 021 220  | Eccentric Lever               |
| 22      | 022 220  | Eccentric Screw               |
| 22A     | 022A 220 | Lock Washer                   |
| 23      | 023 220  | Handle Screw                  |
| 23A     | 023A 220 | Handle Lock Screw             |
| 24      | 024 220  | Handle                        |
| 26B     | 026B 220 | Spool Tension Control Cap     |
| 27      | 027 220  | Left Side Outer Plate         |
| 27B     | 027B 220 | Left Side Inner Plate         |
| 28      | 028 220  | Left Side Outer Ring          |
| 28B     | 028B 220 | Left Side Inner Ring          |
| 29L     | 029L 220 | Spool Assembly                |
| 30      | 030 220  | Stand                         |
| 32      | 032 220  | Side Plate Screw(4req.)       |
| 32C     | 032C 220 | Stand Screw(4req.)            |
| 32D     | 032D 220 | Post Screw (4req.)            |
| 32E     | 032E 220 | Flat Washer(4req.)            |
| 33      | 033 220  | Rod Clamp                     |
| 34      | 034 220  | Clamp Screw Only(2 req.)      |
| 34C     | 034C 220 | Clamp Screw w/Nuts (2 req.)   |
| 35      | 035 220  | Click Tongue                  |
| 36      | 036 220  | Click Button                  |
| 36B     | 036B 220 | Worm Shaft Nut                |
| 37      | 037 220  | Frame Post                    |
| 37A     | 037A 220 | Top Spacer Bar                |
| 40      | 040 220  | Ball Bearing                  |
| 40C     | 040C 220 | Metal Thrust Washer(2 req.)   |
| 40D     | 040D 220 | Rubber Thrust Washer          |
| 41      | 041 220  | Right Side Thrust Spring      |
| 42      | 042 220  | Worm                          |
| 43      | 043 220  | Right Side Worm Bushing       |
| 44      | 044 220  | Left Side Worm Bushing        |
| 46      | 046 220  | Line Guide Carriage           |
| 47      | 047 220  | Pawl                          |
| 48      | 048 220  | Pawl Cover Screw              |
| 50      | 050 220  | Worm Shield                   |
| 58      | 058 220  | Slotted Post                  |
| 60      | 060 220  | Idler Gear Washer(2 req.)     |
| 62      | 062 220  | Click Spring                  |
| 63      | 063 220  | Click Spring Screw(2 req.)    |
| 64      | 064 220  | Idler Gear                    |
| 66      | 066 220  | Spool Gear                    |
| 67      | 067 220  | Spool Gear Lock Ring          |
| 69B     | 069B 220 | Retaining Ring (Click Button) |
| 98      | 098 220  | Gear Sleeve                   |
| 102     | 102 220  | Gear Sleeve Pin               |
| 149     | 149 220  | Clamp Nut Only (2 req.)       |
| 149A    | 149A 220 | Hex Nut Only (2 req.)         |

| KEY NO. | PART NO. | DESCRIPTION                  |
|---------|----------|------------------------------|
| 1       | 001 220  | Right Side Outer Plate       |
| 1B      | 001B 220 | Right Side Inner Plate       |
| 2       | 002 220  | Right Side Outer Ring        |
| 2B      | 002B 220 | Right Side Inner Ring        |
| 3       | 003 220  | Bridge assembly              |
| 4       | 004 349  | Fiber Washer                 |
| 5       | 005 220  | Main Gear                    |
| 6       | 006 320  | Friction Drag Washer(5 req.) |
| 7       | 007C 220 | Metal Drag Washer(Set of 5.) |
| 8       | 008 220  | Tension spring               |
| 9       | 009 220  | Spacing Sleeve               |
| 10      | 010 220  | Star Drag                    |
| 11      | 011 220  | Eccentric Jack               |
| 12      | 012 220  | Pinion Yoke                  |
| 13      | 013 220  | Pinion Gear                  |
| 14      | 014 220  | Dog Spring                   |
| 15      | 015 220  | Dog                          |
| 17      | 017 220  | Bridge Screw(4 req.)         |
| 18      | 018 220  | Clutch Spring(2 req.)        |