

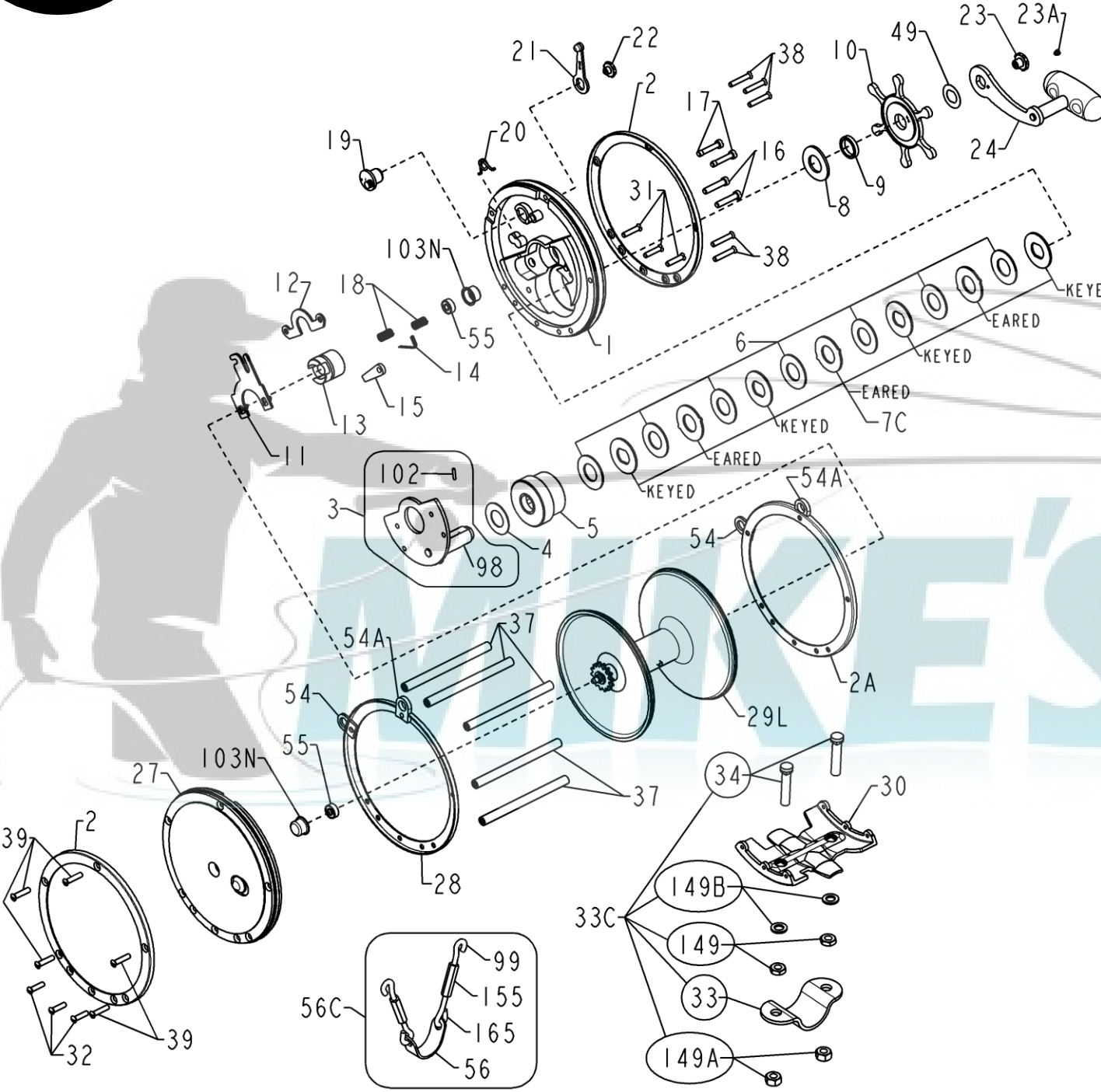

PARTS LIST FOR SENATOR MODEL 116L
REEL ASSEMBLY NO 1151086



| KEY NO. | 116L PENN STYLE NO. | 116L ORDER PART NO. | DESCRIPTION |
|---------|---------------------|---------------------|--|
| 1 | 001 116 | 1180459 | Right Side Plate |
| 2 | 002 116o (2 req) | 1180624 | Outer Right Side Ring |
| 2A | 002 116i | 1180623 | Inner Side Ring |
| 3 | 003 116 | 1180710 | Bridge w/Sleeve |
| 4 | 004 116 | 1180767 | Fiber Washer |
| 5 | 005 116 | 1180850 | Main Gear |
| 6 | 006 116 (7 req) | 1180912 | FiberDrag Washer |
| 7C | 007C116 | 1181045 | Metal Drag Washer Set (7 pcs) |
| 8 | 008 116 | 1181069 | Tension Spring Washer |
| 9 | 009 116 | 1181155 | Spacing Sleeve |
| 10 | 010 116 | 1181186 | Star Drag Wheel |
| 11 | 011 116 | 1181236 | Eccentric Jack |
| 12 | 012 116 | 1181263 | Pinion Yoke |
| 13 | 013 116 | 1181325 | Pinion |
| 14 | 014 116 | 1181397 | Dog Spring |
| 15 | 015 116 | 1181440 | Dog |
| 16 | 016 114 (2 req) | 1181572 | Lower Bridge Screw |
| 17 | 017 114 (2 req) | 1181596 | Upper Bridge Screw |
| 18 | 018 114 (2 req) | 1181618 | Clutch Spring |
| 19 | 019 115 | 1181665 | Eccentric |
| 20 | 020 114 | 1181766 | Eccentric Spring |
| 21 | 021 116 | 1181846 | Eccentric Lever |
| 22 | 023 060 | 1181935 | Eccentric Screw |
| 23 | 023 116 | 1181946 | Handle Screw |
| 23A | 110 060 | 1184437 | Handle Lock Screw |
| 24 | 024 116 | 1182002 | Handle Assembly |
| 27 | 027 116 | 1182199 | Left Side Plate Sub Assembly (Includes Click Assembly) |
| 28 | 028 116i | 1182374 | Inner Left Side Ring |
| 29L | 029L116 | 1182515 | Spool Assembly |
| 30 | 030 116 | 1182624 | Stand |
| 31 | 039 012 (3 req) | 1183184 | Right Side Stand Screw |
| 32 | 032 021 (3 req) | 1182713 | Left Side Stand Screw |
| 33 | 033 116 | 1182756 | Rod Clamp |
| * | *033 130ST | *1182758 | *Ringed Rod Clamp (Optional) |
| 33C | 033C116 | 1192681 | Clamp Screws w/Nuts Kit |
| 34 | 034 130 (2 req) | 1182805 | Clamp Screw |
| 37 | 037 116 (5 req) | 1183070 | Frame Post |
| 38 | 039 013 (5 req) | 1183185 | Right Side Post Screw |
| 39 | 039 012 (5 req) | 1183184 | Left Side Post Screw |
| 49 | 049 116 | 1183732 | Handle Spacer |
| 54 | 054 114 (2 req) | 1183857 | Harness Lug |
| 54A | 054 116 (2 req) | 1183858 | Harness Lug |
| 55 | 055 116 (2 req) | 1183882 | Ball Bearing |
| 56 | 056 116 | 1183901 | Rod Brace |
| 56C | 056C116 | 1183910 | Rod Brace Kit |
| * | *056P117 | *1183913 | *Rod Brace Pad |
| 98 | 098 116 | 1184336 | Gear Sleeve |
| 99 | 099 116 (2 req) | 1184402 | Hook Screw L.H. Thread |
| 102 | 102 117 | 1192232 | Gear Sleeve Pin |
| 103N | 103N116 (2 req) | 1289830 | Bearing Cup |
| 149 | 149 116L (2 req) | 1184705 | Clamp Screw Hex Nut (Light) |
| 149A | 149 116H (2req) | 1184704 | Clamp Hex Nut (Heavy) |
| 149B | 149A130 (2req) | 1184707 | Washer (33C Clamp Kit) |
| * | *154 117 (as req) | *1184721 | *Spool Shim |
| 155 | 155 116 (2 req) | 1184725 | Turnbuckle |
| 156 | N/A | N/A | Drag Cover |
| 165 | 165 116 (2 req) | 1184798 | Hook Screw R.H. Thread |
| * | Not Shown | | |