

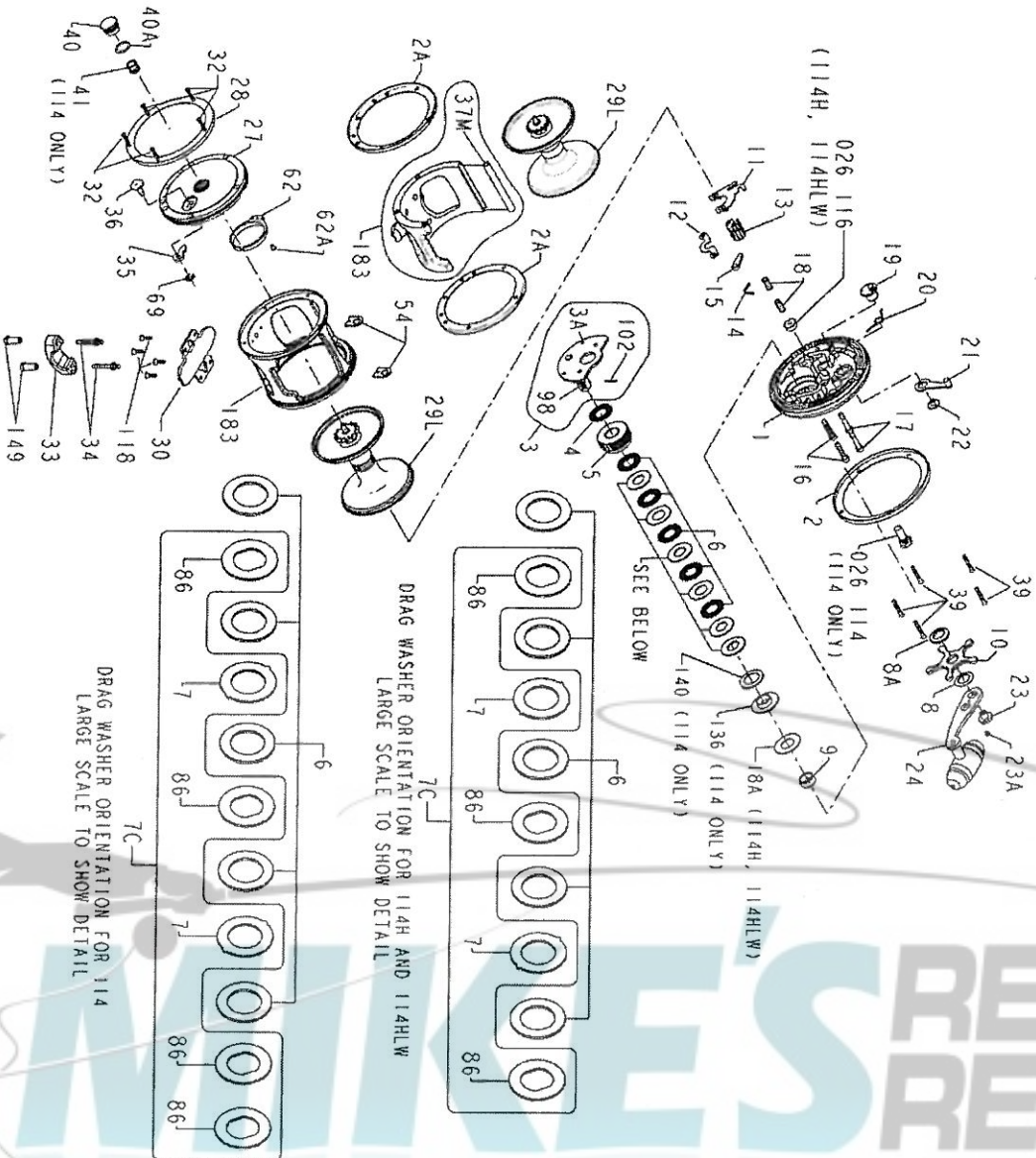

PARTS LIST FOR MODEL 114, 114H, 114HLW



KEY	114	114H	114HLW	DESCRIPTION
NO.	PART NO.	PART NO.	PART NO.	
1	001 114	001 114H	001 114HL	Right Side Plate
2	002N114	002N114H	002N114HL	Right Side Ring
2A	003 114	003 114H	N/A	Inner Ring (2 Req)
3	003 114	003 114H	003 114HL	Bridge Assembly
3A	003 114-1	003 114H-1	003 114HL-1	Bridge Sub-Assembly
4	004 114	004 114	004 114	Fiber Washer
5	005 114	005 114	005 114	Main Gear
6	006 114	006 114	006 114	Fiber Drag Washer (5 req)
7	007 114	007 114	007 114	Metal Ear Washer (2 req)
7C	007C114	007C115	007C115	Metal Drag Washer Set
8	008 114	008 114	008 114	Tension Spring
8A	008 114	008 114	008 114	Spacing Sleeve
9	009N114	009 114H	009 114HL	Star Drag Wheel
10	010 114	010 114	010 114	Eccentric Jack
11	011 114	011 114	011 114	Pinion Yoke
12	012 114	012 114	012 114	Pinion
13	013 114	013 114H	013 114HL	Dog Spring
14	014 114	014 114	014 114	Dog
15	015 114	015 114H	015 114HL	Lower Bridge Screw (2 req)
16	016 114	016 114	016 114	Upper Bridge Screw (2 req)
17	017 114	017 114	017 114	Clutch (Yoke) Spring (2 req)
18	018 114	018 114	018 114	Spring Disc
18A	N/A	018 114H	018 114HL	Eccentric
19	019 114	019 114	019 114	Eccentric Spring
20	020 114	020 114	020 114	Eccentric Lever
21	021 114	021 114	021 114	Eccentric Screw
22	023 060	023 060	023 060	Handle Screw
23	023 116	023 116	023 116	Handle Lock Screw
23A	110 060	110 060	110 060	Handle
24	024 057	024 057	024 057	R.S. Bearing
26	026 114	026 114	026 114	Left Side Ring
27	027 114	027N114H	027N114HL	Left Side Ring
28	002N114	002N114	002N114	Spool Assembly
28L	029L114	029L114HL	029L114HLW	Stand
30	030 114HL	030 114HL	030 114HL	L.S. Screw (5 req)
32	032 021	032 021	032 021	Rod Clamp
33	033 340	033 340	033 340	Rod Clamp
*	*033R114	*033R114	*033R114	*Ringed Rod Clamp (Optional)
34	034 010KG	034 010KG	034 010KG	Rod Clamp Screw (2 req)
35	035 114	035 114	035 114	Click Tongue
36	036 114H	036 114H	036 114H	Click Button
+37M	+037M114	+037M114	N/A	+Frame Post
39	039 012	039 012	039 012	R.S. Plate Screw (5 req)
40	040 114	040 114HL	040 114HL	Left Side Bearing
40A	N/A	120 114HL	120 114HL	Left Side Bearing O-Ring
41	041 114	N/A	N/A	Bearing Spring
54	054 114	054 114	054 114	Harness Lug (2 req)
62	062 114	062 114	062 114	Click Spring
62A	063 209	063 209	063 209	Click Spring Screw
63A	063 209	063 209	063 209	Retaining Ring
69	069B600	069B600	069B600	Metal Keyed Washer
86	086 114L (4)	086 115L (3)	086 115L (3)	Gear Sleeve
98	098 114	098 114	098 114	Sleeve Pin
102	102 114	102 114	102 114	Stand Screws (4 req)
118	118 080	118 080	118 080	Pressure Plate Washer
136	136 114	N/A	N/A	Felt Washer
140	140 114	N/A	N/A	Rod Clamp Nut (2 req)
149	149 045	149 045	149 045	Frame
+183	+183 114	+183 114H	183 114HLWT	

* = Not Shown
+ = When replacing an older frame (that uses a shield) you must also order 37M114 Frame Post.
N/A = Not Applicable

