

25 POWER GATOR BLACK 12 VOLT

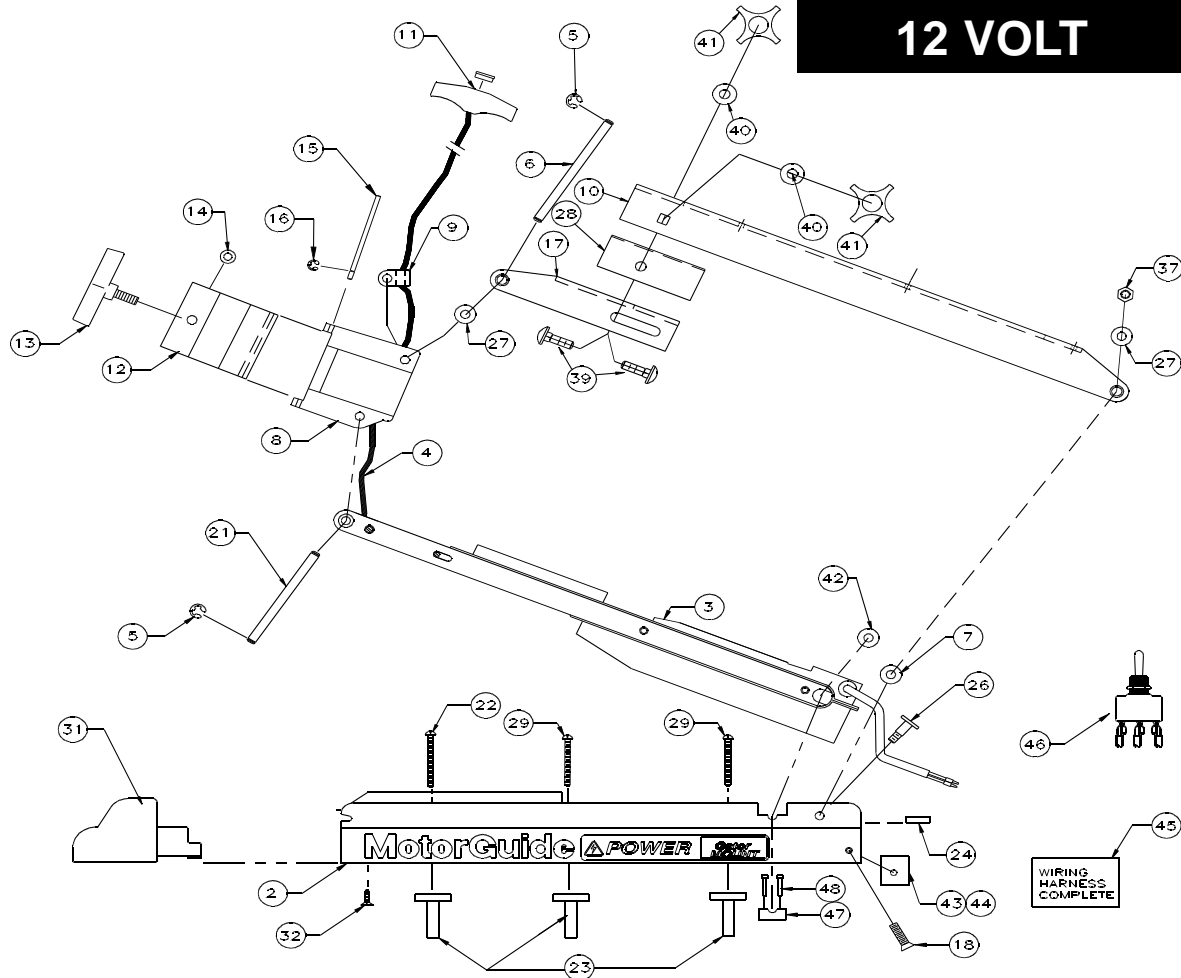

ITEM #	PART#	DESCRIPTION	ITEM #	PART#	DESCRIPTION
1	MGA060,,BX1	POWER GATOR MT.	25	RK107-02	PIN, BOW ARM/DECK CHANNEL
2	RK010-12	DECK CHANNEL - POWER GATOR	26	RK134-01 (2)	BOLT - SHOULDER
3	RK309-04	BOW ARM - POWER GATOR	27	RK171-02 (4)	WASHER, NYLON .062" THK.
4	AK043-04	ROPE	28	RK079-01	INSERT CLUTCH
5	BK046-01 (4)	E-RING, 3/8"	29	XT136-01 (4)	DECK MOUNTING SCREW, SHORT
6	RK102-01	PIN, BRACKET/CLUTCH CHANNEL	30		
7	AK171-02 (2)	WASHER, NYLON .026" THK.	31	RK034-03	DECKET - POWER GATOR
8	RK011-01	BRACKET	32	AK137-01 (2)	SCREW, DECKET
9	RK021-01	ROPE BUSHING, NYLON	33		
10	RK308-03	TOP CHANNEL	34		
11	AK072-01	ROPE HANDLE WITH BUTTON	35		
12	RK012-01	DOOR, BRACKET	36		
13	RK082-01	KNOB, BAR	37	KM098-01 (2)	LOCK NUT - 5/16 - 24
14	RK171-03	WASHER, NYLON	38		
15	RK104-01	PIN, DOOR/BRACKET	39	RK025-03 (2)	BOLT - 3/8 - 16
16	AK046-01	E-RING 3/16"	40	DK011-01 (2)	WASHER - CLAMP BOLT - SW
17	RK361-01	CLUTCH CHANNEL	41	RK082-03 (2)	CLUTCH KNOBS
18	RK133-01 (2)	SCREW - # 10 - 24 X 3/4 FLAT HEAD	42	RK171-05 (2)	WASHER - 5/8 X 1"
19	RK106-02	PIN - LOCKSLIDE - REAR	43	RK023-02	BOW ARM STOP RIGHT
20			44	RK023-01	BOW ARM STOP LEFT
21	RK107-01	PIN, BRACKET/BOW ARM	45	RK157-01	WIRING HARNESS COMPL. W/ SWITCHES
22	XT136-02 (2)	DECK MOUNTING SCREW, LONG	46	RK153-01 (2)	CONTROL SWITCH
23	AK015-01 (6)	MOUNTING ISOLATOR	47	RK036-01 (2)	BOW ARM CLAMP
24	RK016-02	RUBBER REST - POWER GATOR	48	RK133-02 (4)	CLAMP BOLTS

FEATURES

- Built-in breakaway clutch
- Hinged door for easy removal
- Recessed prop wrench pocket

SPECIFICATIONS

Operating voltage (12VDC)
 Amp Draw 5 to 20 amps
 Circuit Protection Internal auto reset breaker

CONSTRUCTION

- Heavy-duty extruded aluminum

ENVIRONMENT

- Freshwater

BASE DIMENSIONS

- Length - 21.5"
- Width - 5"
- Mounting hole size - 1/4"
- Length fully stowed - 43 1/4"

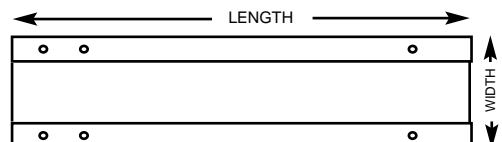

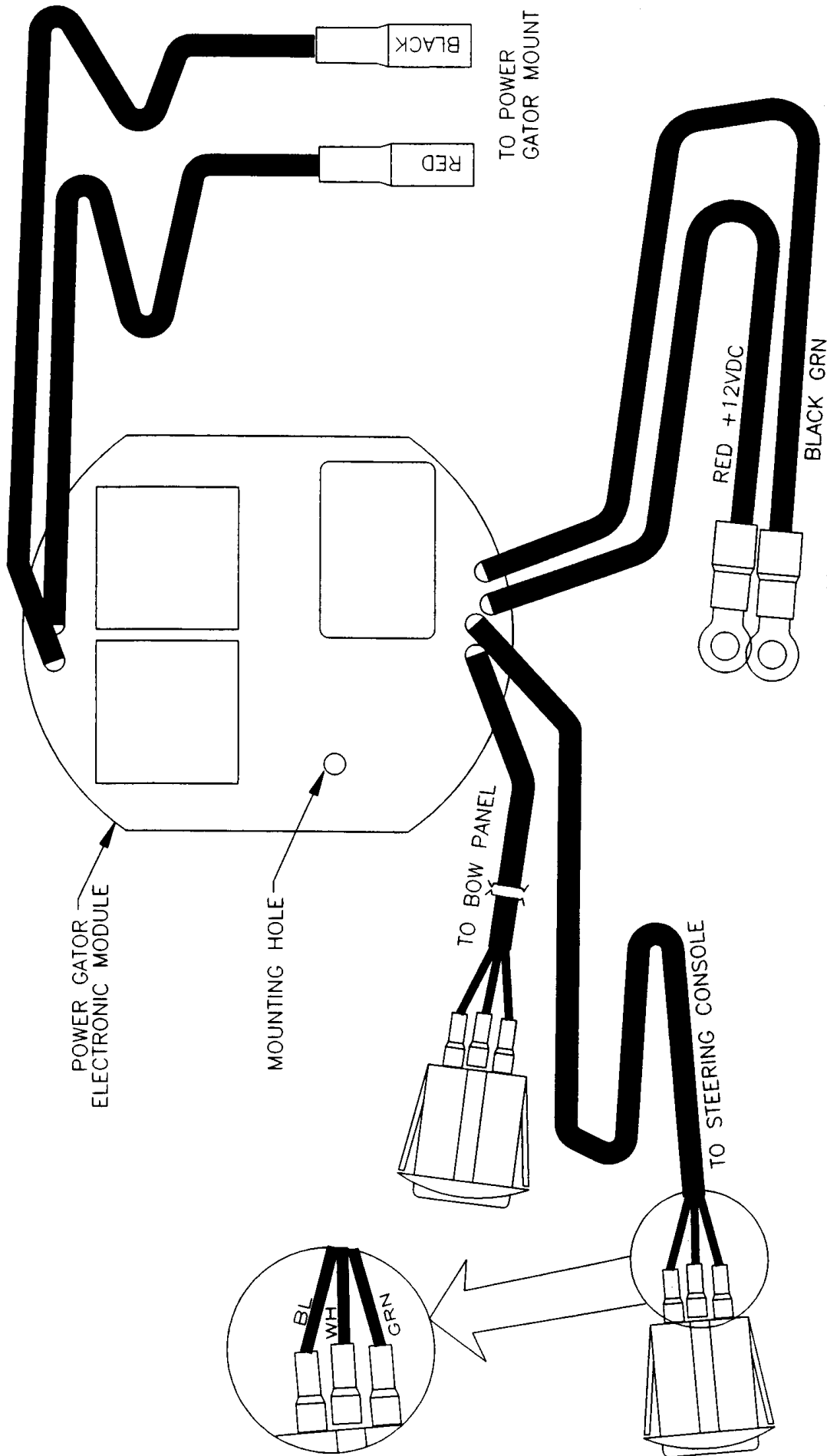

FIG #2