

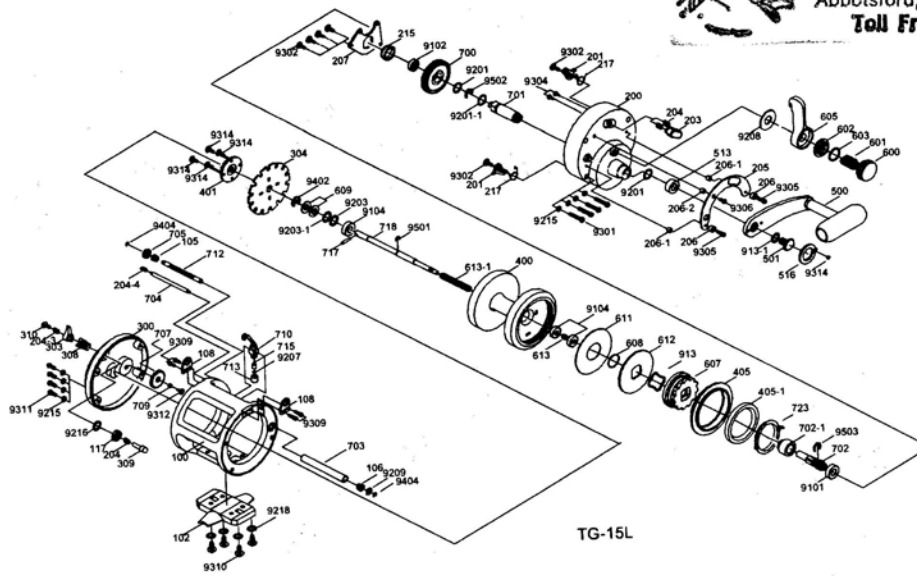

MIKE'S REEL REPAIR
 #108 - 31060 Peardonville Road
 Abbotsford, B.C., Canada V2T 8K5
 Toll Free 1-888-404-1119



TG15L SPEED SPARE PARTS LIST

| KEY NO. | PARTS NO. | PARTS NAMES | KEY NO. | PARTS NO. | PARTS NAMES |
|---------|-----------------|--------------------------|---------|-----------------|--------------------------------|
| 100 | 11100032-04003 | MAIN BODY | 701 | 11701015-06001 | DRIVE GEAR SHAFT |
| 102 | 11102007-04001 | BODY FOOT | 702 | 11702024-06005 | PINION GEAR |
| 105 | 11105003-01 | WORM SHAFT BUSHING | 702-1 | 11702025-06001 | PINION GEAR |
| 105-1 | 11105004-01 | WORM SHAFT BUSHING | 703 | 11703006-03907 | LEVER WIND GUARD |
| 108 | 11108007-06 | HANGER | 704 | 11704012-03907 | STABILIZER BAR |
| 117 | 11117004-13 | CLICK PAWL LOCKNUT | 705 | 11705008-06 | WORM SHAFT GEAR |
| 200 | 1120003704003 | RIGHT SIDE PLATE ASSY. | 707 | 11707003-01 | MEDIUM TRANSMISSION GEAR |
| 201 | 11201009-06001 | ANTI-REVERSE PAWL | 709 | 11709004-03 | TRANSMISSION GEAR BUSHING |
| 203 | 11203002-01001 | CONTROL PIN | 710 | 1171001406X | LINE GUIDE ASSY. |
| 204 | 11204002-06 | COMPRESSION SPRING | 712 | 11712006-03907 | WORM SHAFT |
| 204-3 | 11204005-06002 | COMPRESSION SPRING | 713 | 11713001-03907 | PAWL CAP |
| 204-4 | 11204006-06 | COMPRESSION SPRING | 715 | 11715003-06 | LINE GUIDE PAWL |
| 205 | 11205005-06004 | DECORATION PLATE | 717 | 11717003-06 | STOPPER PIN |
| 206 | 11206001-03001 | LEVER DRAG STOPPER CAP | 718 | 11718017-06001 | MAIN SHAFT |
| 206-1 | 11206002-03907 | LEVER DRAG STOPPER CAP | 723 | 11723001-01001 | SILENT SPRING |
| 206-2 | 11206005-03001 | LEVER DRAG STOPPER CAP | 723 | 1173001-05907 | SPRING WASHER |
| 207 | 11207013-04001 | HOLD PLATE | 913 | 11913002-06001 | SPRING WASHER |
| 215 | 11215004-03 | HOLD PLATE BUSHING | 913-1 | 11913002-06001 | BALL BEARING |
| 217 | 11217004-06001 | ANTI-REVERSE PAWL SPRING | 9101 | 01081605-6 | BALL BEARING |
| 300 | 11300031-349122 | LEFT SIDE PLATE | 9102 | 01071304-6 | BALL BEARING |
| 303 | 11303009-04002 | CLICK BUTTON | 9104 | 01061505-6 | WASHER |
| 304 | 11304005-16 | CLICK PAWL | 9201 | 0212x15x0.5-3 | WASHER |
| 308 | 11308002-06002 | CLICK TONGUE BUSHING | 9201-1 | 0212x15x0.7-3 | WASHER |
| 309 | 11309001-261 | CLICK PIN | 9203 | 026.05x9x0.5-6 | WASHER |
| 310 | 11310001-06002 | CLICK PIN SCREW | 9203-1 | 026.05x9x0.2-3 | WASHER |
| 400 | 11400036-04004 | SPOOL | 9207 | 022x4.9x0.2-3 | LINE GUIDE PAWL WASHER |
| 401 | 11401004-12 | CLICK GEAR | 9208 | 0210.1x23.8x1-9 | LEVER DRAG WASHER |
| 405 | 11405014-11 | SPOOL COVER | 9209 | 025.1x10.5x2-6 | LEVER WIND GUARD WASHER |
| 405-1 | 11405013-07001 | WATER PROOF DRAG SEAL | 9215 | 023.1x5.9x1-1 | WASHER |
| 500 | 11500017067 | HANDLE ARM | 9216 | 028.1x12x0.5-1 | WASHER |
| 501 | 11501009-26 | HANDLE NUT | 9218 | 024.6x8x0.2-6 | WASHER |
| 513 | 11513009-06 | HANDLE COVER | 9301 | 03113.0x18-61 | RIGHT SIDE PLATE SCREW |
| 516 | 11516005-06 | HANDLE NUT HOLD PLATE | 9302 | 03312.6x5-61 | ANTI-REVERSE PAWL SCREW |
| 600 | 11600013-03X | DRAG KNOB | 9304 | 03325.2x2x5-61 | CONTROL PIN SCREW |
| 601 | 11601001-06 | COMPRESSION SPRING | 9305 | 03112.6x10-61 | SIDE PLATE SCREW |
| 602 | 11602001-05001 | ADJUST BLOCK | 9306 | 03213x8-61003 | SIDE PLATE SCREW |
| 603 | 11603001-07 | O RING | 9309 | 03113x5-61 | HANGER SCREW |
| 605 | 11605010-04002 | LEVER DRAG | 9310 | 03614x10.5-617 | BODY FOOT SCREW |
| 607 | 11607009-06002 | PINION GUARD | 9311 | 03113.0x8-61 | LEFT SIDE PLATE SCREW |
| 608 | 11608003-06 | DRAG WASHER RETAINER | 9312 | 03312.6x7.5-61 | MEDIUM TRANSMISSION GEAR SCREW |
| 609 | 11609007-05907 | MAIN SHAFT SPRING WASHER | 9314 | 03212.6x5.5-61 | HANDLE NUT/CLICK PAWL SCREW |
| 611 | 11611009-067 | DRAG WASHER | 9404 | 12900001-06 | WORM SHAFT "E" RETAINER |
| 612 | 11612010-061 | KEY WASHER | 9402 | 11900001-06 | "E" RETAINER |
| 613 | 11613004-06 | COMPRESSION SPRING | 9503 | 11901004-05907 | PINION GEAR "C" RETAINER |
| 613-1 | 11613006-06 | COMPRESSION SPRING | 9502 | 11901003-06001 | "C" RETAINER |
| 700 | 11700018-06005 | DRIVE GEAR | 9501 | 11901006-06 | MAIN SHAFT "C" RETAINER |