

# MITCHELL AVOCET® IV

## Model AVRZ-500UL AVRZT-500UL AVRZ-1000 AVRZT-1000

| NO. | PARTS DESCRIPTION                      | AVRZ500UL | AVRZT500UL | AVRZ1000 | AVRZT1000 |
|-----|--|-----------|------------|----------|-----------|
| 19  | ROLLERS WASHER                         | 1276876   | 1276876    | 1276876  | 1276876   |
| 20  | ROLLER BUSHING                         | 1277325   | NA         | 1277325  | NA        |
| 20  | ROLLER BALL BEARING                    | NA        | 1277326    | NA       | 1277326   |
| 21  | LINE ROLLER                            | 1276877   | 1276877    | 1276877  | 1276877   |
| 22  | ROLLER METAL WASHER                    | 1276878   | 1276878    | 1276878  | 1276878   |
| 23  | RAIL ARM                               | 1347534   | 1347545    | 1347553  | 1347562   |
| 24  | ROLLER SCREW                           | 1276884   | 1276884    | 1276884  | 1276884   |
| 25  | ONE WAY CLUTCH WASHER                  | 1276885   | 1276885    | 1276885  | 1276885   |
| 26  | ONE WAY CLUTCH COVER SCREW             | 1276886   | 1276886    | 1276886  | 1276886   |
| 27  | ONE WAY CLUTCH COVER                   | 1347535   | 1347535    | 1347554  | 1347554   |
| 28  | PINION UP BALL BEARING                 | 1276888   | 1276888    | 1276888  | 1276888   |
| 29  | ONE WAY CLUTCH SUPPORT                 | 1276889   | 1276889    | 1276889  | 1276889   |
| 30  | ONE WAY CLUTCH ASSY (including sleeve) | 1276891   | 1276891    | 1276891  | 1276891   |
| 31  | A/R PULLING SPRING                     | 1276893   | 1276893    | 1276893  | 1276893   |
| 32  | PINION DOWN BALL BEARING               | 1277327   | 1277327    | 1277327  | 1277327   |
| 33  | PINION GEAR                            | 1277328   | 1277328    | 1277328  | 1277328   |
| 34  | A/R SPRING                             | 1277329   | 1277329    | 1277329  | 1277329   |
| 35  | A/R SHAFT                              | 1277330   | 1277330    | 1277330  | 1277330   |
| 36  | A/R SWITCH                             | 1276899   | 1276899    | 1276899  | 1276899   |
| 37  | A/R SWITCH SCREW                       | 1276900   | 1276900    | 1276900  | 1276900   |
| 38  | OSCILLATION GEAR                       | 1277332   | 1277332    | 1277333  | 1277333   |
| 40  | OSCILLATION GEAR SCREW                 | NA        | NA         | 1277335  | 1277335   |
| 41  | SLIDER                                 | 1277336   | 1277336    | 1277337  | 1277337   |
| 42  | SLIDER SCREW                           | 1277338   | 1277338    | 1277339  | 1277339   |
| 43  | SLIDER CLIP                            | 1277340   | 1277340    | 1277340  | 1277340   |
| 44  | SLIDER CLIP SCREW                      | 1277341   | 1277341    | 1277341  | 1277341   |
| 45  | MAIN BODY BUSHING                      | 1277342   | NA         | 1277342  | NA        |
| 45  | MAIN BODY BALL BEARING                 | NA        | 1277343    | NA       | 1277343   |
| 46  | MAIN GEAR                              | 1277344   | 1277344    | 1277344  | 1277344   |
| 47  | SIDE COVER BALL BEARING                | 1276913   | 1276913    | 1276913  | 1276913   |
| 48  | MAIN GEAR WASHER                       | 1277355   | 1277355    | 1277355  | 1277355   |
| 49  | SIDE COVER                             | 1347536   | 1347546    | 1347555  | 1347563   |
| 50  | SIDE COVER SCREW                       | 1276915   | 1276915    | 1276915  | 1276915   |
| 50A | SIDE COVER SCREW1                      | 1277356   | 1277356    | NA       | NA        |
| 52  | HANDLE ASSY                            | 1347537   | 1277358    | 1347537  | 1277358   |
| 53  | MAIN BODY (including trim)             | 1347538   | 1347547    | 1347556  | 1347564   |
| 54  | O RING                                 | 1277376   | 1277376    | 1277376  | 1277376   |
| 55  | HANDLE RETRIEVE WASHER                 | 1277377   | 1277377    | 1277377  | 1277377   |
| 56  | HANDLE CAP                             | 1347539   | 1277379    | 1347539  | 1277379   |
| 57  | SMALL REAR COVER                       | 1347540   | 1347548    | 1347557  | 1347565   |
| 58  | REAR COVER                             | 1347541   | 1347549    | 1347558  | 1347566   |

MIT SP AVOCET RZ500UL RZT500UL RZ1000 RZT1000 00

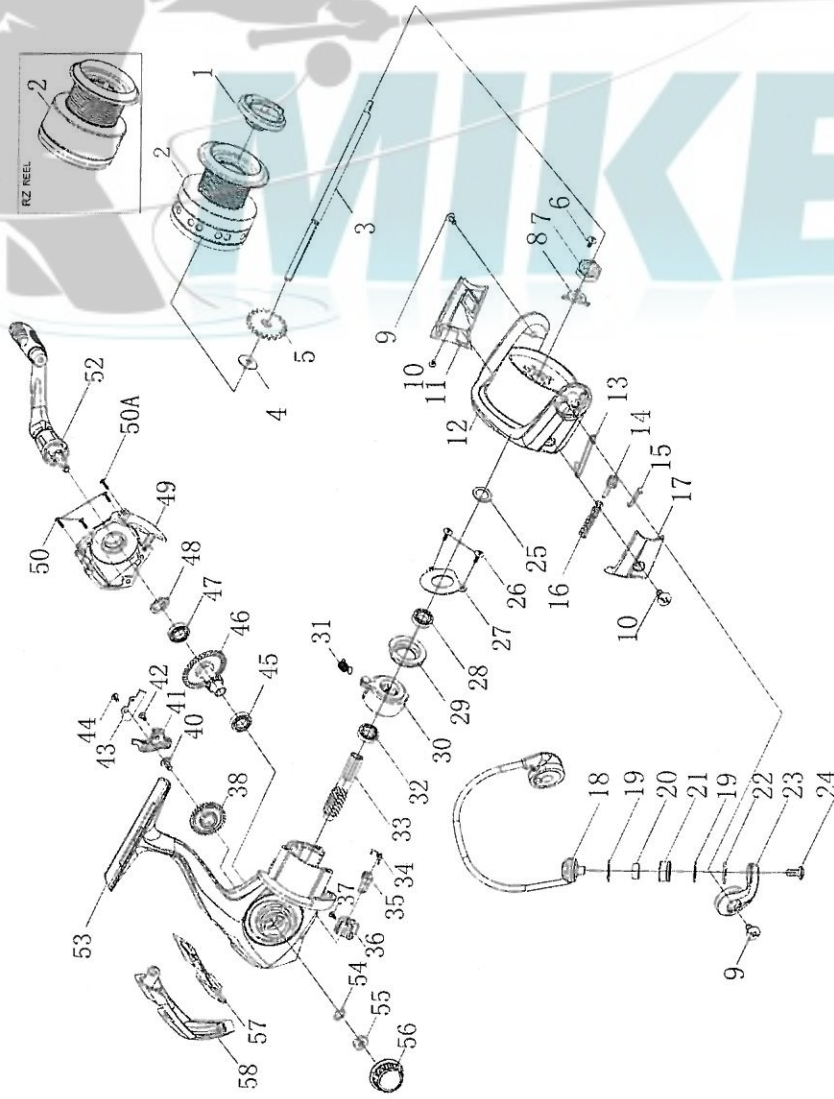

| NO. | PARTS DESCRIPTION      | AVRZ500UL | AVRZT500UL | AVRZ1000 | AVRZT1000 |
|-----|------------------------|-----------|------------|----------|-----------|
| 1   | DRAG KNOB ASSY         | 1315690   | 1315690    | 1315690  | 1315690   |
| 2   | SPOOL ASSY             | 1347531   | 1347542    | 1347550  | 1347559   |
| 3   | MAIN SHAFT             | 1276817   | 1276817    | 1277320  | 1277320   |
| 4   | MAIN SHAFT WASHER      | 1277321   | 1277321    | 1277323  | 1277323   |
| 5   | MAIN SHAFT RATCHET     | 1277322   | 1277322    | 1277324  | 1277324   |
| 6   | HEX NUT RETAINER SCREW | 1276823   | 1276823    | 1276823  | 1276823   |
| 7   | ROTOR NUT              | 1276824   | 1276824    | 1276824  | 1276824   |
| 8   | ROTOR RETAINER PLATE   | 1276825   | 1276825    | 1276825  | 1276825   |
| 9   | ROTOR ARM SCREW        | 1276826   | 1276826    | 1276826  | 1276826   |
| 10  | BAIL ARM COVER SCREW   | 1276827   | 1276827    | 1276827  | 1276827   |
| 11  | ROTOR WEIGHT COVER     | 1276829   | 1276828    | 1276830  | 1276831   |
| 12  | ROTOR ASSY             | 1347532   | 1347543    | 1347551  | 1347560   |
| 13  | BAIL TRIP LEVER        | 1276844   | 1276844    | 1276846  | 1276846   |
| 14  | BAIL ARM SPRING GUIDE  | 1276854   | 1276854    | 1276854  | 1276854   |
| 15  | BAIL ARM SPRING SHAFT  | 1276855   | 1276855    | 1276856  | 1276856   |
| 16  | BAIL ARM SPRING        | 1276857   | 1276857    | 1276858  | 1276858   |
| 17  | ROTOR ARM COVER        | 1276860   | 1276861    | 1276862  | 1276863   |
| 18  | BAIL WIRE ASSY         | 1347533   | 1347544    | 1347552  | 1347561   |