

4470

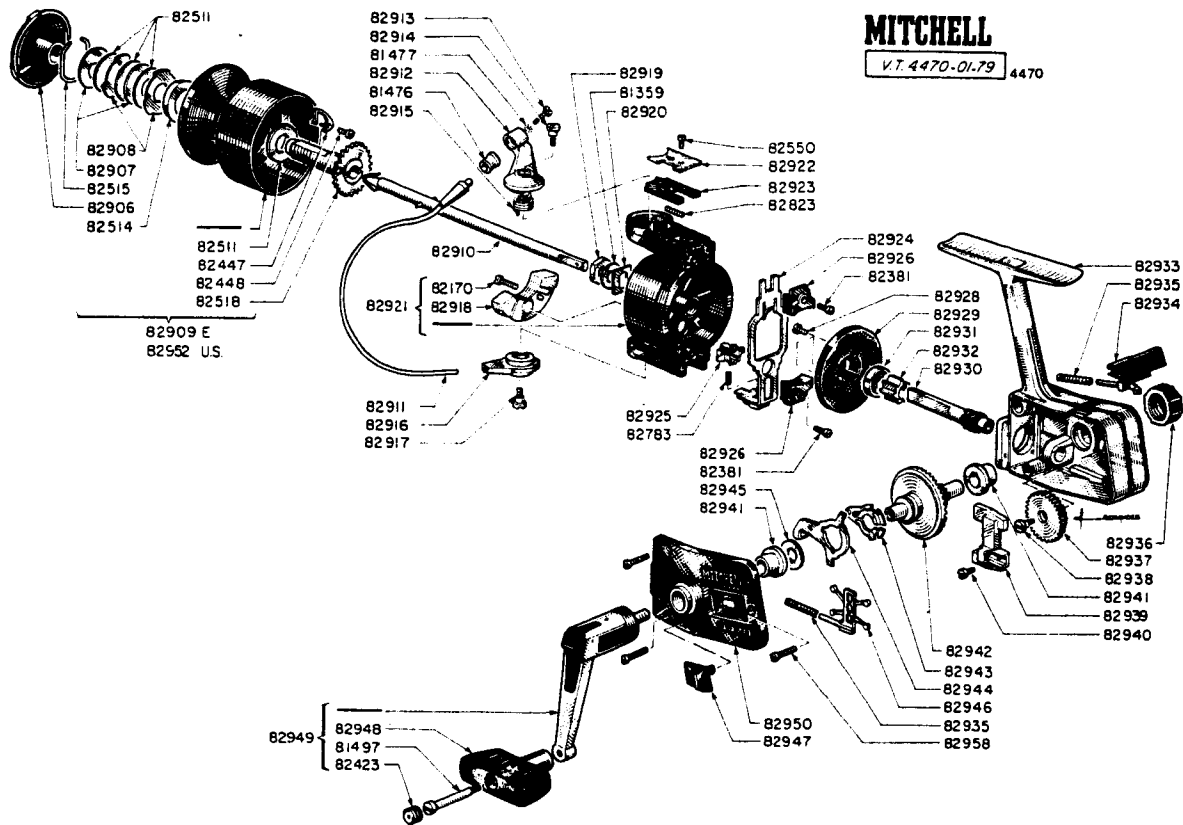

CODE NO.	DESCRIPTION	SUGGESTED RETAIL	CODE NO.	DESCRIPTION	SUGGESTED RETAIL
81359	Hex Nut Lock Washer	.40	82925	Anti Inertia Brake	.50
81476	Roller Line Guide	1.10	82926	Bail Trip Cover	.30
81477	Bail Wire Lock Washer	.25	*82928	Release Plate Screw	.25
81497	Handle Knob Screw	1.70	82929	Release Plate	.90
82170	Line Guide Screw	.40	82930	Pinion Gear	3.45
82381	Screw M 3 x 9.5	.30	82931	Ball Bearing	15.60
82423	Handle Knob Lube Port	.85	82932	Anti Reverse Ratchet	1.40
82447	Spool Click	.65	82933	Housing	13.10
82448	Click Screw	.60	82934	Anti Reverse Button	.60
82511	Teflon Drag Washer	.65	82935	Anti Reverse Spring	.30
82514	Brake Spring	.85	82936	Handle Shaft Cover	1.30
82515	Drag Lock Clip	.65	82937	Cross Wind Gear	2.45
82518	Spindle	3.45	82938	Cross Wind Gear Axle	.40
82550	Counterweight Screw	.60	82939	Oscillation Slide	1.50
82783	Bail Trip Spring	.60	82940	Oscillation Slide Screw	.45
82823	Bumper Spring	.20	82941	Handle Bushing	.60
82906	Drag Adjusting Knob	1.60	82942	Drive Gear	6.90
*82907	Drag Washer	.30	82943	Anti Reverse Click Friction	.45
*82908	Drag Washer	.30	82944	Anti Reverse Click	.85
82909	Spool Complete Black	16.00	82945	Shims to Adjust Drive Gear	.60
82910	Axle	4.10	82946	Click Spring Guide	.40
82911	Bail Wire	5.60	82947	Click Button	.60
82912	Bail Wire Mount	2.00	82948	Handle Knob	2.20
82913	Guide Line Screw	.45	82949	Handle Complete	6.65
82914	Bail Screw N 1	.50	82950	Cover Plate	6.60
82915	Bail Spring	.60	82952	Silver Spool Complete	16.00
82916	Bail Wire Bracket	1.45	82958	Rotating Head	13.10
82917	Bail Screw N 2	.45			
82918	Counterweight	1.85			
82919	Hex Nut	.60			
82920	Keyed Washer	.25			
82921	Rotating Head	10.50			
82922	Bumper Cover	.60			
82923	Bail Bumper	.45			
82924	Bail Trip	3.00			

*When present inventory is depleted, this part will be replaced by another number. Please refer to chart in back of book.