

1991 MINNKOTA 765MX

For parts and service
call toll free: 1-888-404-1119
www.mikesreelrepair.com

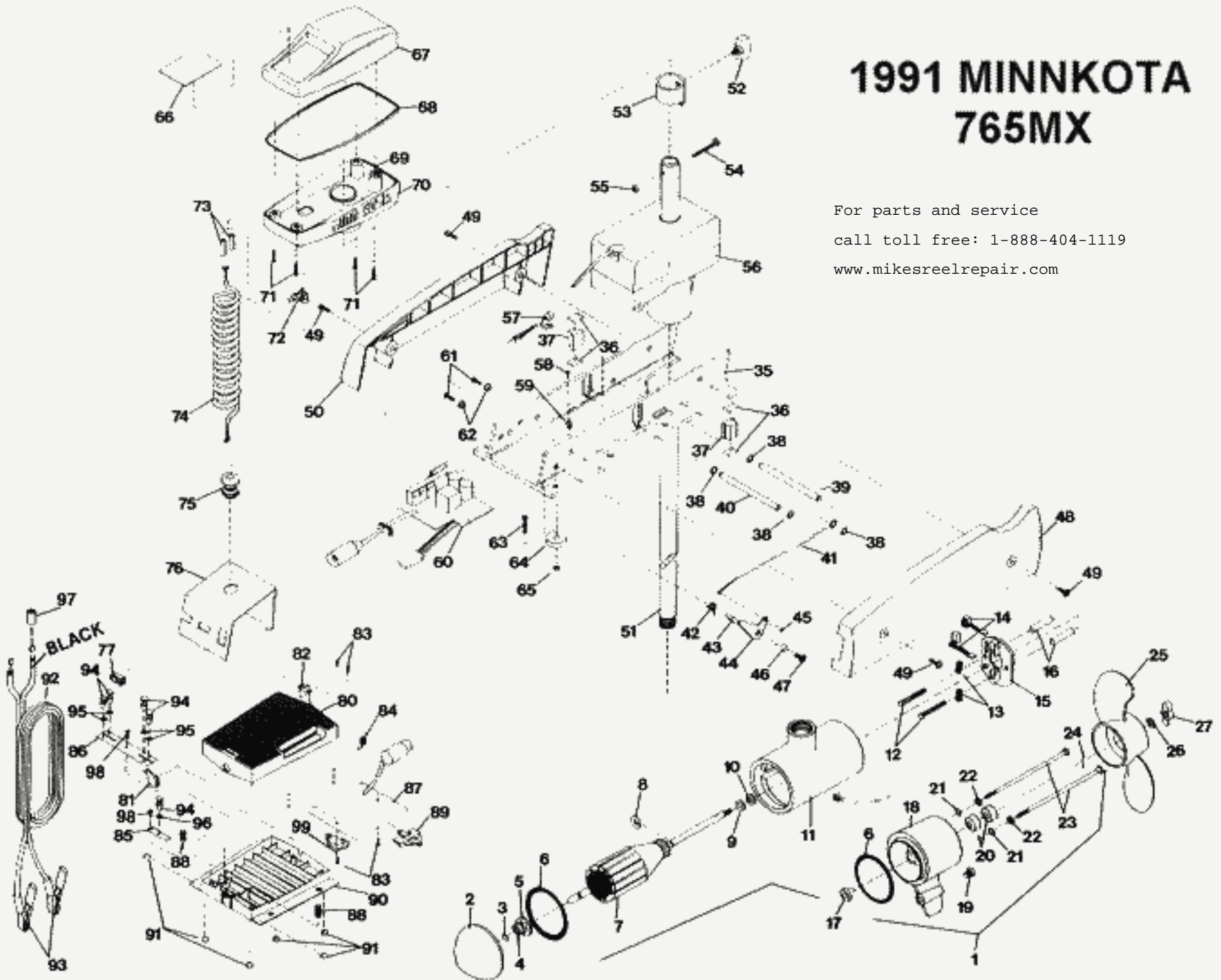

For parts and service
call toll free: 1-888-404-1119
www.mikesreelrepair.com

Item No.	Part No.	Description
1	230-7000	Motor Assembly (complete)
2	405-023	Front End Bell w/405-601 Bearing
3	401-050	Thrust Disc
4	405-601	Bearing
5	405-302	Bearing Retainer
6	405-460	O-Ring (2 req'd.)
7	406-202	Armature
8	405-300	E-Ring
9	405-170	Steel Washer
10	405-171	Thrust Washer
11	405-255	Center Section w/ Magnets
12	405-341	Brush Plate Screw (2 req'd.)
13	405-080	Brush Spring (2 req'd.)
14	405-070	Brush (2 req'd.)
15	405-400	Brush Plate
16	405-151	Brush Plate Spacer (2 req'd.)
17	405-000	Shoulder Bushing
18	405-032	Rear End Bell
19	409-330	Sacrificial Anode
20	405-461	Seal (2 req'd.)
21	405-462	Thru Bolt O-Ring (2 req'd.)
22	405-172	Thru Bolt Washer (2 req'd.)
23	405-351	Thru Bolt (2 req'd.)
24	208-2600	Shear Pin
25	206-1151	Propeller
26	205-1700	Prop Washer
27	205-3100	Prop Nut
35	230-1902	Base
36	230-5110	Pad Support (4 req'd.)
37	230-5100	Pivot Pad (2 req'd.)
38	201-3100	Push Nut (4 req'd)

Item No.	Part No.	Description
39	230-0500	Latch Pin
40	230-0510	Pivot Pin
41	230-3610	Release Rod
42	230-2700	Spring—Release Lever
43	230-0100	Release Knob
44	230-3700	Release Lever
46	230-1700	Spacer—Release Lever
47	230-3430	Screw—Release Lever
48	230-3800	Side Plate—Left
	230-5500	Decal—Side Plate Left
49	230-3430	Screw—Side Plate (4 req'd.)
50	230-3900	Side Plate—Right
	230-5510	Decal—Side Plate Right
51	215-2010	Tube (42")
52	201-1360	Collar Screw
53	230-1501	Drive Collar
54	203-3400	Control Box Screw
55	201-3110	Hex Nut
56	230-1820	Drive Housing Assembly
57	230-2930	Grommet—Drive Housing
58	223-2110	Screw—Insert
59	230-1520	Insert—Brass
60	230-4001	PC Board Assembly
61	230-3420	Screw—Transfer Bar (2 req'd.)
62	230-1710	Insulating Washer—Transfer Bar (2 req'd.)
63	215-3500	Mounting Bolt (4 req'd.)
64	230-1720	Mounting Washer (4 req'd.)
65	215-3100	Mounting Nut (4 req'd.)
66	230-5600	Decal—Cover 765mx
67	226-0220	Cover
68	226-6900	Gasket—Cover

Item No.	Part No.	Description
69	230-2500	Control Box
70	201-6600	Decal—Control Box (2 req'd.)
71	201-2100	Screw—Cover (4 req'd.)
72	205-2900	Heyco—Control Box
73	201-5400	Insulator - Small (2 req'd.)
74	230-1200	Coil Cord
75	230-2910	Grommet—Coil Cord
76	230-6503	Cover—Speed Control
77	230-2920	Grommet—Leadwire
80	230-4400	Foot Pedal
81	230-7200	Con/Mom Lever
82	230-2950	Cord Clamp
83	233-2103	Screw—Foot Pedal (5 req'd.)
84	230-2710	Spring—Detent
85	233-2810	Actuator—Single
86	233-2800	Actuator—Double
87	230-4011	PC Board Assembly—Foot Pedal
88	230-2720	Spring (2 req'd.)
89	230-0110	Speed Selector
90	230-4500	Foot Pedal Base
91	230-5131	Rubber Bumper (6 req'd.)
92	205-0600	Leadwire (Includes Battery Clips and Terminals)
93	201-0700	Battery Clips (2 req'd.)
94	233-5130	Bumper-Actuator (5 req'd.)
95	233-1701	Washer (4 req'd.)
96	233-1702	Washer
97	206-5400	Insulator - Large -
98	230-3415	Screw (2 req'd.)
99	230-3111	Retainer

WIRING DIAGRAM

For parts and service
call toll free: 1-888-404-1119
www.mikesreelrepair.com

