

Item / Assembly	Part #	Description	Qty.
A	2992726	BALL DETENT,RETAINER SPRING ASM	1
2	2992725	BALL, DETENT ASSY, ENDURA	1
4	2062900	RETAINER-BALL SPRING	4

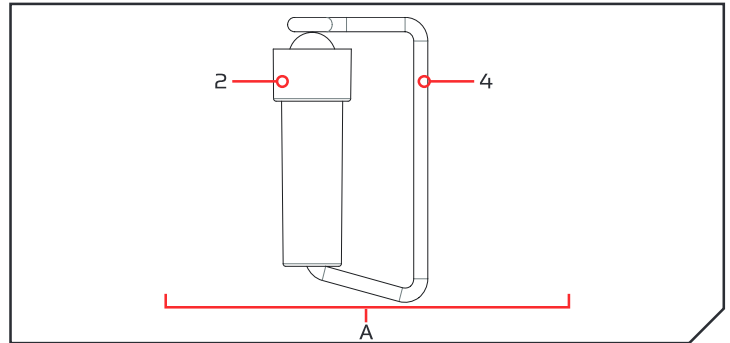

TOOLS AND RESOURCES REQUIRED

- Drill
- #2 Phillips Bit
- 3/16" Punch
- Hammer



CAUTION

Always wear safety glasses and gloves. Disconnect all power to the trolling motor before beginning any work or maintenance. Johnson Outdoors Inc. is not responsible for any damage due to improper rigging or installation. If you do not have the skills, experience and tools to perform the following maintenance and repairs, we recommend you seek the help of a Minn Kota Authorized Service Center. A list of Authorized Service Centers can be found at <http://www.minnkotamotors.com/Authorized-Service-Providers/>. Or contact our Technical Service Department by email at service@minnkotamotors.com or, by dialing 800-227-6433.

MOUNTING CONSIDERATIONS

The Endura C2 and Endura Max handle extends up to 6" in eleven, half inch increments. If the outer handle assembly is completely removed the ball detent could possibly be lost. Without the ball detent in place you will not notice the eleven, half inch increments. This kit will guide you through replacing the missing ball detent before reinstalling the outer handle assembly.

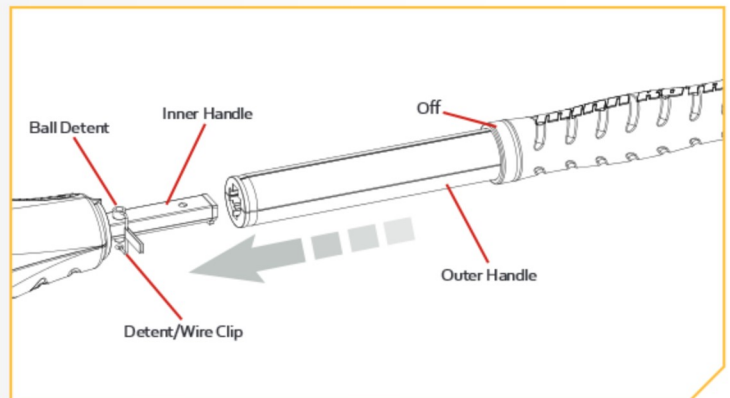

INSTALLATION

1

- a. Make sure that the Power Cables from the battery are disconnected, or that the breaker, if equipped, is "off".



WARNING

Make sure the motor is mounted on a level surface and is not connected to a power source.

- b. Using a #2 Phillips Screwdriver, remove the six #8-18 x 5/8" screws from the Control Box Cover and remove the cover.
- c. Endura Max models have a #6 x 1/2" Screw (*) located on the Inner Handle that will also need to be removed.

Endura Max

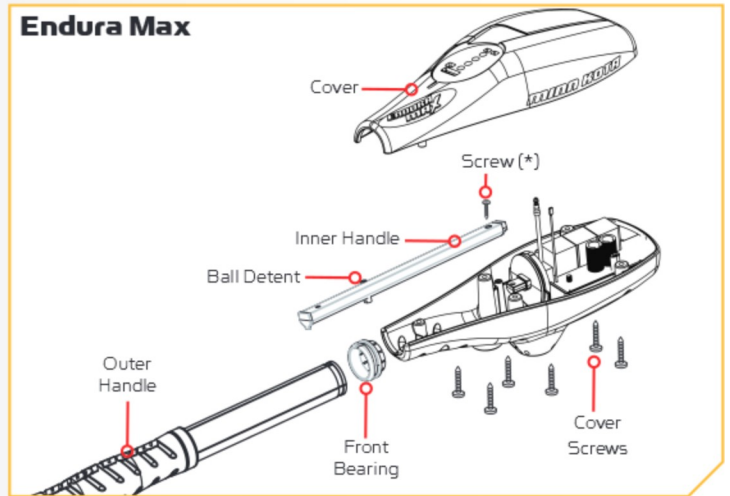

2

- d. Gently lift up on the Outer Handle to separate it from the control box. The Front Bearing will be attached to the Outer Handle.
- e. Slide the Outer Handle and Front Bearing off of the Inner Handle.
- f. Rest the Inner Handle on the edge of a table and use a 3/16" punch to drive the Ball Detent Holder out.
- g. Insert the new Ball Detent assembly into the Inner Handle.

NOTE: The retainer must be removed before installing the ball detent. Attach the retainer clip to the ball detent again after it has been installed in the inner handle.

Endura C2

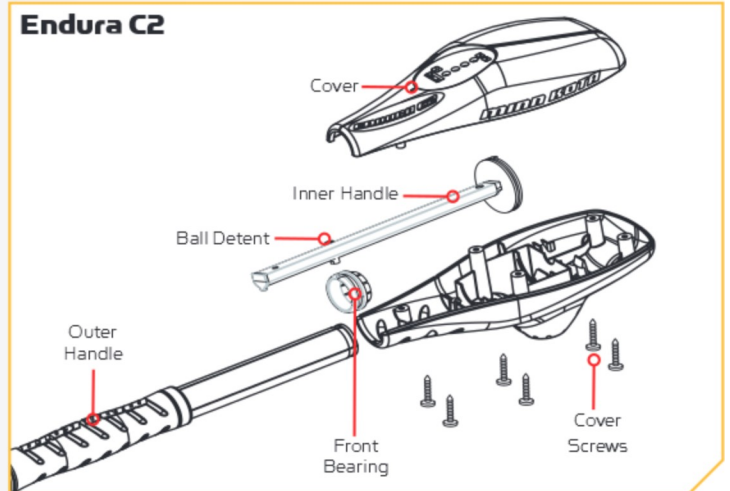

3

- h. Reinstall the Inner Handle into the control box and reinstall the Screw(*) if necessary.
- i. Reinstall the Outer Handle over the Inner Handle. Align Front Bearing into the control box with the arrow facing upwards.
- j. Reinstall the top cover and hand tighten the six cover screws.



minnkotamotors.com

Minn Kota Consumer & Technical Service
Johnson Outdoors Marine Electronics, Inc.
PO Box 8129
Mankato, MN 56001

121 Power Drive
Mankato, MN 56001
Phone (800) 227-6433
Fax (800) 527-4464



©2016 Johnson Outdoors Marine Electronics, Inc.
All rights reserved.