

BAITCASTING REEL **Millionaire 5HS/6HS**

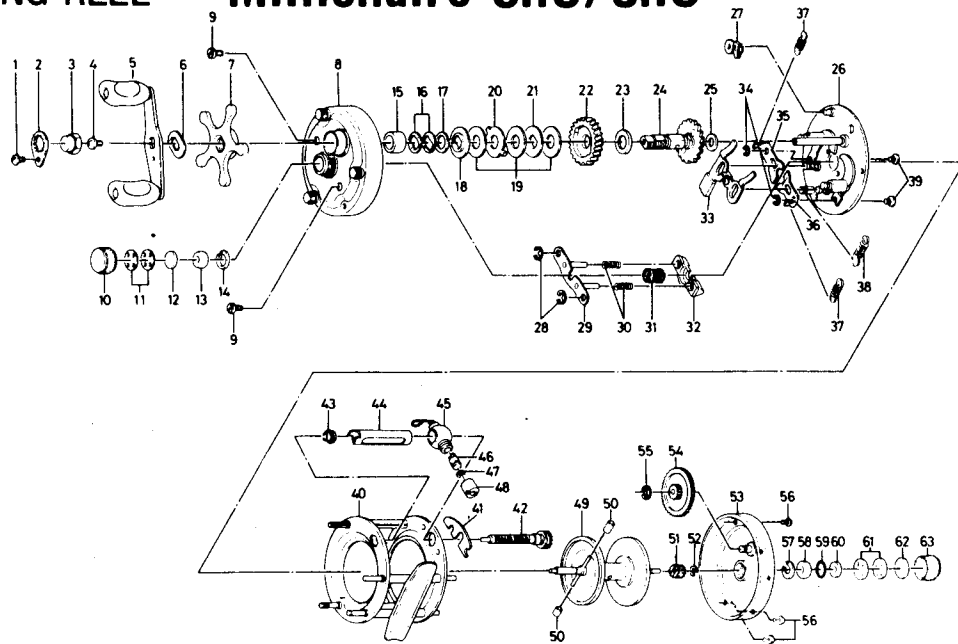

Key No.	Parts No.	Parts Name
Millionaire 5 HS		
1	353-8301	Handle nut plate screw
2	040-3201	Handle nut plate
3	341-5801	Handle nut
4	353-0701	Handle screw
5	747-1701	Handle
6	150-9001	Handle washer
7	780-9801	Star drag
8	780-9416	Right side cover
9	353-1701	Right side cover screw
10	342-0801	Right spool cap
11	373-7502	Ball bearing ret. washer
12	320-4101	Ball bearing retainer A
13	637-4601	Ball bearing
14	320-6501	Ball bearing ret. ring
15	501-8701	Spacing sleeve
16	150-8901	Spring washer
17	373-7803	Drag washer A
18	376-0001	Drag washer B
19	374-9305	Drag washer C
20	375-8701	Drag washer D
21	374-9401	Drag washer E
22	413-0311	Drive gear
23	374-9303	Gear shaft washer A
24	725-4611	Gear shaft
25	373-7611	Gear shaft washer B
26	780-9501	Set plate
27	770-0301	Anti-reverse claw
28	320-8002	Pinion yoke guide plate ret. ring
29	780-9701	Pinion yoke guide plate
30	143-9311	Pinion yoke spring
31	B24-3101	Pinion gear
32	635-9201	Pinion yoke
33	780-9601	Clutch lever
34	320-8202	Clutch ret. ring
35	040-4701	Clutch stopper plate A

Key No.	Parts No.	Parts Name
36	040-4801	Clutch stopper plate B
37	142-8503	Set plate spring A
38	142-8502	Set plate spring B
39	121-6801	Set plate screw
40	780-9901	Frame
41	151-4111	Worm shaft lock arm
42	710-7711	Worm shaft
43	021-7201	Shield bushing
44	634-6111	Worm shield
45	781-0201	Line guide
46	121-4211	Line guide pin
47	375-0800	Line guide washer
48	341-5901	Line guide nut
49	731-2901	Spool
50	500-8011	Brake collar
51	402-2001	Spool gear
52	320-4202	Spool gear ret. ring
53	781-0326	Left side cover
54	413-0001	Cog wheel
55	320-8002	Cog wheel ret. ring
56	352-4221	Left side cover screw
57	320-6501	Ball bearing ret. ring
58	637-4601	Ball bearing
59	805-5201	"O" ring
60	320-7711	Ball bearing retainer B
61	373-7502	Ball bearing ret. washer
62	374-7221	Rubber washer
63	342-1001	Left spool cap

Millionaire 6HS Special Parts		
8	780-9417	Right side cover
40	781-0801	Frame
42	710-8211	Worm shaft
44	634-6112	Worm shield
49	731-2902	Spool