

# BAITCASTING REEL — BW2, EL2, EL2C, PS2-2B, PS2-5B

(Special Parts, EL2, EL2C, PS2-2B, PS2-5B — continued on page 90.)

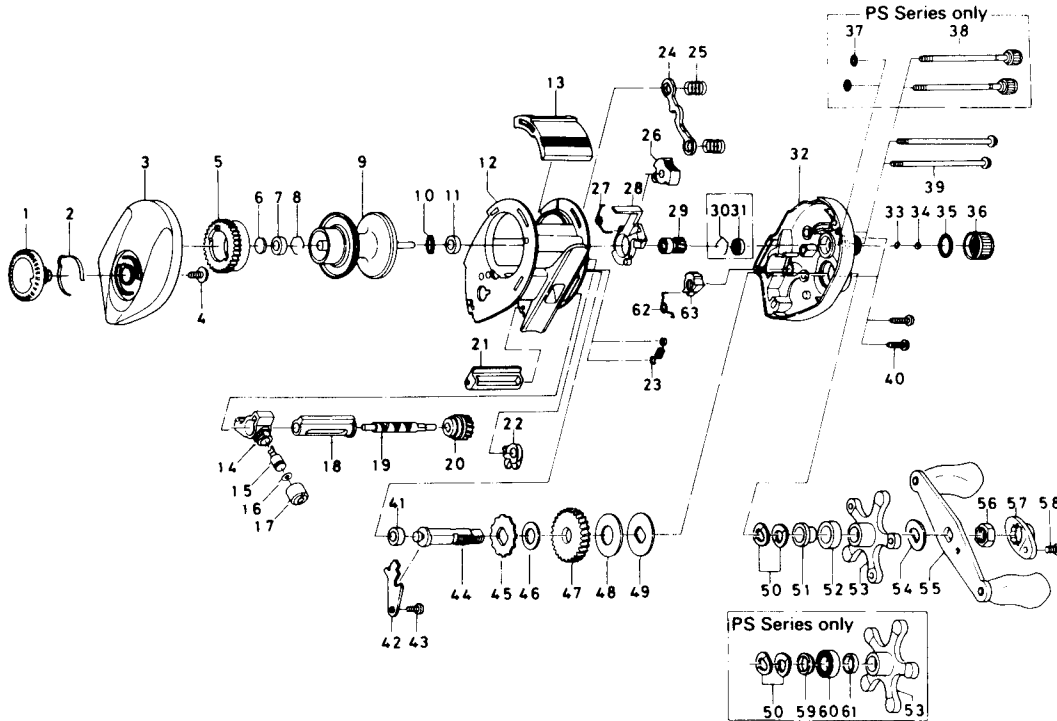

Key No.	Part No.	Part Name	Price	Key No.	Part No.	Part Name	Price
<b>BW2</b>							
1	F05-5801	Brake adjusting knob	2.30	29	E42-0901	Pinion gear	6.95
2	F03-2401	Brake click spring	.60	32	F05-4217	Right side plate	8.60
3	F05-4501	Left side plate	8.80	33	E16-9201	Spool adjusting cap metal	.60
4	B84-2102	Brake adjusting knob screw	.50	34	E17-0501	Spacer B	.50
5	E23-9501	Magnet holder	2.85	35	171-5201	"O" ring A	1.15
6	375-7405	Spacer A	.60	36	E23-8401	Cast control cap	.60
7	B55-0301	Bushing A	1.50	39	E28-4901	Right side plate screw A	1.15
8	B42-1601	Bearing retainer A	.45	40	E33-0401	Set plate screw	.60
9	F05-4901	Spool assembly	10.00	41	B55-0301	Bushing A	1.50
10	F12-0701	Ball bearing retaining ring	1.15	42	E23-7601	Drive shaft retainer	.65
11	E35-1501	Bushing B	1.15	43	B83-4402	Drive shaft retainer screw	.50
12	F05-3701	Frame assembly	8.50	44	E23-7501	Drive shaft	5.60
13	F05-4001	Clutch lever	1.30	45	E32-7701	Anti-reverse ratchet	1.15
14	E16-6301	Line guide	4.10	46	375-7103	Drive shaft washer	.60
15	121-4212	Line guide pawl	2.85	47	F12-6701	Drive gear	7.20
16	375-4101	Line guide washer	.30	48	B36-0202	Drag washer	1.10
17	342-4801	Pawl cap	1.55	49	B36-0301	Key washer	.80
18	E31-2001	Lever wind guard	1.40	50	150-8901	Drag spring washer	.55
19	E45-1201	Worm shaft	6.85	51	E32-6401	Spacing sleeve A	1.15
20	F08-5201	Worm shaft gear	1.55	52	E34-6801	Spacing sleeve B	1.15
21	F05-3901	Line guard	1.45	53	E23-8701	Star drag	2.25
22	E23-8001	Anti-reverse pawl	2.30	54	150-9001	Friction washer	.45
23	E16-5801	Clutch trip plate spring	.85	55	E30-5201	Handle assembly	4.95
24	E23-7701	Yoke	.85	56	B43-3601	Handle nut	1.15
25	E16-7101	Yoke spring	.60	57	F05-4401	Handle nut plate	.95
26	E24-9101	Flipping / casting selector	.70	58	351-1801	Handle nut plate screw	.45
27	E24-9001	Clutch cam spring	.60	62	F12-0501	Anti-reverse lever spring	.70
28	E23-7401	Clutch cam	.85	63	E30-9501	Anti-reverse lever	.75

# BAITCASTING REEL — BW2, EL2, EL2C, PS2-2B, PS2-5B

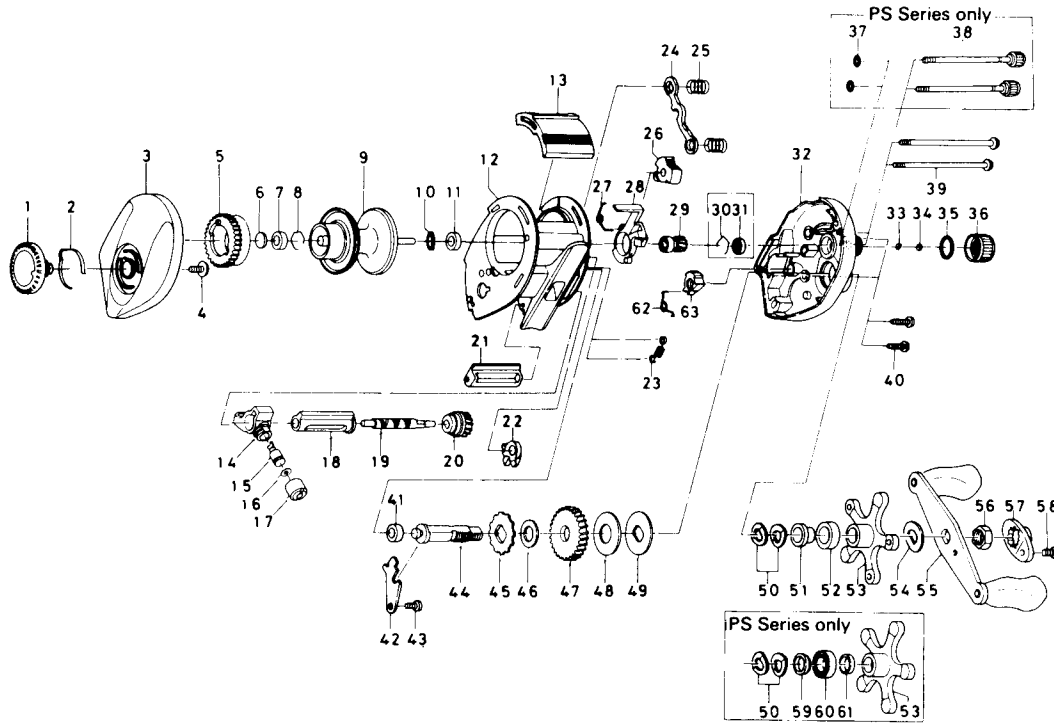

Key No.	Part No.	Part Name	Price
<b>EL2 Special Parts:</b>			
1	F06-0101	Brake adjusting knob	2.60
3	F05-4506	Left side plate	8.80
11	B35-8601	Ball bearing	8.75
12	F05-3702	Frame assembly	8.50
21	F05-3902	Line guard	1.45
32	F05-4219	Right side plate	9.00
53	E23-8702	Star drag	2.50
55	E30-5203	Handle assembly	5.95

<b>EL2C Special Parts:</b>			
1	F06-0101	Brake adjusting knob	2.60
3	F05-4507	Left side plate	8.80
11	B35-8601	Ball bearing	8.75
12	F05-3702	Frame assembly	8.50
20	F06-1301	Worm shaft gear	1.55
21	F05-3902	Line guard	1.45
29	E42-7701	Pinion gear	6.95
32	F05-4220	Right side plate	8.10
47	E42-7601	Drive gear	7.20
48	B30-9102	Drag washer	2.50
49	F06-6701	Key washer	1.15
53	E23-8702	Star drag	2.50
55	E30-5203	Handle assembly	5.95

<b>PS2-2B Special Parts:</b>			
1	F06-0401	Brake adjusting knob	4.25
3	F05-4503	Left side plate	9.85
9	F06-0601	Spool assembly	14.50
11	B35-8601	Ball bearing A	8.75
12	F05-3702	Frame assembly	8.50
13	F06-0201	Clutch lever	2.60

Key No.	Part No.	Part Name	Price
21	F05-3902	Line guard	1.45
32	F05-4218	Right side plate	9.30
37	B85-3101	"O" ring B	.60
38	B91-1712	Right side plate screw B	3.40
53	F06-0301	Star drag	5.65
55	E30-5203	Handle assembly	5.95
58	351-1803	Handle nut plate screw	.45
59	E20-8501	Spacing sleeve A	1.15
60	E15-4001	Ball bearing B	6.85
61	B97-4901	Spacing sleeve B	.95

<b>PS2-5B Special Parts:</b>			
1	F06-0901	Brake adjusting knob	4.25
3	F05-4504	Left side plate	11.35
7	B35-8601	Ball bearing A	8.75
9	F06-0601	Spool assembly	14.50
11	B35-8601	Ball bearing A	8.75
12	F05-3702	Frame assembly	8.50
13	F06-0201	Clutch lever	2.60
21	F05-3902	Line guard	1.45
30	E21-9701	Bearing retainer	.50
31	E24-8501	Ball bearing B	8.65
32	F05-4209	Right side plate	11.10
37	B85-3101	"O" ring B	.60
38	B91-1712	Right side plate screw B	3.40
41	B35-8601	Ball bearing A	8.75
53	F06-0303	Star drag	5.65
58	351-1803	Handle nut plate screw	.45
59	E20-8501	Spacing sleeve A	1.15
60	E15-4001	Ball bearing C	6.85
61	B97-4901	Spacing sleeve B	.95