



For parts and Service

Call toll free 1-888-404-1119

www.mikesreelrepair.com

AS61 / AS61A / AS62 / AS62A / AS64 / AS64A

SPECIFICATIONS :

Line Capacity:

- AS61 - 140 yds / 4 lb
- AS62 - 120 yds / 8 lb
- AS64 - 200 yds / 10 lb

5.8:1 Gear Ratio

Retrieve Rate (IPT):

- AS61 - 25" per turn
- AS62 - 27" per turn
- AS64 - 30" per turn

Weight:

- AS61 - 10.6 oz.
- AS62 - 10.8 oz.
- AS64 - 13 oz.

Bearings: 5 BB; 1 RB

FEATURES :

- Front Drag
- Tru-Balanced Rotor
- Balanced Handle
- Twist Reducer Line Roller
- Selective Continuous A/R
- Worm Gear Oscillation
- Alum. Spool ("A" models have holes in skirt)
- Color: Black

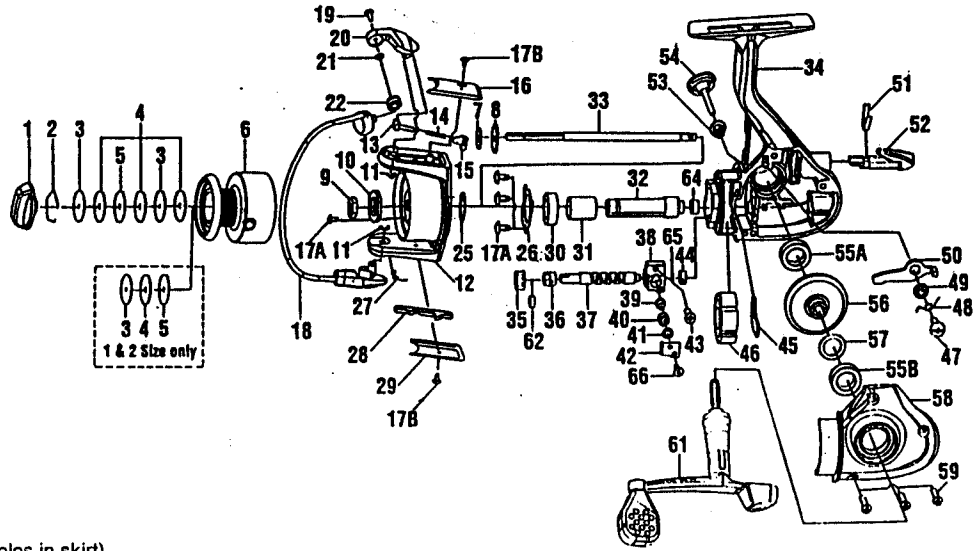

| Key No. | AS61/A | AS62/A | AS64/A | Description | Price | Key No. | AS61/A | AS62/A | AS64/A | Description | Price |
|---------|----------|----------|-----------------------------------------------------------|---------------------|-------|---------|----------|----------|-----------------------------------------------------------|-----------------------|-------|
| 1 | FH332-04 | ← | GH332-04 | Drag Knob | 2.97 | 35 | FH200-01 | ← | GH200-01 | Level Wind Gear | 1.70 |
| 2 | AQ038-01 | ← | ← | Drag Retainer | 0.32 | 36 | GH202-01 | ← | ← | Wm Shft Bushng (L) | 0.31 |
| 3 | TU080-01 | ← | ← | Drag Washer "D" | 1.16 | 37 | FH201-01 | ← | TU201-01 | Worm Shaft | 2.44 |
| 4 | GH033-01 | ← | ← | Drag Washer "B" | 2.68 | 38△ | ZQ204-01 | ← | GH204-01 | Pawl Holder | 3.25 |
| 5 | TU081-01 | ← | ← | Drag Washer "A" | 1.18 | 39 | TU207-01 | ← | ← | Pawl | 2.71 |
| 6 | ZQ321-05 | FH321-05 | GH321-05 | Spool Asy. | 7.21 | 40 | UQ208-03 | ← | ← | Pawl Collar | 0.32 |
| 6▽ | ZQ321-10 | FH321-10 | GH321-11 | Spool Asy. w/ holes | 7.21 | 41△ | RU209-01 | ← | ← | Pawl Washer | 0.31 |
| 7 | TU030-01 | ← | ← | Click Gear Washer | 0.96 | 42△ | FH205-01 | ← | ← | Pawl Holder Retainer | 1.18 |
| 8 | TU037-01 | ← | ← | Click Gear Washer | 1.22 | 43 | UQ100-03 | ← | ← | Main Shaft Screw | 0.41 |
| 9 | RU006-01 | ← | ← | Rotor Nut | 0.93 | 44 | GH203-01 | ← | ← | Wm Shft Bushng (Rt.) | 0.32 |
| 10 | TL065-01 | ← | ← | Rotor "D" Washer | 1.16 | 45 | TU206-01 | ← | ← | Worm Shaft Retainer | 1.60 |
| 11 | GH034-01 | ← | ← | E-Clip | 0.32 | ▲46 | GH074-01 | ← | ← | Clutch Bearing | 11.03 |
| 12 | ZQ009-05 | FH009-05 | GH009-05 | Rotor | 7.85 | 46 | RU074-01 | →→→ | Use GH074-01 (clutch bearing) & TU052-01 (bearing sleeve) | | |
| 13 | QL031-01 | ← | ← | Bail Spring Shaft | 0.27 | 47 | GH077-01 | ← | ← | A/R Pawl Screw | 0.32 |
| 14 | KQ049-05 | ← | ← | Bail Spring | 0.32 | 48 | TU061-01 | ← | ← | A/R Pawl Spring | 0.32 |
| 15 | QL020-01 | ← | ← | Bail Spring Holder | 0.32 | 49 | TU091-01 | ← | ← | A/R Pawl Post | 1.16 |
| 16 | ZQ087-05 | FH087-05 | GH087-05 | Arm Lvr Spring Cvr | 2.67 | 50 | RU083-01 | ← | ← | A/R Pawl | 1.22 |
| 17 | UQ057-01 | ← | ← | Screw | 0.32 | 51 | GH089-01 | ← | ← | A/R Lever Spring | 1.22 |
| 18 | ZQ347-05 | FH347-05 | GH347-05 | Bail Assy. | 3.92 | 52 | GH090-01 | ← | ← | A/R Lever | 2.58 |
| 19 | AQ108-01 | ← | ← | Line Slider Screw | 0.31 | 52▽ | ZQ090-01 | ← | ← | A/R Lever | 2.58 |
| 20 | ZQ007-05 | ← | GH007-05 | Arm Lever | 2.39 | 53 | RU105-01 | ← | ← | Handle Cap Washer | 0.50 |
| 21 | GU105-25 | ← | ← | Line Roller Washer | 0.32 | 54 | ZQ073-01 | ← | ← | Handle Cap Screw | 1.75 |
| 22 | TU004-02 | ← | ← | L/Roller w/Bearing | 6.90 | 55A | BL157-01 | ← | N/A | Ball Bearing (Body) | 5.57 |
| 25 | GU105-12 | ← | ← | Rotor Washer | 0.32 | 55B | BL157-01 | ← | ← | B. Bearing (Body Cvr) | 5.57 |
| 26 | N/A | N/A | TU040-02 | Bearing Plate | 1.10 | 56 | FH012-01 | ← | GH012-01 | Drive Gear | 1.11 |
| 27 | GH049-01 | ← | ← | Kick Lever Spring | 0.32 | 57 | GU105-13 | ← | ← | Adjust Washer | 0.66 |
| 28 | ZQ019-01 | ← | TU019-01 | Kick Lever | 1.11 | 58 | FH023-10 | FH023-09 | GH023-05 | Side Cover | 5.41 |
| 29 | ZQ024-05 | FH024-05 | GH024-05 | Kick Lever Cover | 2.76 | 58▽ | ZQ023-07 | ← | UU023-04 | Side Cover | 5.41 |
| 30 | BL157-01 | ← | UK028-01 | Pinion Ball Bearing | 5.57 | 59 | KQ057-01 | ← | ← | Side Cover Screws | 0.32 |
| ▲31 | TU052-01 | ← | ← | Bearing Sleeve | 2.76 | 61 | FH318-04 | ← | GH318-02 | Handle Asy. | 11.77 |
| 31 | RU139-01 | →→→ | Use TU052-01 (bearing sleeve) & GH074-01 (clutch bearing) | | | 61▽ | ZQ318-03 | ← | UU318-03 | Handle Asy. | 11.77 |
| 32 | FH011-01 | ← | GH011-01 | Pinion Gear | 3.55 | 62 | GH212-01 | ← | ← | Worm Shaft Collar | 1.16 |
| 33 | FH015-01 | ← | TU015-01 | Main Shaft | 2.60 | 64▽ | RU141-01 | ← | ← | Pinion Bushing | 1.60 |
| 34 | FH301-10 | FH301-09 | GH301-05 | Body Assy. | 13.74 | 65▽ | GU105-31 | ← | ← | Worm Shaft Washer | 0.32 |
| 34▽ | ZQ001-07 | ← | UU001-04 | Body Assy. | 13.74 | 66▽ | GH123-01 | ← | ← | Plate Screw | 0.93 |

▽ = Special parts for AS6xA models.

△ = Send Key No.'s 38, 41, 42, and 66 if any of these are ordered.

□ = Send Key No.'s 53, 54, and 61 if either part is ordered.

▲ = Both parts must be shipped together if either one is ordered.

| | | |
|-------------------------|-------------------------------------------------|--------------------|
| MODEL INTRODUCED : 1998 | EFFECTIVE DATE OF PARTS LIST/DIAGRAM: Sept. '98 | DISCONTINUED : N/A |
|-------------------------|-------------------------------------------------|--------------------|

Prices subject to change without notice. Prices do not include postage and handling.

PLEASE ORDER BY PART NUMBER Zebco, P.O. Box 270, Tulsa, Ok. 74101; 918-831-6965 Phone or 800-FIXREEL (349-7335) FAX

