

# SIGMA REEL

2200-GX-060SW

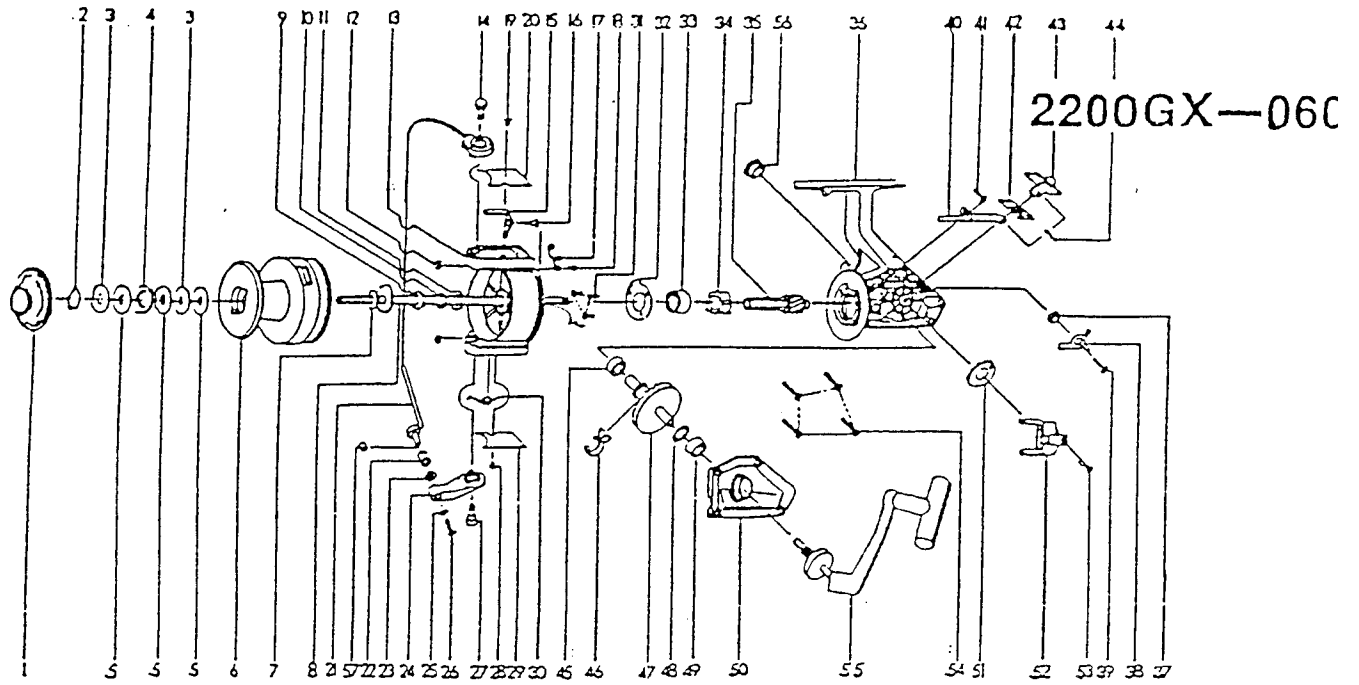

REF	PART NUMBER	DESCRIPTION
1	79-40-0178-01	Drag Knob
2	79-54-0124-01	Spool Retainer
3	79-72-0582-01	Spool "D" W/S
4	79-72-0605-01	Spool "A" W/S
5	79-72-0354-01	Spool "B" W/S
6	79-66-0246-01	Spool Ass'y
7	79-72-0583-01	Spool Adj W/S
8	79-60-0134-01	Main Shaft
9	79-40-0176-01	Rotor Nut
10	79-72-0597-01	Rotor Retainer W/S
11		
12	79-15-0051-01	E-Clip
13	79-34-0137-01	Rotor
14	79-45-0038-01	Bail Holder Pin
15	79-37-0164-01	Kick Lever
16	79-58-0578-01	Kick Lever Screw
17	79-67-0606-01	Kick Lever Spring
18	79-58-0579-01	Kick L/V S/P S/C
19	79-58-0577-01	Kick L/V C/V S/C
20	79-19-0085-01	Kick Lever C/V
21	79-03-0106-01	Bail Ass'y
22	79-57-0039-01	Line Roller
23	79-17-0010-01	Bail Collar
24	79-07-0076-01	Arm Lever
25	79-72-0606-01	Bail W/S
26	79-58-0562-01	Bail Screw
27	79-58-0566-01	Arm Lever Pin
28	79-58-0577-01	Bail S/P C/V S/C
29	79-19-0098-01	Bail S/P C/V
30	79-67-0620-01	Bail Spring

REF	PART NUMBER	DESCRIPTION
31	79-58-0571-01	Bearing Plate
32	79-47-0372-01	Bearing Plate (BAIL BRAKE)
33	79-04-0064-01	Ball Bearing
34	79-28-0161-01	Ratchet Gear
35	79-46-0095-01	Pinion Gear
36	79-27-0166-01	Body
37	79-09-0023-01	A.R. Claw Bushing
38	79-37-0182-01	A.R. Claw
39	79-58-0581-01	A.R. Claw S/C
40	79-11-0054-01	A. Reverse Cam
41	79-58-0576-01	A.R. Cam S/C
42	79-67-0616-01	A.R. Plate Spring
43	79-37-0175-01	A.R. Lever
44	79-45-0043-01	A.R. Lever Pin
45	79-09-0020-01	Body Bushing
46	79-11-0057-01	Sliding Spring
47	79-28-0166-01	Drive Gear
48	79-72-0603-01	Drive Gear Adj W/S
49	79-09-0020-01	Body Cover Bushing
50	79-19-0095-01	Body Cover
51	79-28-0167-01	O/S Gear
52	79-64-0052-01	O/S Slider
53	79-58-0583-01	O/S Slider S/C
54	79-58-0584-01	Body Cover Screw
55	79-20-0142-01	Handle Ass'y
56	79-12-0051-01	Handle S/C Cap
57	79-09-0017-01	Line Roller Bushing



Shakespeare®