

20 BOW BLACK

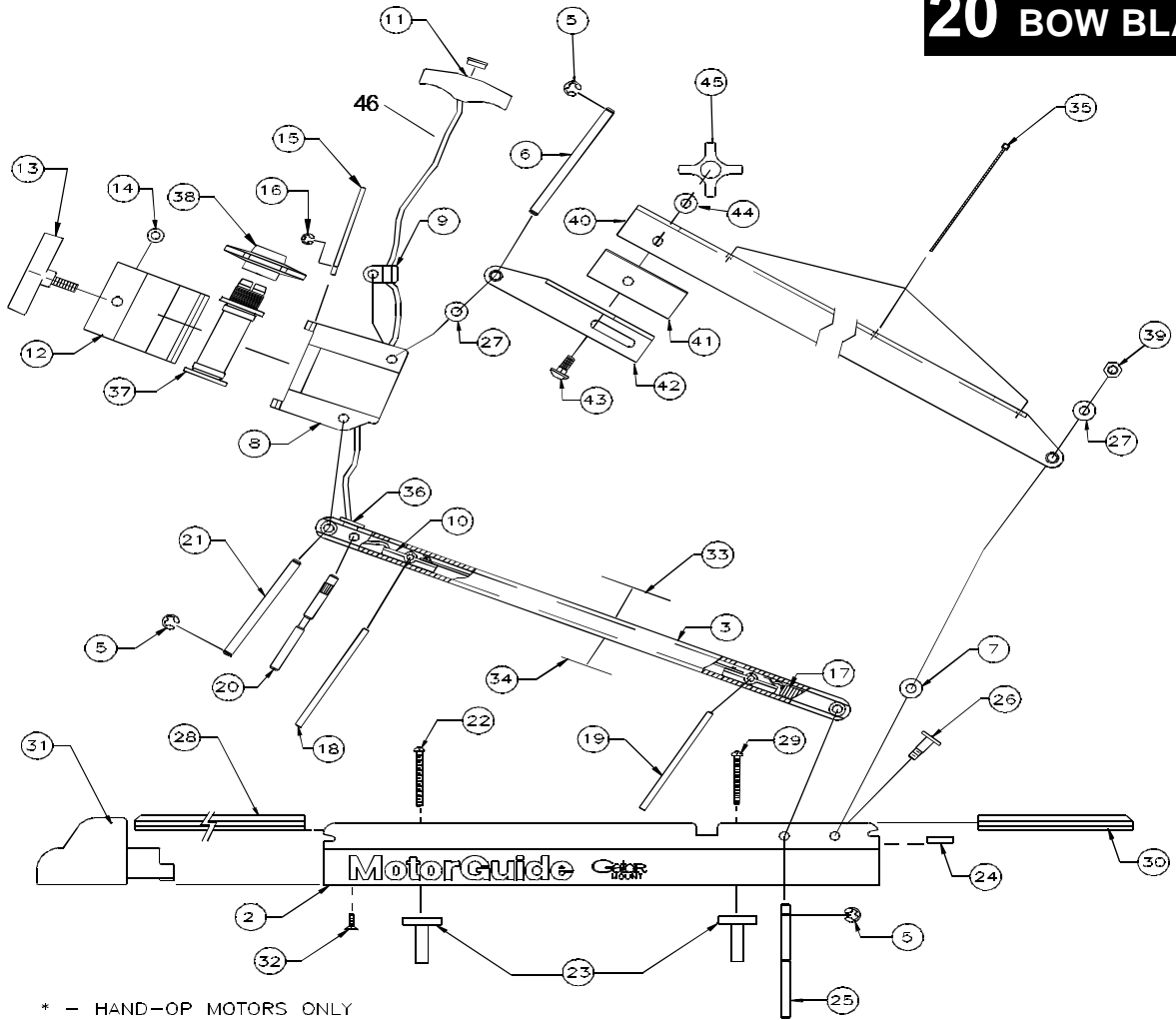

* - HAND-OP MOTORS ONLY

ITEM #	PART #	DESCRIPTION	ITEM #	PART #	DESCRIPTION
1	RK300-01	ASSEMBLY - 20 MOUNT	24	AK016-01	RUBBER REST
2	RK010-08	DECK CHANNEL	25	RK107-02	PIN, BOW ARM/DECK CHANNEL
3	RK309-01	BOW ARM	26	RK134-01 (2)	BOLT - SHOULDER
4	RK3308-01	TOP CHANNEL/CLUTCH ASSY.	27	RK171-02 (4)	WASHER, NYLON .062" THK.
5	BK046-01 (5)	E-RING, 3/8"	28	RK100-03 (2)	PAD, MOTOR 13"
6	RK102-01	PIN, BRACKET/CLUTCH CHANNEL	29	XT136-01 (2)	DECK MOUNTING SCREW, SHORT
7	RK171-01 (2)	WASHER, NYLON .125" THK.	30	RK100-04 (2)	PAD, MOTOR 6"
8	RK011-01	BRACKET	31	RK034-01	DECKET
9	RK021-01	ROPE BUSHING, NYLON	32	AK137-01 (2)	SCREW, DECKET
10	RK313-01	LOCK SLIDE ASSEMBLY	33	AK056-01	LABEL, WARNING
11	AK072-01	ROPE HANDLE WITH BUTTON	34	BK056-01	LABEL, PROP WARNING
12	RK012-01	DOOR, BRACKET	35	AF030-01	CABLE TIE
13	RK082-01	KNOB, BAR	36	AK021-02	BUSHING, ROPE
14	RK171-03	WASHER, NYLON	37*	RK021-02	FRICTION TUBE
15	RK104-01	PIN, DOOR/BRACKET	38*	KM082-05	KNOB
16	AK046-01	E-RING, 3/16"	39	KM098-01 (2)	LOCK NUT - 5/16-24
17	RK014-01	SPRING	40	RK308-01	TOP CHANNEL
18	RK106-01	PIN, LOCK SLIDE	41	RK079-01	INSERT CLUTCH
19	RK106-02	PIN - LOCK SLIDE - REAR	42	RK361-01	CLUTCH CHANNEL
20	RK108-01	PIN, TENSION	43	RK025-03 (2)	BOLT
21	RK107-01	PIN, BRACKET/BOW ARM	44	DK011-01 (2)	WASHER
22	XT136-02 (2)	DECK MOUNTING SCREW, LONG	45	RK082-03 (2)	KNOB
23	AK015-01 (4)	MOUNTING ISOLATOR	46	AK043-01	ROPE

FEATURES

- Built-in breakaway clutch
- Hinged door for easy removal
- Positive "Lock in Stow"
- Adjustable Height
- Recessed prop wrench pocket

CONSTRUCTION

- Heavy-duty extruded aluminum

ENVIRONMENT

- Freshwater

BASE DIMENSIONS

- Length - 21.5"
- Width - 5"
- Mounting hole size - 1/4"
- Length fully stowed - 43 1/4"

