

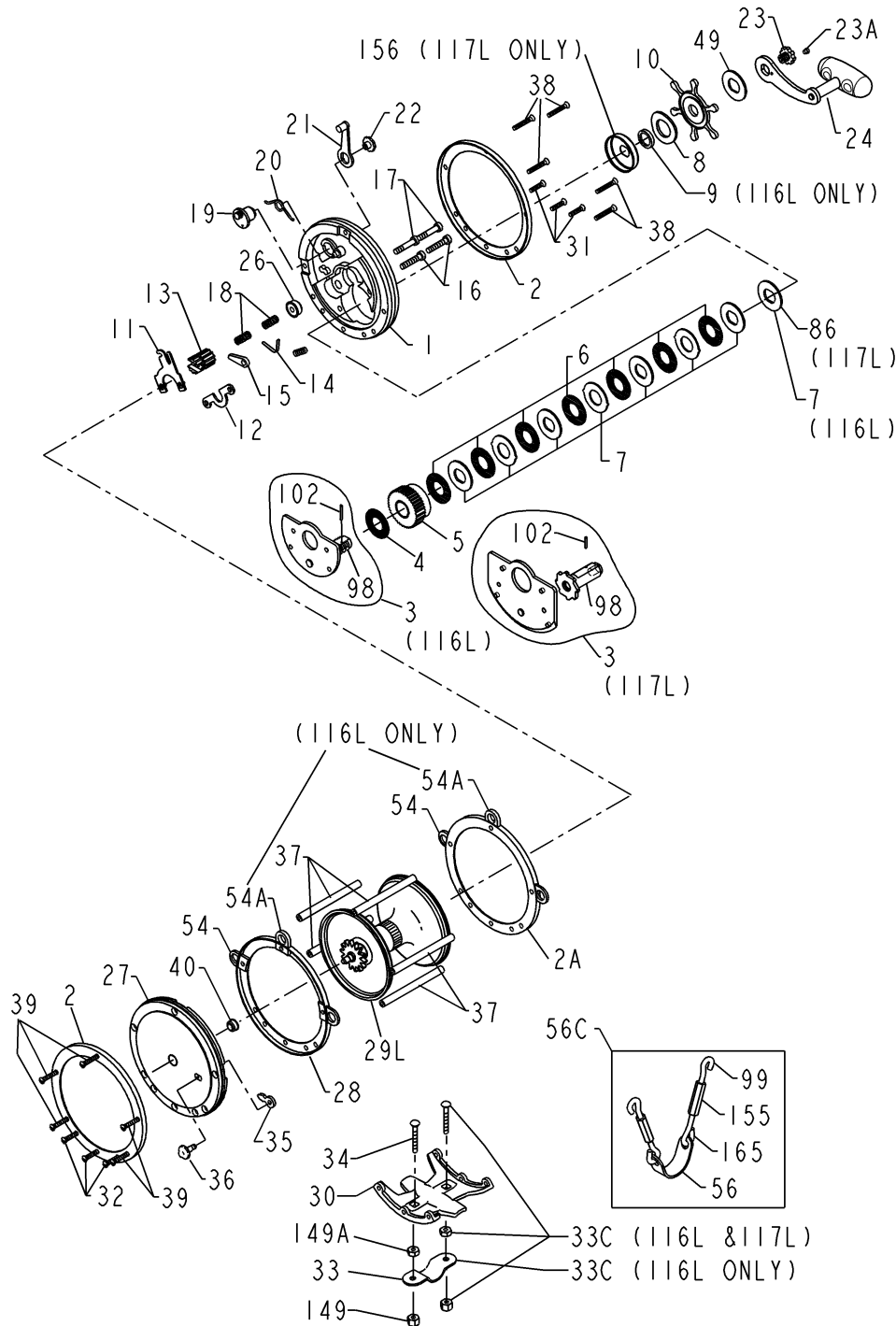

PARTS LIST FOR MODELS 116L AND 117L
REEL ASSEMBLY NOS. 1151086 (116L) AND 1270787 (117L)
MODEL SHOWN IS 116L EXCEPT WHERE NOTED



KEY NO.	116L PENN NO.	116L PART NO.	117L PENN NO.	117L PART NO.	DESCRIPTION
1	001 116	1180459	001 117	1180462	Right Side Plate
2	002 116o (2 req.)	1180624	002 117o (2 req.)	1180626	Outer Right Side Ring
2A	002 116i	1180623	002 117i	1180625	Inner Right Side Ring
3	003 116	1180710	003 117	1180712	Bridge w/Sleeve
4	004 116	1180767	004 116	1180767	Fiber Washer
5	005 116	1180850	005 117	1180852	Main Gear
6	006 116 (7 req.)	1180912	006 117 (7 req.)	1180913	Drag Washer
7	007C116	1181045	007C117	1181046	Drag Washer Set
8	008 116	1181069	008 117	1181070	Tension Spring
9	009 116	1181155	N/A	N/A	Spacing Sleeve
10	010 116	1181186	010 117	1181187	Star Drag Wheel
11	011 116	1181236	011 116	1181236	Eccentric Jack
12	012 116	1181263	012 116	1181263	Pinion Yoke
13	013 116	1181325	013 117	1181327	Pinion
14	014 116	1181397	014 117	1181398	Dog Spring
15	015 116	1181440	015 117	1181441	Dog
16	016 114 (2 req.)	1181572	016 114 (2 req.)	1181572	Lower Bridge Screw
17	017 114 (2 req.)	1181596	017 114 (2 req.)	1181596	Upper Bridge Screw
18	018 114 (2 req.)	1181618	018 114 (2 req.)	1181618	Clutch Spring
19	019 115	1181665	019 115	1181665	Eccentric
20	020 114	1181766	020 114	1181766	Eccentric Spring
21	021 116	1181846	021 117	1181847	Eccentric Lever
22	023 060	1181935	023 060	1181935	Eccentric Screw
23	023 116	1181946	023 116	1181946	Handle Screw
23A	110 060	1184437	110 060	1184437	Handle Lock Screw
24	024 116	1182002	024 117	1182003	Handle
26	026 116	1182119	026 117	1182120	Right Side Bearing Assembly
27	027 116	1182199	027 117	1182200	Left Side Plate Sub Assembly (Includes Click Spring)
28	028 116i	1182374	002 117i	1180625	Inner Left Side Ring
29L	029L116	1182515	029L117	1182516	Spool Assembly
30	030 116	1182624	030 117	1182626	Stand
31	039 012 (3 req.)	1183184	039 012 (3 req.)	1183184	Right Side Stand Screw
32	032 021 (3 req.)	1182713	039 012 (3 req.)	1183184	Left Side Stand Screw
33	033 116	1182756	033 117	1182757	Rod Clamp
*	*033 130ST	*1182758	*033R117	*1182781	*Ringed Rod Clamp (Optional)
34	034 130 (2 req.)	1182805	034 130 (2 req.)	1182805	Clamp Screw
33C	033C116	1192681	033C117	1191609	Clamp Screws w/Nuts Kit
35	035 115	1182916	035 115	1182916	Click Tongue
36	036 115	1182992	036 117	1182993	Click Button
37	037 116 (5 req.)	1183070	037 116 (8 req.)	1183070	Frame Post
38	039 013 (5 req.)	1183185	039 013 (8 req.)	1183185	Right Side Post Screw
39	039 012 (5 req.)	1183184	039 013 (8 req.)	1183185	Left Side Post Screw
40	026 116	1182119	026 117	1182120	Left Side Bearing Assembly
49	049 116	1183732	049 116	1183732	Handle Spacer
54	054 114 (2 req.)	1183857	054 117 (6 req.)	1183859	Harness Lug
54A	054 116 (2 req.)	1183858	N/A	N/A	Harness Lug
56	056 116	1183901	056 117 (2 req.)	1183902	Rod Brace
56C	056C116	1183910	056C117 (2 req.)	1183911	Rod Brace Kit
*56P	*056P117	*1183913	*056P117 (2 req.)	*1183913	*Rod Brace Pad
86	N/A	N/A	086 116	1184256	Key Washer
98	098 116	1184336	098 117	1184338	Gear Sleeve
99	099 116 (2 req.)	1184402	099 116 (4 req.)	1184402	Hook Screw L.H. Thread
102	102 117	1192232	102 117	1192232	Gear Sleeve Pin
149	149 116L (2 req.)	1184705	149 116L (2 req.)	1184705	Hex Nut
149A	149 116H (2req.)	1184704	149 116H (2req.)	1184704	Clamp Nut
*149B	*149A130 (2req.)	*1184707	*149A130 (2req.)	*1184707	*Washer (33C Clamp Kit)
*154	*154 117 (2req.)	*1184721	*154 117 (2req.)	*1184721	*Shim (Spool)
155	155 116 (2 req.)	1184725	155 116 (4 req.)	1184725	Turnbuckle
156	N/A	N/A	156 117	1184744	Drag Cover
165	165 116 (2 req.)	1184798	165 116 (4 req.)	1184798	Hook Screw R.H. Thread

* = Not Shown
 N/A=Not Applicable