

09 WIDEBITE WHITE

WITH QUIK STOW
COMPLETE ASSY: SK300-02

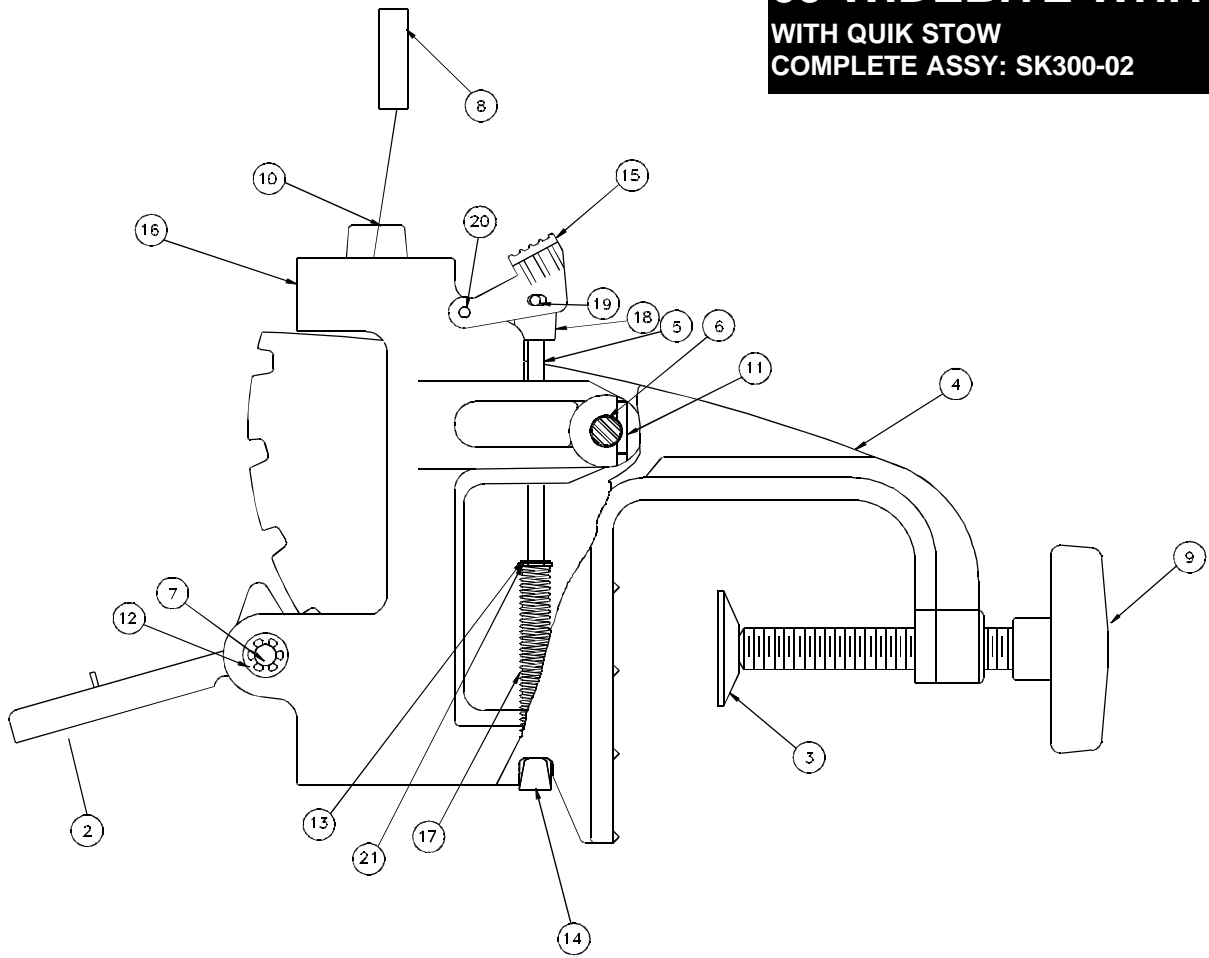

* SHOWN FOR REFERENCE ONLY
USED ON SK300-02

FEATURES

- Fits transoms up to 3" wide
- Heavy-duty extruded aluminum construction
- Convenient Quik Stow lever
- Fast tilt mechanism

ENVIRONMENT

- Saltwater

STANDARD ON

- Great White Transom models

1	21	WASHER	HK171-02
1	20	ROLL PIN	CB110-02
1	19	09 MT. TILT BUTTON PIN	CB110-02
1	18	09 MT. TILT BUTTON	SK023-01
1	17	SPRING	CK014-01
1	16	09 COLUMN SUPPORT H.O.	SK021-02
1	15	09 MT. TILT ACTUATOR	SK001-01
1	14	09 MT.LATCH BAR	SK024-01
1	13	E RING	AK046-01
2	12	1/4 RETAINING RING	AK046-03
1	11	ROLL PIN	SK101-01
1	10	BAR KNOB, TENSION	HK082-07
2	9	BAR KNOB, CLAMP	HK082-06
1	8	FRICION STRIP	SK100-01
1	7	PIN QUICK STOW 09MT.	SK102-01
1	6	PIVOT PIN	SK105-01
1	5	09 MT.LATCH PIN	SK106-01
1	4	09 MT BRACKET	SK167-02
2	3	CLAMP WASHER	CK171-01
1	2	LOCKING ASSEMBLY	CB372-01
X	1	09 MOUNT SW Q.S. H.O.	SK300-02

NO. REQ'D	ITEM NO.	PART	PART NO.
MATERIAL:		SEE ABOVE	STANDARD TOLERANCES UNLESS SPECIFIED
FINISH:			DECIMAL .XX +/- .010 DECIMAL .XXX +/- .005 ANGULAR +/- 1°
PART NAME		09 MOUNT-SW	DRN BY RA5/14/96
			CHK BY
			APP BY
			SCALE NONE
ZEBCO/MOTORGUIDE		DRG. NO.	SK192-02
MotorGuide		P.O. BOX 4345 STARKVILLE, MISSISSIPPI 39759 ZEBCO CORPORATION, A BRUNSWICK CO.	