

03 TRANSOM WHITE

SALTWATER WITH QUIK STOW
COMPLETE ASSY: HK300-02

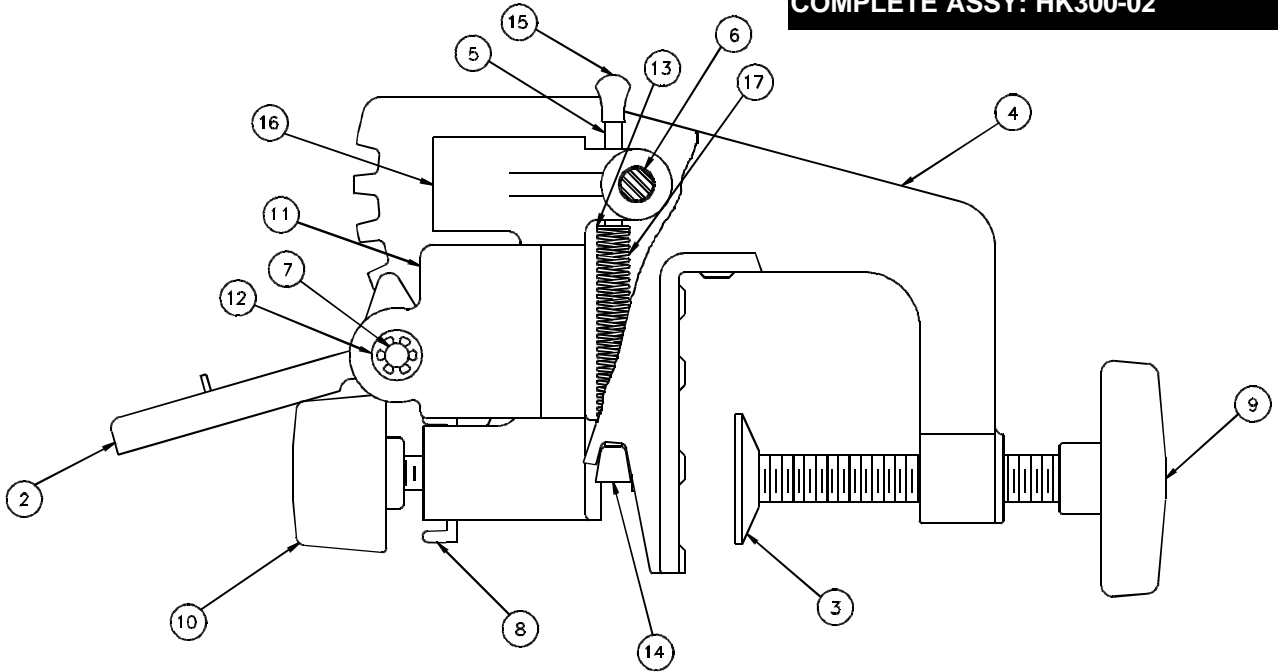

FEATURES

- Fits transoms up to 2 1/4" wide
- Adjustable height and tilt mechanism
- All metal construction
- Quik Stow Lever
- Adjustable steering tension knob
- Designed for Saltwater environment

1	17	03 SPRING	CK014-01
1	16	03 COLUMN SUPPORT	CK021-02
1	15	END BUMPER	CK023-02
1	14	LATCH BAR	CK024-02
1	13	RETAINER	AK046-03
2	12	1/4 RETAINING RING	AK046-03
1	11	COLLAR/QUICK STOW	CB051-01
1	10	BAR KNOB, 03 TENSION	HK082-05
2	9	BAR KNOB, 03 HI CLAMP	HK082-06
1	8	FRICTION STRIP	CK100-04
1	7	PIN/QUICK STOW	CB102-06
1	6	PIVOT PIN/TRANSOM MOUNT	CK105-01
1	5	LATCH PIN/TRANSOM MOUNT	HK106-01
1	4	03 MT BRACKET	CK167-02
2	3	CLAMP WASHER	HK171-01
1	2	LOCKING ASSEMBLY	CB372-01
1	1	03 MOUNT H.O. S.W. Q.S. WH.	HK192-05

NO.	ITEM	PART	PART NO.
		SEE ABOVE	
FINISH:			STANDARD TOLERANCES UNLESS SPECIFIED DECIMAL .XX 1/- .010 DECIMAL .XXX +/- .005 ANGULAR +/- 1°
PART NAME			DRN BY: RA/29/96
SCHEMATIC-03 MT H.O. SW. Q.S. WH			CHK BY:
			APP BY:
			SCALE NONE
MotorGuide			DRG. NO. HK192-05
ZEBCO/MOTORGUIDE P.O. BOX 4345 STARBUCKLE, MISSISSIPPI 39759 ZEBCO CORPORATION, A BRUNSWICK CO.			