

03 TRANSOM CAMO

WITHOUT QUIK STOW
COMPLETE ASSY: CK300-0

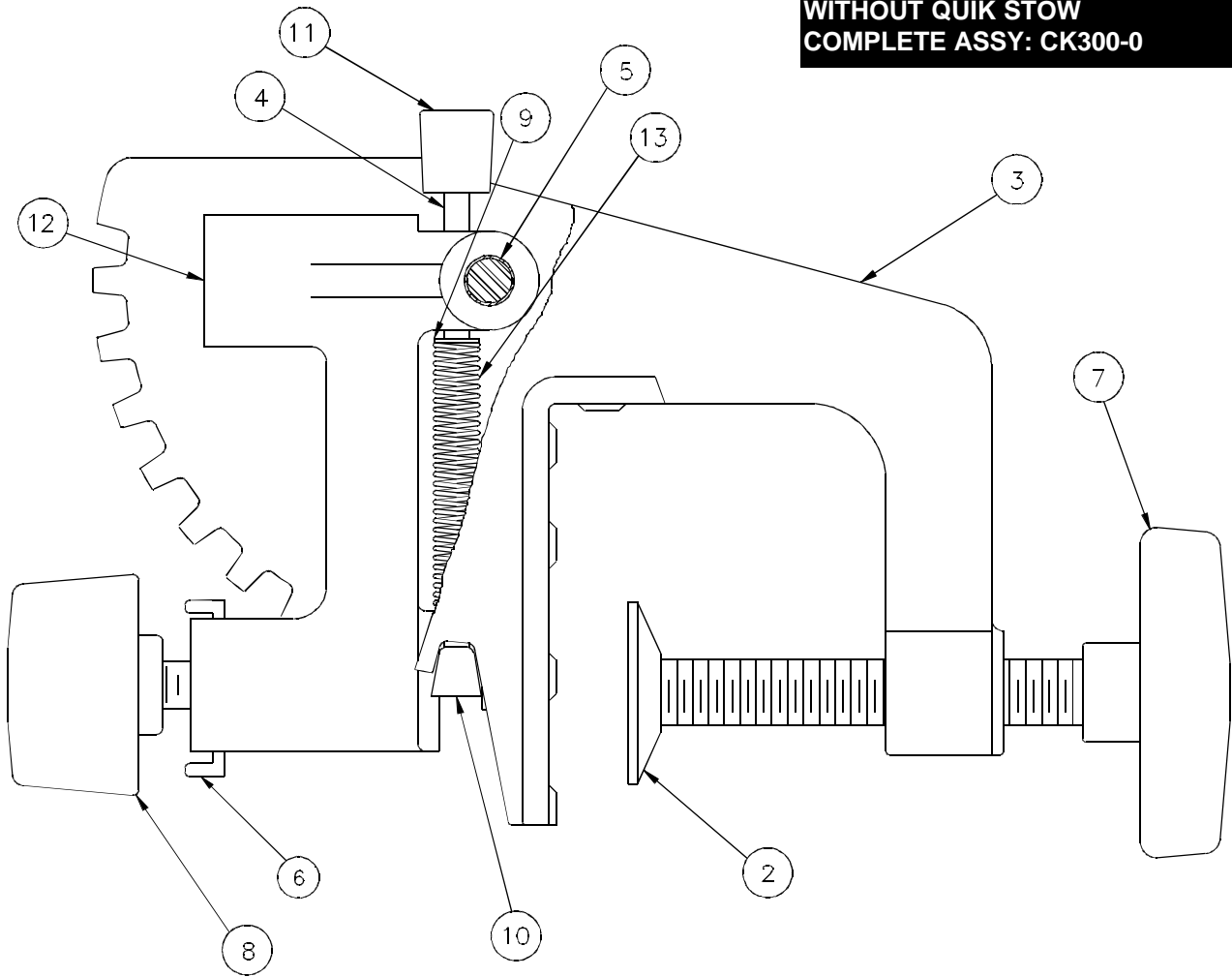

* SHOWN FOR REFERENCE ONLY
USED IN CK300-04

FEATURES

- Fits transoms up to 2 1/4" wide
- Adjustable height and tilt mechanism
- All metal construction
- Adjustable steering tension knob

QTY	ITEM NO.	DESCRIPTION	PART NO.
1	13	03 SPRING	CK014-01
1	12	03 COLUMN SUPPORT	CK021-01
1	11	END BUMPER	CK023-02
1	10	LATCH BAR	CK024-01
1	9	E RING	AK046-01
1	8	BAR KNOB, 03 TENSION	CK082-03
2	7	BAR KNOB, 03 HI CLAMP	CK082-04
* 1	6	FRICITION STRIP	CK100-04
1	5	PIVOT PIN/TRANSOM MOUNT	CK105-01
1	4	LATCH PIN/TRANSOM MOUNT	CK106-01
1	3	03 MT BRACKET	CK167-01
2	2	CLAMP WASHER	CK171-01
1	1	03 MOUNT H.O.	CK192-03

NO. REQ'D	ITEM NO.	PART	PART NO.
MATERIAL:		SEE ABOVE	
FINISH:			
PART NAME		SCHEMATIC-03 MT H.O.	
ZEBCO/MOTORGUIDE		P.O. BOX 4345 STARKVILLE, MISSISSIPPI 39759 ZEBCO CORPORATION, & BRUNSWICK CO.	
MotorGuide		DWC. NO. CK192-03	
STANDARD TOLERANCES UNLESS SPECIFIED		DECIMAL .XX +/- .010 DECIMAL .XXX +/- .005 ANGULAR +/- 1°	
DRN BY		RA4/21/95	
CHK BY			
APP BY			
SCALE		NONE	