

03 TRANSOM BLACK

WITH QUIK STOW
COMPLETE ASSY: CK300-05

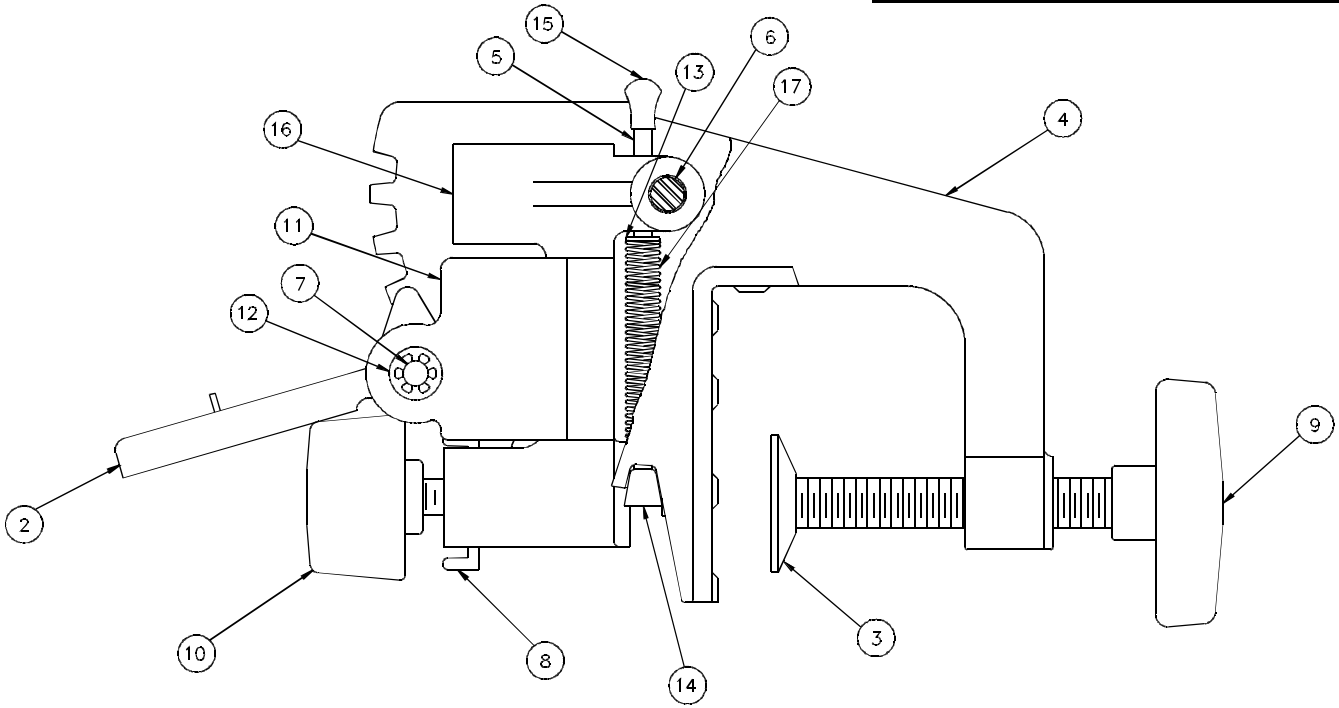

FEATURES

- Fits transoms up to 2 1/4" wide
- Adjustable height and tilt mechanism
- All metal construction
- Quik Stow Lever
- Adjustable steering tension knob
- Freshwater use only

* SHOWN FOR REFERENCE ONLY
USED IN CK300-05ASAW

1	17	03 SPRING	CK014-01	
1	16	03 COLUMN SUPPORT	CK021-01	
1	15	END BUMPER	CK023-02	
1	14	LATCH BAR	CK024-01	
1	13	E RING	AK046-01	
1	12	1/4 RETAINING RING	AK046-03	
1	11	COLLAR/QUICK STOW	CB051-01	
1	10	BAR KNOB, 03 TENSION	CK082-03	
2	9	BAR KNOB, 03 HI CLAMP	CK082-04	
*	1	8	FRICITION STRIP	CK100-04
1	7	PIN/QUICK STOW	CB102-06	
1	6	PIVOT PIN/TRANSOM MOUNT	CK105-01	
1	5	LATCH PIN/TRANSOM MOUNT	CK106-01	
1	4	03 MT BRACKET	CK167-01	
2	3	CLAMP WASHER	CK171-01	
1	2	LOCKING ASSEMBLY	CB372-01	
1	1	03 MOUNT W/ QUICK STOW	CK192-01	

REV.	DESCRIPTION	PART	PART NO.
1	SEE ABOVE		
FINISH:			STANDARD TOLERANCES UNLESS SPECIFIED
			DECIMAL .XX +/- .010
			DECIMAL .XXX +/- .005
			ANGULAR +/- 1°
PART NAME			DRN BY <i>RA7/19/93</i>
SCHEMATIC-03 MT W/ QUICK STOW			CHK BY
			APP BY
			SCALE NONE
MotorGuide			DWG. NO. CK192-01
ZEBCO/MOTORGUIDE P.O. BOX 4345 STARVILLE, MISSISSIPPI 39759 ZEBCO CORPORATION, A BRUNSWICK CO.			